

D:\MVA\2020\14571\14571.DWG CLO ET P=8/24/2020 2:57 PM S=7/4/2020 2:56 PM WAL

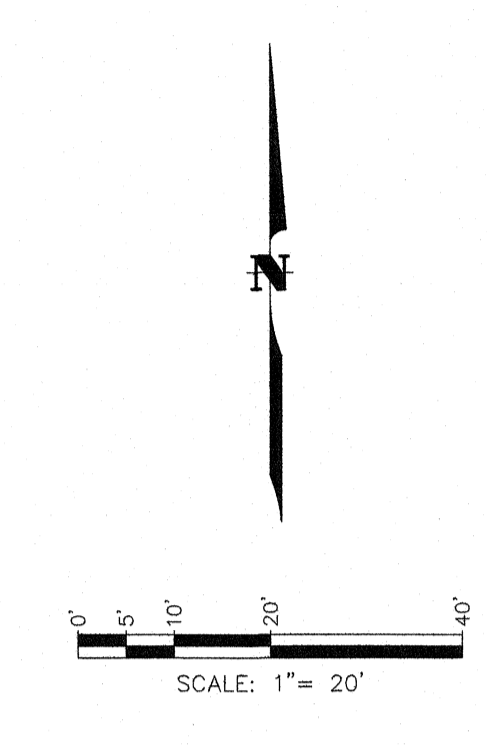
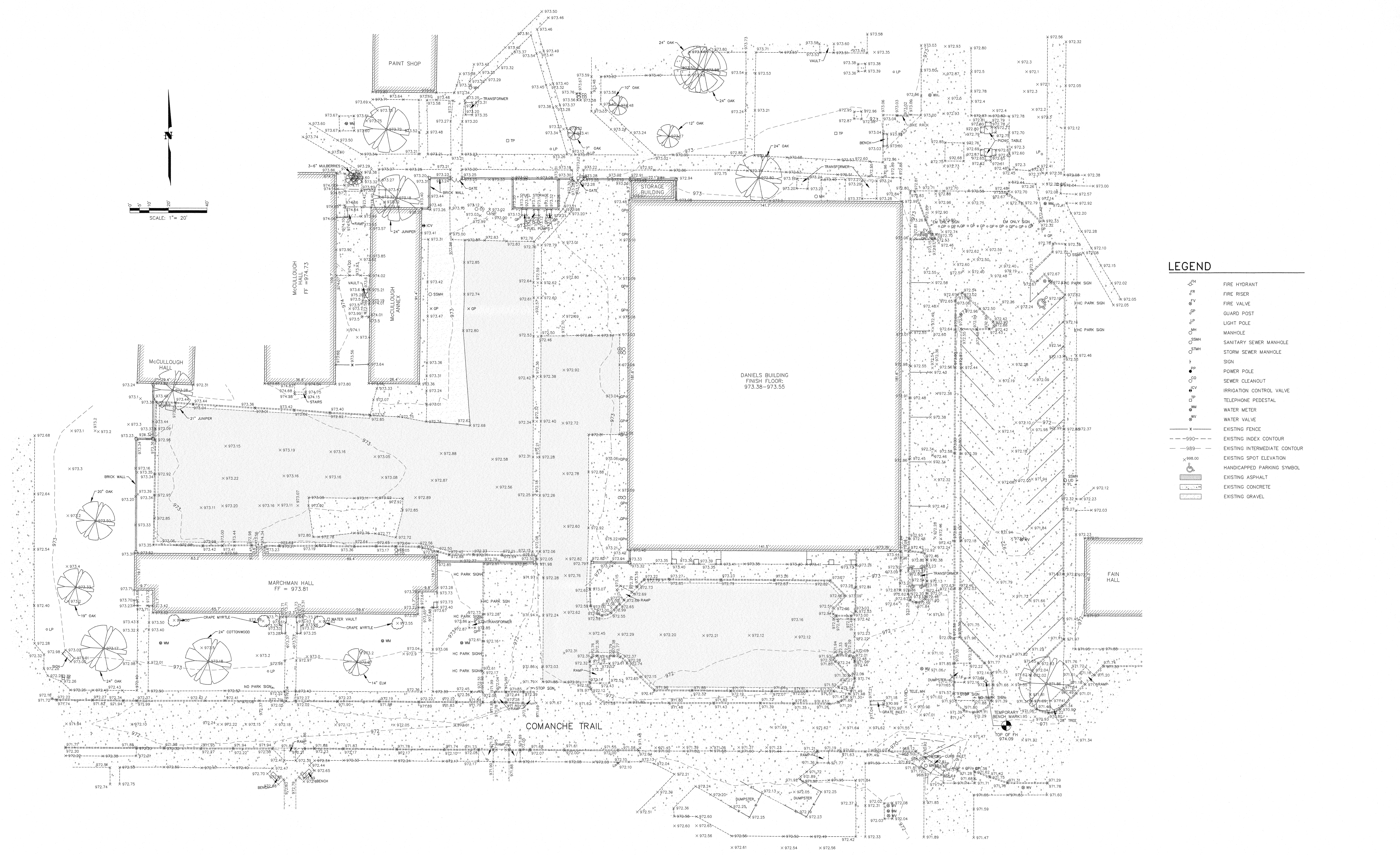

LEGEND

| | |
|-------|-------------------------------|
| ⊙ | FIRE HYDRANT |
| ⊕ | FIRE RISER |
| ⊖ | FIRE VALVE |
| ⊙ | GUARD POST |
| ⊕ | LIGHT POLE |
| ⊙ | MANHOLE |
| ⊙ | SANITARY SEWER MANHOLE |
| ⊙ | STORM SEWER MANHOLE |
| ⊕ | SIGN |
| ⊕ | POWER POLE |
| ⊕ | SEWER CLEANOUT |
| ⊕ | IRRIGATION CONTROL VALVE |
| ⊕ | TELEPHONE PEDESTAL |
| ⊕ | WATER METER |
| ⊕ | WATER VALVE |
| - - - | EXISTING FENCE |
| - - - | EXISTING INDEX CONTOUR |
| - - - | EXISTING INTERMEDIATE CONTOUR |
| - - - | EXISTING SPOT ELEVATION |
| ⊕ | HANDICAPPED PARKING SYMBOL |
| ⊕ | EXISTING ASPHALT |
| ⊕ | EXISTING CONCRETE |
| ⊕ | EXISTING GRAVEL |

| REV | DATE | DESCRIPTION |
|-----|------|-------------|
| | | |

DANIEL BUILDING RENOVATION
J.S. BRIDWELL ACTIVITIES CENTER &
CANNED GREEK COMMONS



BYS Architects
 1008 North Street - Suite 200 Wichita Falls, Texas 76301 (840) 761-2404
 Member American Institute of Architects

| | |
|-------------|--------------|
| DRAWN BY | WAT |
| CHECKED BY | DGS |
| DATE | AUGUST, 2020 |
| PROJECT NO. | 34577 |

CORLETT, PROBST & BOYD, P.L.L.C.
 4605 Old Jockboro Highway Telephone (840) 723-1455
 Wichita Falls, Texas 76302 Fax (840) 397-0549

Copyright 2018 BYSP Architects

C101

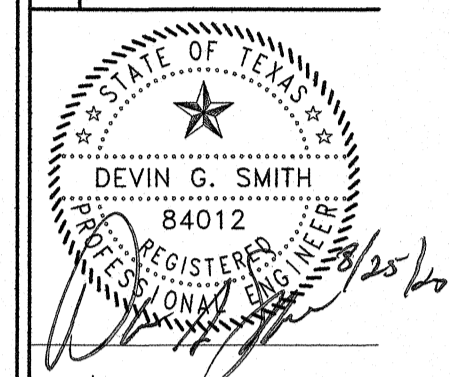

DANIEL BUILDING RENOVATION
J.S. BRIDWELL ACTIVITES CENTER &
CANNEDY GREEK COMMONS

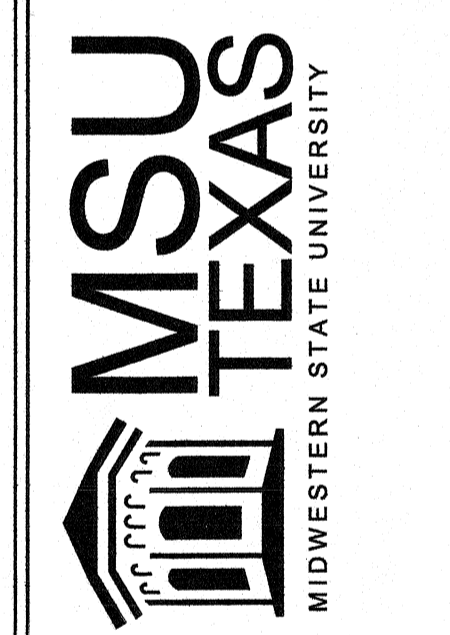

BYS P architects
 1005 Ninth Street - Suite 200 Wichita Falls, Texas 76701 (840) 763-5404
 Member American Institute of Architects

DRAWN BY: WAT
 CHECKED BY: DGS
 DATE: AUGUST, 2020
 PROJECT NO.: 34577
 DEMOLITION PLAN

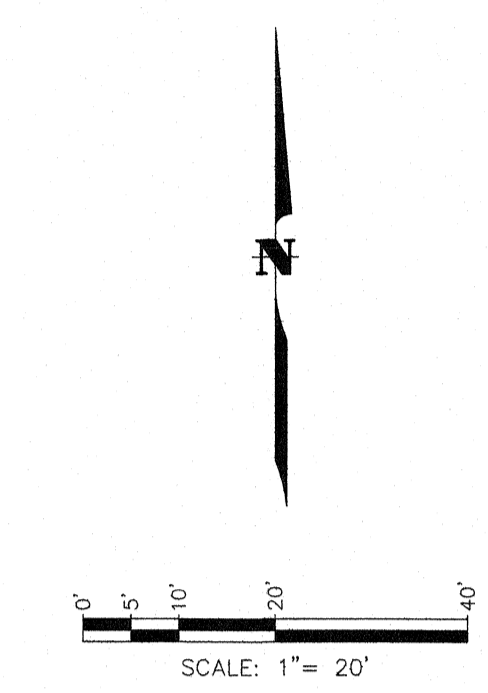
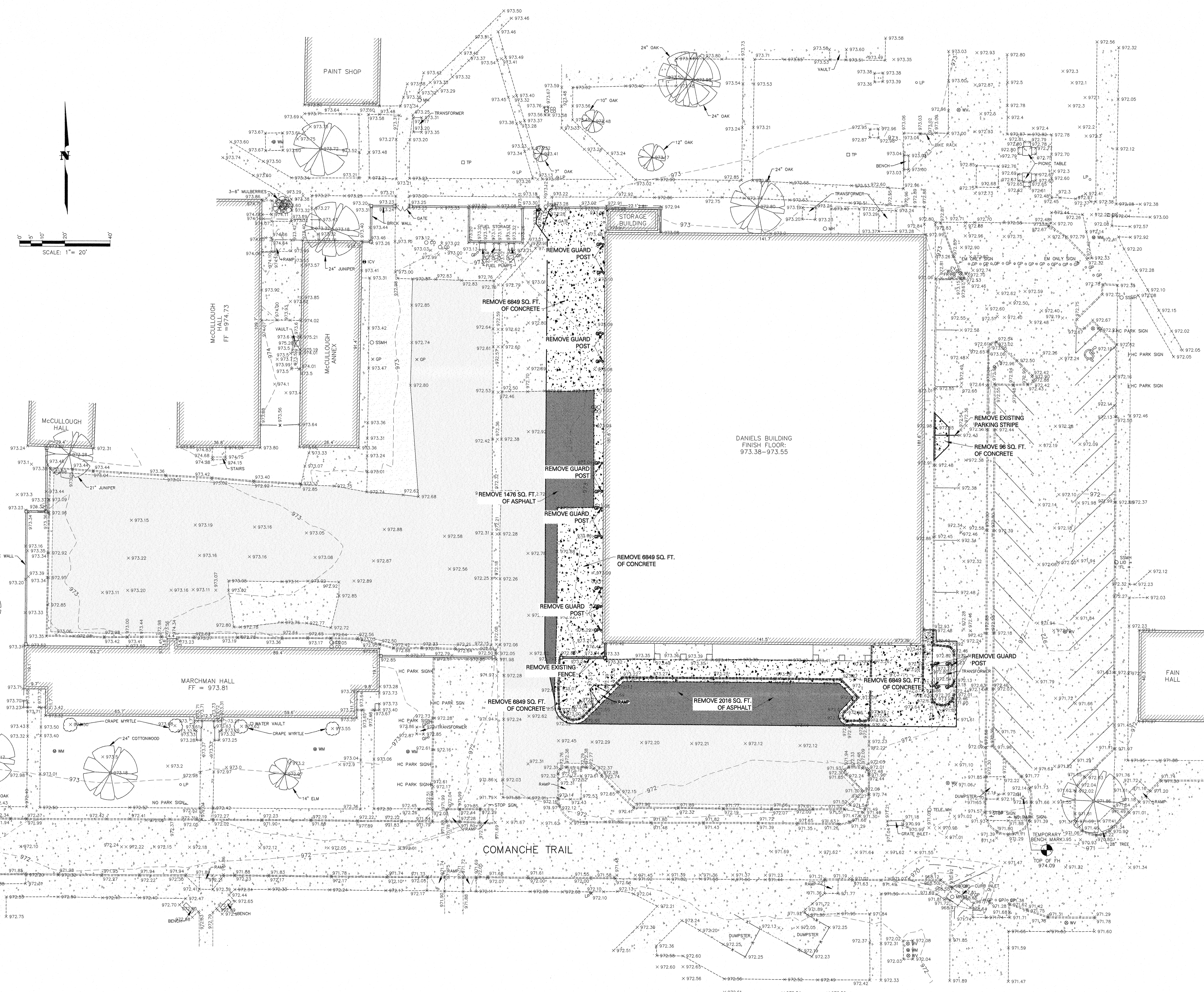

LEGEND

- FIRE HYDRANT
- FIRE RISER
- FIRE VALVE
- GUARD POST
- LIGHT POLE
- MANHOLE
- SANITARY SEWER MANHOLE
- STORM SEWER MANHOLE
- SIGN
- POWER POLE
- SEWER CLEANOUT
- IRRIGATION CONTROL VALVE
- TELEPHONE PEDESTAL
- WATER METER
- WATER VALVE
- EXISTING FENCE
- EXISTING INDEX CONTOUR
- EXISTING INTERMEDIATE CONTOUR
- EXISTING SPOT ELEVATION
- HANDICAPPED PARKING SYMBOL
- EXISTING ASPHALT
- EXISTING CONCRETE
- EXISTING GRAVEL

CAUTION!!! ----- UNDERGROUND UTILITIES!!!

EXISTING UTILITIES AND UNDERGROUND FACILITIES INDICATED ON THESE PLANS HAVE BEEN LOCATED APPROXIMATELY BY SIGHT OR FROM INFORMATION SUPPLIED BY THE VARIOUS OWNERS OF THE FACILITIES. THE ENGINEER AND OWNER DO NOT ACCEPT ANY RESPONSIBILITY FOR THE LOCATIONS SHOWN. IT SHALL BE THE SOLE RESPONSIBILITY OF THE CONTRACTOR TO VERIFY BOTH HORIZONTALLY AND VERTICALLY THE LOCATION OF ALL UTILITIES PRIOR TO CONSTRUCTION. TO TAKE NECESSARY PRECAUTIONS TO PROTECT ALL UTILITIES ENCOUNTERED; AND TO NOTIFY ENGINEER PROMPTLY OF ALL CONFLICTS WITH THE PROPOSED WORK. THE CONTRACTOR SHALL PRESERVE AND PROTECT ALL EXISTING UTILITIES AND FACILITIES FROM DAMAGE DURING CONSTRUCTION. THE CONTRACTOR SHALL BE RESPONSIBLE FOR COST OF REPAIR OR REPLACEMENT OF ANY FACILITIES AS REQUIRED BY THE FACILITY OWNERS. CONTACT ALL POSSIBLE UTILITY AND FACILITY OWNERS AND TAKE PROPER SAFETY AND PROTECTION MEASURES AS REQUIRED BY THE FACILITY OWNERS.

CITY OF WICHITA FALLS UTILITY OPERATIONS - (940) 761-4333
 AT&T - (940) 766-7217
 TEXAS DEPARTMENT OF TRANSPORTATION - (940) 720-7709
 ONCOR ELECTRIC DELIVERY - (940) 766-5460
 UNDERGROUND FACILITIES LOCATOR SERVICE - (800) 344-8377
 ATMOS ENERGY - (940) 696-7602

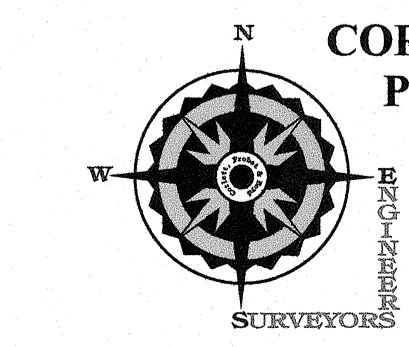

**CORLETT,
 PROBST &
 BOYD, P.L.L.C.**
 4605 Old Jackaraba Highway Telephone (940) 723-1456
 Wichita Falls, Texas 76702 Fax (940) 397-0549



DANIEL BUILDING RENOVATION
J.S. BRIDWELL ACTIVITES CENTER &
CANNED GREEK COMMONS



BYP architects
1005 Ninth Street - Suite 200 Wichita Falls, Texas 76701 (940) 761-5404
Member American Institute of Architects

DRAWN BY: WAT
CHECKED BY: DGS
DATE: AUGUST, 2020
PROJECT NO. 34577

SITE LAYOUT AND
GRADING PLAN

C103

SITE GRADING NOTES:

1. THIS PLAN IS INTENDED FOR THE SITE GRADING AND STORMWATER DETENTION PURPOSES ONLY. ALL PROPOSED GRADES SHALL BE THE PROPOSED FINISH ELEVATION UNLESS NOTED OTHERWISE. REFER TO ARCHITECTURAL DRAWING FOR SITE PLAN.
2. ALL PAVING AND STRUCTURES SHALL BE PLACED ON UNDISTURBED SOIL OR SELECT FILL (NOT FILL SAND) COMPACTED TO 95% STANDARD PROCTOR DENSITY.
3. ALL CONCRETE (UNLESS OTHERWISE NOTED) SHALL BE CLASS "A", DEVELOPING A 28 DAY COMPRESSIVE STRENGTH OF 3000 PSI MINIMUM. USE A "BULL-NOSED" EDGER OR 3/4" INCH CHAMFER ON ALL EXPOSED EDGES. PROVIDE A LIGHT BROOM FINISH. UNLESS OTHERWISE NOTED ALL CONCRETE SHALL BE REINFORCED WITH #3 BARS @ 18 INCHES ON CENTER EACH WAY.
4. ALL REBAR SHALL BE GRADE 60 AND SHALL BE INSTALLED IN ACCORDANCE WITH ACI 318, LATEST EDITION. 18" OF TRANSVERSE BARS SHALL BE TURNED UP INTO CURBS OR DOWN INTO FOOTINGS OR WALLS.
5. ALL SIDEWALKS AND HANDICAP ACCESSIBLE ROUTES SHALL HAVE A CROSS SLOPE OF 2% OR LESS, AND A LONGITUDINAL SLOPE OF 1% OR LESS.
6. ALL TRENCHING AND EXCAVATIONS SHALL COMPLY WITH THE LATEST REQUIREMENTS OF THE OCCUPATIONAL SAFETY AND HEALTH ADMINISTRATION (OSHA).
7. IMMEDIATELY AFTER THE DETENTION IMPROVEMENTS HAVE BEEN BROUGHT TO FINAL LINE AND GRADE, THE ENGINEER SHOULD BE CONTACTED TO VERIFY THAT THE DETENTION IMPROVEMENTS HAVE BEEN CONSTRUCTED IN ACCORDANCE WITH THIS PLAN. THIS PLAN MUST BE ADHERED TO IN ORDER TO OBTAIN THE ENGINEER'S CONCURRENCE BEFORE ANY REQUEST WILL BE MADE TO OBTAIN A REFUND OF THE FINANCIAL DEPOSIT FROM THE CITY, AND PRIOR TO ISSUANCE OF A CERTIFICATE OF OCCUPANCY FROM THE CITY.
8. IMMEDIATELY AFTER THE DETENTION IMPROVEMENTS HAVE BEEN BROUGHT TO FINAL LINE AND GRADE, ALL AREAS BARE OF VEGETATION SHALL BE PREPARED, FERTILIZED, AND SEEDED OR HYDRO-MULCHED IN ACCORDANCE WITH THE REQUIREMENTS OF THE "STANDARD SPECIFICATIONS" MENTIONED IN THE LEAD PARAGRAPH. ALL THESE AREAS SHALL BE MAINTAINED BY WATERING, RE-SEEDING AND FERTILIZING AS NECESSARY UNTIL A STAND OF GRASS IS ESTABLISHED WITH NO BARE SPOTS GREATER THAN ONE SQUARE FOOT IN SIZE.
9. THE CONTRACTOR SHALL HAVE THE SOLE RESPONSIBILITY FOR SAFETY ON THIS PROJECT. THE CITY OF WICHITA FALLS WILL REQUIRE A FLOODPLAIN DEVELOPMENT PERMIT PURSUANT TO FEMA REQUIREMENTS. THE CITY WILL ISSUE A FOUNDATION ONLY PERMIT. AFTER CONCRETE SLAB IS IN PLACE, A FEMA ELEVATION CERTIFICATE MUST BE PROVIDED BY A LICENSE SURVIVOR THAT CERTIFIES THE SLAB ELEVATION IS AT LEAST .988 BEFORE THE CITY WILL ISSUE A FULL BUILDING PERMIT.
- 10.

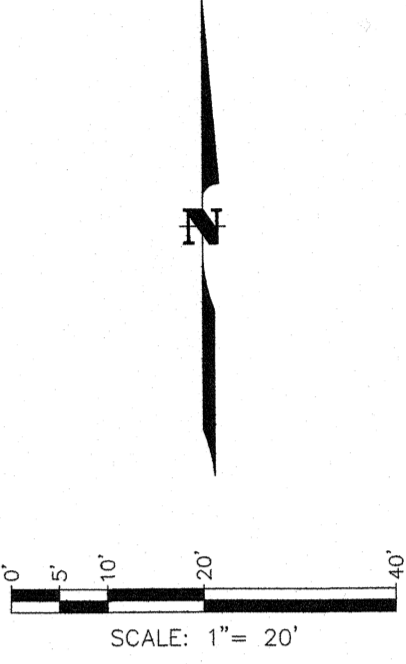
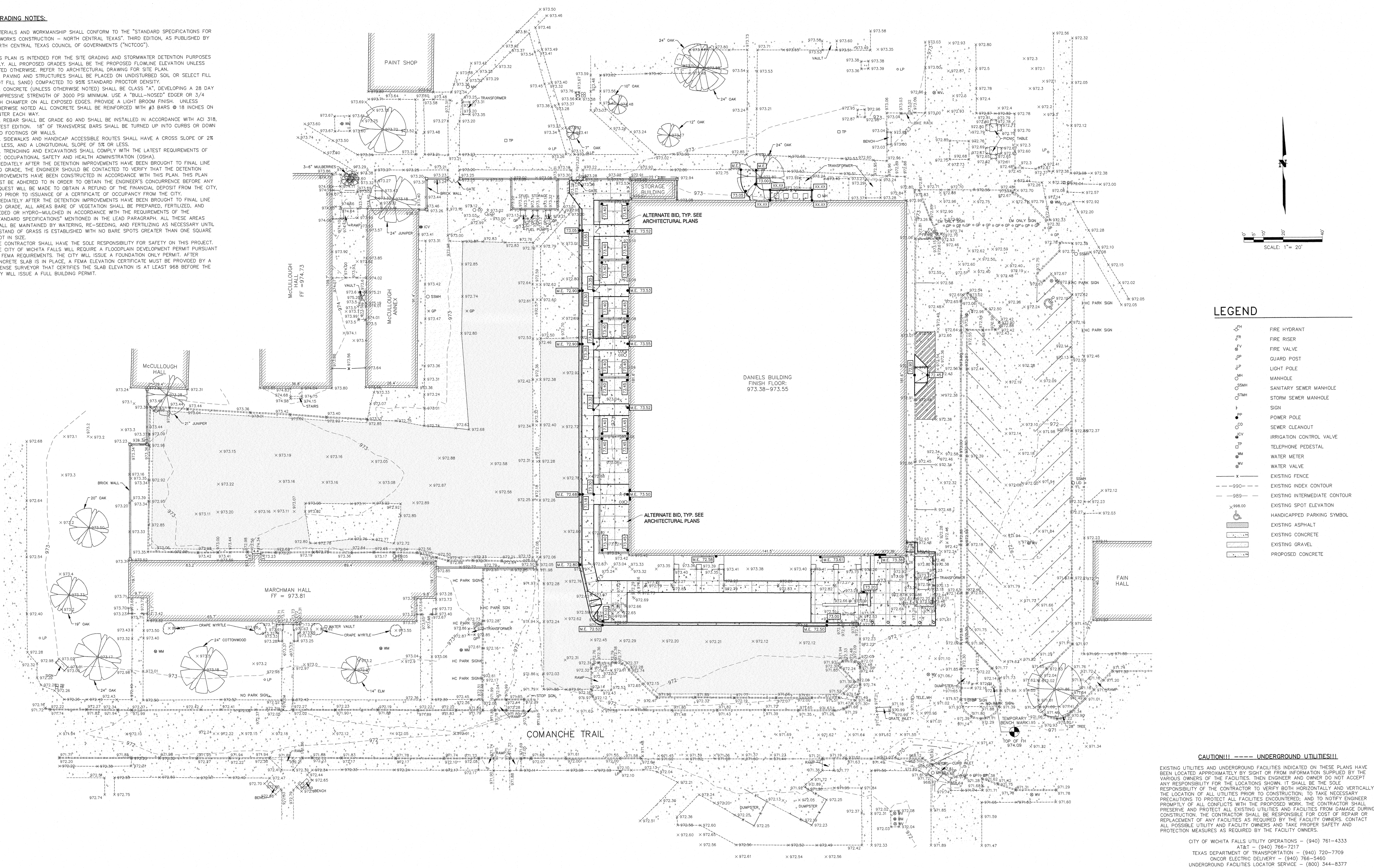

LEGEND

- ⊕ FIRE HYDRANT
- FR FIRE RISER
- FV FIRE VALVE
- GP GUARD POST
- LP LIGHT POLE
- MANHOLE
- SMH SANITARY SEWER MANHOLE
- SSMH STORM SEWER MANHOLE
- SN SIGN
- PP POWER POLE
- SC SEWER CLEANOUT
- ICV IRRIGATION CONTROL VALVE
- WM WATER METER
- TV TELEPHONE PEDESTAL
- WV WATER VALVE
- - - - - EXISTING FENCE
- - - - - EXISTING INDEX CONTOUR
- - - - - EXISTING INTERMEDIATE CONTOUR
- 998.00 EXISTING SPOT ELEVATION
- ⊕ EXISTING HANDICAPPED PARKING SYMBOL
- EXISTING ASPHALT
- EXISTING CONCRETE
- EXISTING GRAVEL
- PROPOSED CONCRETE

CAUTION!!! ----- UNDERGROUND UTILITIES!!!

EXISTING UTILITIES AND UNDERGROUND FACILITIES INDICATED ON THESE PLANS HAVE BEEN LOCATED APPROXIMATELY BY SIGHT OR FROM INFORMATION SUPPLIED BY THE VARIOUS OWNERS OF THE FACILITIES. THEN ENGINEER AND OWNER DO NOT ACCEPT ANY RESPONSIBILITY FOR THE LOCATIONS SHOWN. IT SHALL BE THE SOLE RESPONSIBILITY OF THE CONTRACTOR TO VERIFY BOTH HORIZONTALLY AND VERTICALLY THE LOCATION OF ALL UTILITIES PRIOR TO CONSTRUCTION. TO TAKE NECESSARY PRECAUTIONS TO PROTECT ALL FACILITIES ENCOUNTERED, AND TO NOTIFY ENGINEER PROMPTLY OF ALL CONFLICTS WITH THE PROPOSED WORK. THE CONTRACTOR SHALL PRESERVE AND PROTECT ALL EXISTING UTILITIES AND FACILITIES FROM DAMAGE DURING CONSTRUCTION. THE CONTRACTOR SHALL BE RESPONSIBLE FOR COST OF REPAIR OR REPLACEMENT OF ANY FACILITIES AS REQUIRED BY THE FACILITY OWNERS. CONTACT ALL POSSIBLE UTILITY AND FACILITY OWNERS AND TAKE PROPER SAFETY AND PROTECTION MEASURES AS REQUIRED BY THE FACILITY OWNERS.

CITY OF WICHITA FALLS UTILITY OPERATIONS - (940) 761-4333
 AT&T - (940) 766-7217
 TEXAS DEPARTMENT OF TRANSPORTATION - (940) 720-7709
 ONCOR ELECTRIC DELIVERY - (940) 766-5460
 UNDERGROUND FACILITIES LOCATOR SERVICE - (800) 344-8377
 ATMOS ENERGY - (940) 696-7602

**CORLETT,
PROBST &
BOYD, P.L.L.C.**
 4605 Old Jacksonville Highway
 Wichita Falls, Texas 76702 Telephone (940) 723-1455
 Fax (940) 397-0549



Copyright 2018 BYP Architects

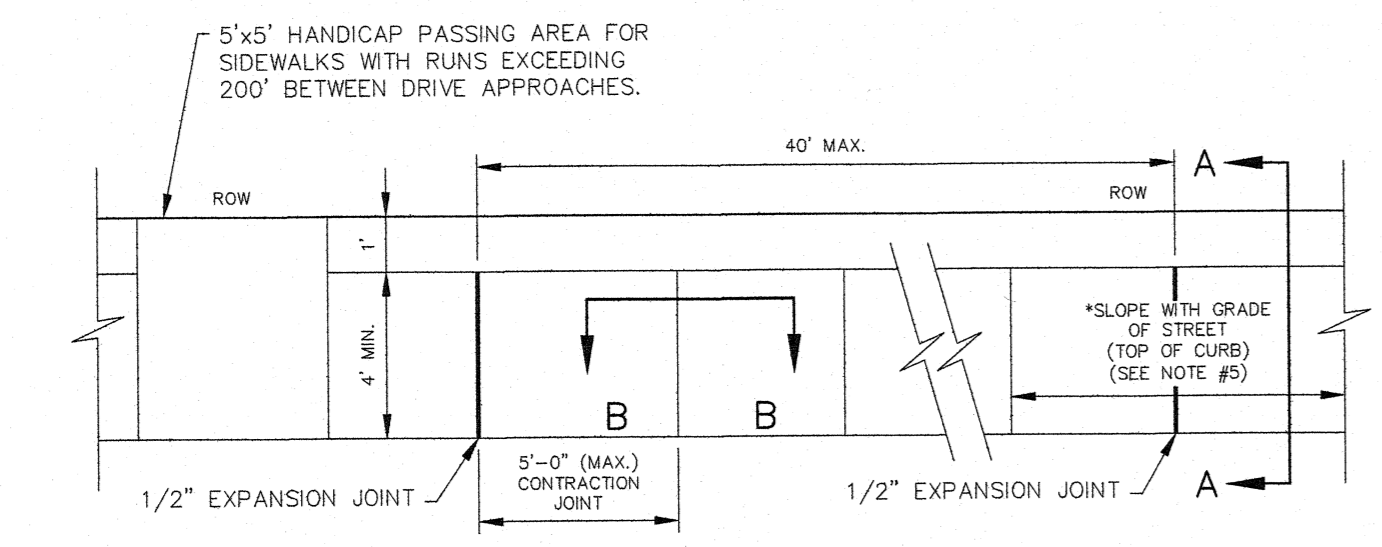

PLAN

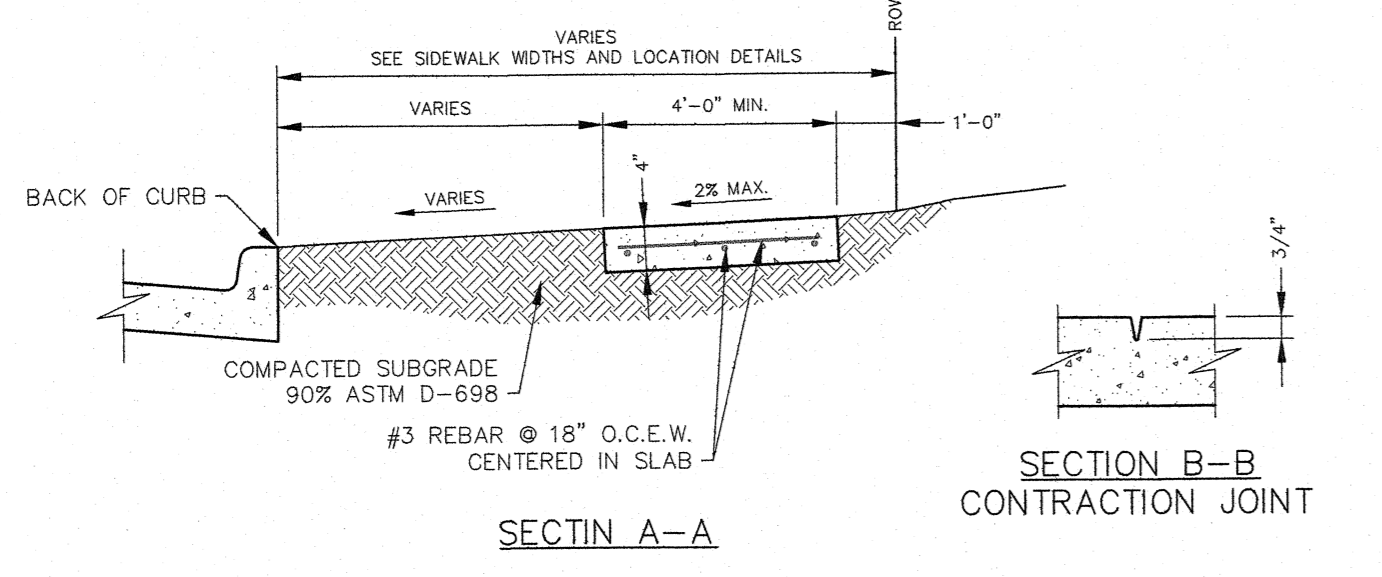

SECTION A-A

SECTION B-B
CONTRACTION JOINT

- GENERAL NOTES:**
1. SIDEWALK REINFORCING (EXCLUDING DRIVE APPROACHES) SHALL BE #3 BARS @ 18" O.C.E.W. OR #4 BARS @ 24" O.C.
 2. ALL CONCRETE SHALL BE CLASS "A", (COMPRESSIVE STRENGTH OF 3,000 PSI @ 28 DAYS)
 3. SAND SHALL NOT BE ACCEPTED AS COMPACTED SUBGRADE. SAND WILL BE ALLOWED FOR LEVEL-UP ONLY.
 4. ANY UTILITY BOXES OR MANHOLES WITHIN THE SIDEWALK MUST BE ADJUSTED BY THE CITY UTILITY DEPARTMENT OR OWNER OF UTILITY, TO BE FLUSH WITH FINISH GRADE, OR RELOCATED OUT OF THE SIDEWALK TO THE PROPER GRADE. ALL ADJUSTMENT COST WILL BE THE RESPONSIBILITY OF THE CONTRACTOR, OR THE OWNER INSTALLING THE SIDEWALK.
 5. CROSS SLOPE AT DRIVE APPROACHES AND RAMPS MUST COMPLY WITH ADA REQUIREMENTS. (1 INCH PER FOOT MAXIMUM)
 6. SIDEWALK IS PLACED ADJACENT TO CURB. MINIMUM WIDTH SHALL BE 4'.
 7. PLACE SIDEWALK 1' OFF ROW LINE. PROVIDE 3' MINIMUM WIDTH SIDEWALK IN COMMERCIAL AREAS WITH HEAVY PEDESTRIAN MOVEMENTS.
 8. SIDEWALKS INSTALLED WITHIN FOOT RIGHT OF WAY SHALL BE A MINIMUM WIDTH OF 5' AND MEET REQUIREMENTS OF TDDOT PEDESTRIAN STANDARDS.

SIDEWALK

SCALE: NONE

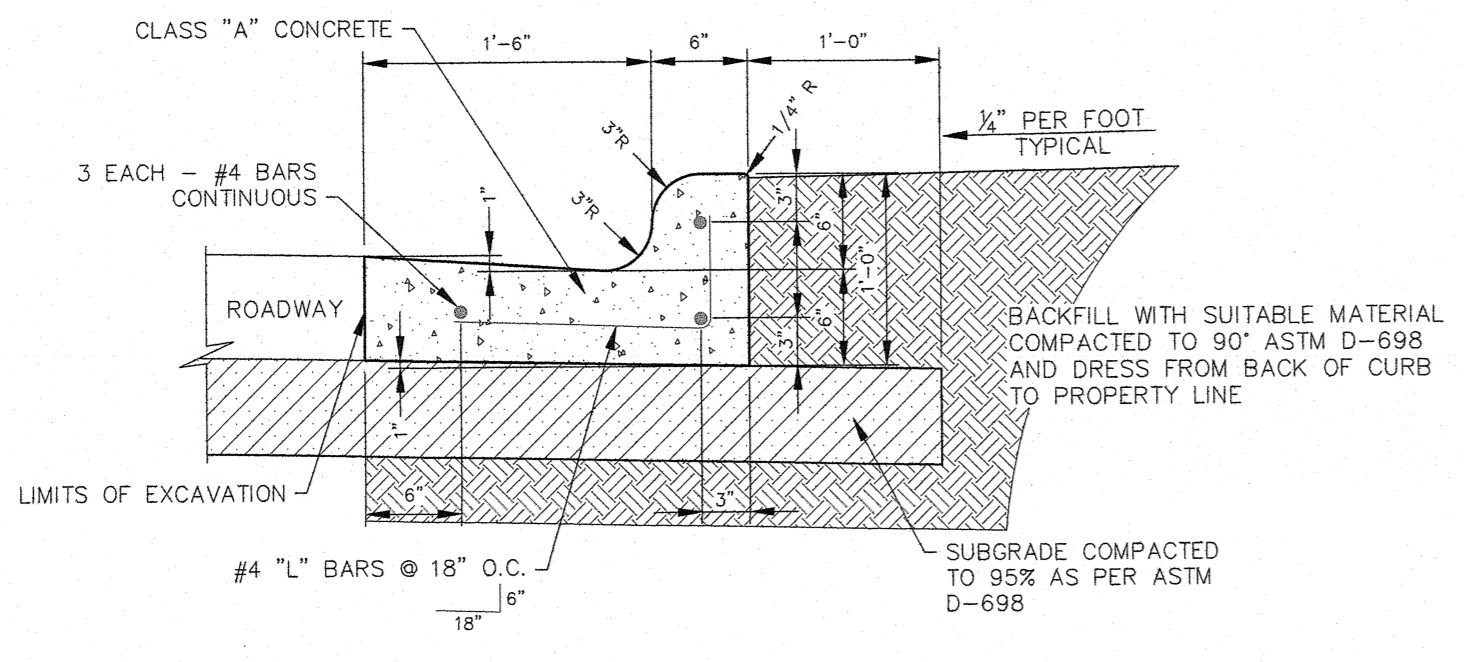

MONOLITHIC CURB AND GUTTER

SCALE: NONE

- GENERAL NOTES:**
1. DOWEL REINFORCEMENT 6" INTO EXISTING CURB AND GUTTER.
 2. CONSTRUCT 1/2" EXPANSION JOINTS AT 60' ON CENTER AND CONTRACTION JOINTS AT 15' ON CENTER.
 3. SEE CONCRETE CURB AND GUTTER, ITEM 305.1 OF STANDARD SPECIFICATIONS.
 4. ALL CONCRETE SHALL BE CLASS "C" (COMPRESSIVE STRENGTH OF 3600 PSI @ 28 DAYS).
 5. SAND SHALL NOT BE ACCEPTED AS COMPACTED SUBGRADE. SAND WILL BE ALLOWED FOR LEVEL-UP ONLY (2" MAX.).
 6. MATCH PAVEMENT THICKNESS WHEN PLACED MONOLITHIC WITH CONCRETE PAVEMENT.
 7. PROVIDE 1" GUTTER DEPRESSION.

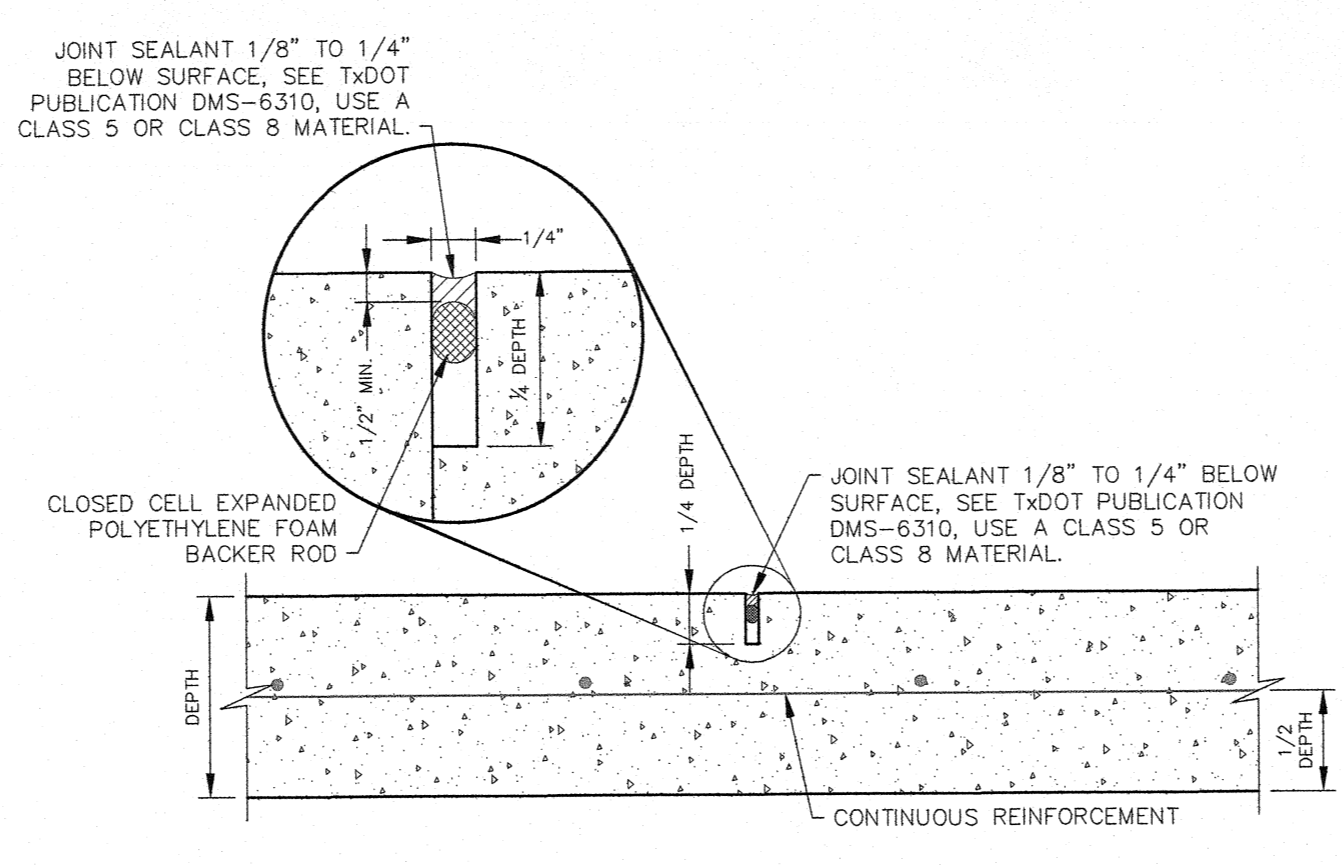

SAWED CONTRACTION JOINT

SCALE: NONE

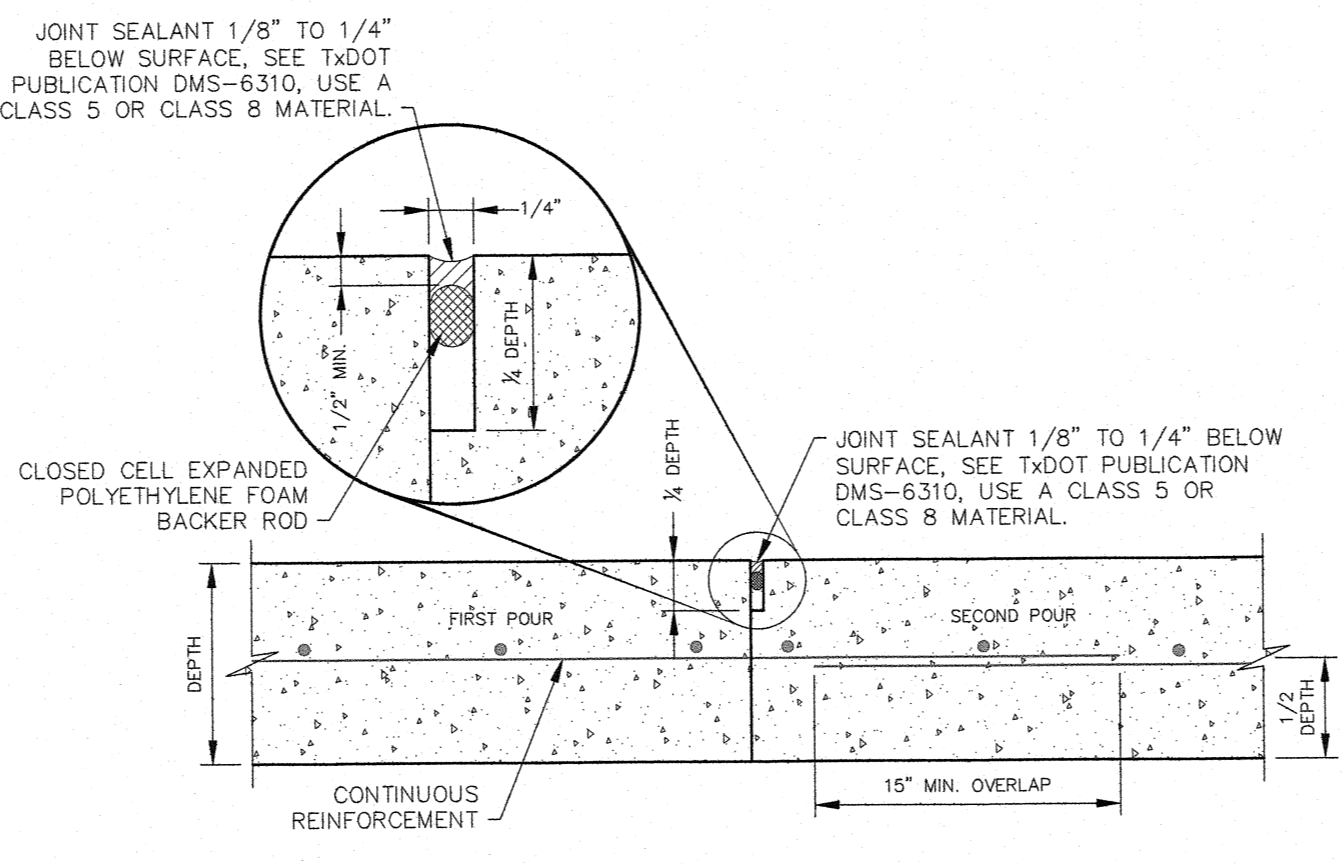

CONSTRUCTION JOINT

SCALE: NONE

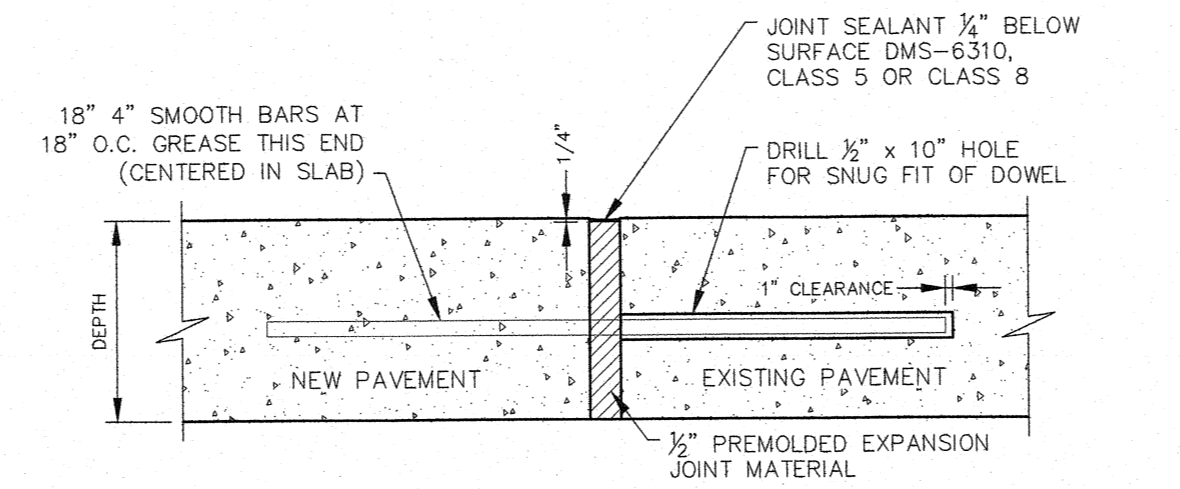

EXISTING PAVEMENT TIE-IN JOINT

SCALE: NONE

- GENERAL NOTES:**
1. SEE EXPANSION JOINTS, ITEM 303.5.4.2 OF STANDARD SPECIFICATIONS.

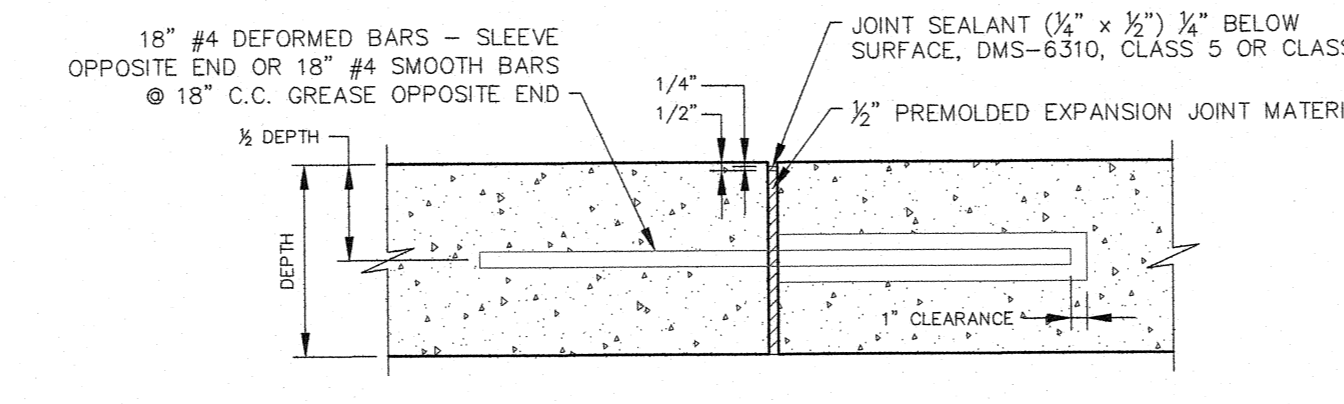

EXPANSION JOINT

SCALE: NONE

- GENERAL NOTES:**
1. SEE EXPANSION JOINTS, ITEM 303.5.4.2 OF THE STANDARD SPECIFICATIONS.
 2. DOWEL BARS MUST BE ADEQUATELY BRACED TO ASSURE THEY WILL BE MAINTAINED PERPENDICULAR TO JOINT DURING PLACEMENT OF CONCRETE.

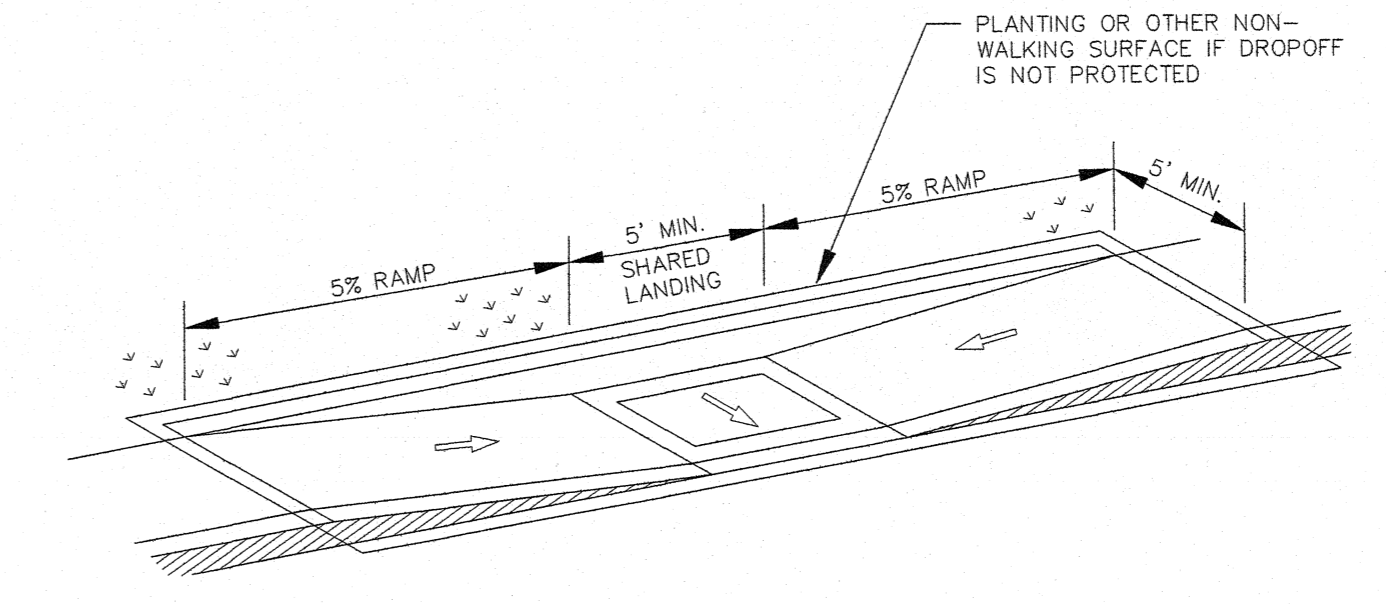

TYPE 2 PERPENDICULAR CURB RAMP

SCALE: NONE

- GENERAL NOTES:**
1. ALL SLOPES ARE MAXIMUM ALLOWABLE. THE LEAST POSSIBLE SLOPE THAT WILL STILL DRAIN PROPERLY SHOULD BE USED. RAMP LENGTH OR GRADE OF APPROACH SIDEWALKS MAY BE ADJUSTED AS DIRECTED BY THE ENGINEER.
 2. THE MINIMUM SIDEWALK WIDTH IS 4'. WHERE A 4' SIDEWALK CAN NOT BE PROVIDED DUE TO SITE CONSTRAINTS, A MINIMUM 3' SIDEWALK WITH 5'x5' PASSING AREAS AT INTERVALS NOT TO EXCEED 200 FT IS REQUIRED.
 3. LANDINGS SHALL BE 5'x5' MINIMUM WITH A MAXIMUM 2% SLOPE IN ANY DIRECTION.
 4. MANEUVERING SPACE AT THE BOTTOM OF CURB RAMPS SHALL BE A MINIMUM OF 4'x4' WHOLLY CONTAINED WITHIN THE CROSSWALK AND WHOLLY OUTSIDE THE PARALLEL VEHICULAR TRAVEL PATH.
 5. MAXIMUM ALLOWABLE CROSS SLOPE ON SIDEWALK AND RAMP SURFACES IS 2%.
 6. CURB RAMPS WITH RETURNED CURBS MAY BE USED ONLY WHERE PEDESTRIANS WOULD NOT NORMALLY WALK ACROSS THE RAMP. OTHERWISE, FLARED SIDES SHALL BE PROVIDED.
 7. ALL CONCRETE SURFACES SHALL RECEIVE A LIGHT BROOM FINISH UNLESS NOTED OTHERWISE IN THE PLANS.
 8. RAMP TEXTURES MUST CONSIST OF TRUNCATED DOMED SURFACES. TEXTURES ARE REQUIRED TO BE DETECTABLE UNDERFOOT SURFACES THAT WOULD ALLOW WATER TO ACCUMULATE ARE PROHIBITED.
 9. ADDITIONAL INFORMATION ON CURB RAMP LOCATION, DESIGN, LIGHT REFLECTIVE VALUE AND TEXTURE MAY BE FOUND IN THE CURRENT EDITION OF THE TEXAS ACCESSIBILITY STANDARDS (TAS) PREPARED AND ADMINISTERED BY THE TEXAS DEPARTMENT OF LICENSING AND REGULATION (TLDR).
 10. RAISED MEDIANS SEPARATE OPPOSING DIRECTIONS OF TRAFFIC AND PROVIDE A REFUGE AREA FOR PEDESTRIANS UNABLE TO CROSS THE ENTIRE ROADWAY IN THE ALLOTTED SIGNAL PHASE. TO SERVE AS A REFUGE AREA, THE MEDIAN SHOULD BE A MINIMUM OF 5' WIDE. MEDIANS SHOULD BE DESIGNED TO PROVIDE ACCESSIBLE PASSAGE OVER OR THROUGH THEM.
 11. CROSSWALK DIMENSIONS, CROSSWALK MARKINGS AND STOP BAR LOCATIONS SHALL BE AS SHOWN ELSEWHERE IN THE PLANS. AT INTERSECTIONS WHERE CROSSWALK MARKINGS ARE NOT REQUIRED, RAMPS SHALL BE ALIGNED WITH THEORETICAL CROSSWALKS, OR AS DIRECTED BY THE ENGINEER.
 12. EXISTING FEATURES THAT COMPLY WITH TAS MAY REMAIN IN PLACE UNLESS OTHERWISE SHOWN ON THE PLANS.
 13. HANDRAILS ARE NOT REQUIRED ON CURB RAMPS. CURB RAMPS SHALL BE PROVIDED WHEREVER ON ACCESSIBLE ROUTE CROSSES (PENETRATES) A CURB.
 14. SHADED AREAS INDICATE LOCATIONS OF DETECTABLE WARNINGS. (COLOR/LIGHT REFLECTIVE VALUE AND TEXTURE CONTRAST)

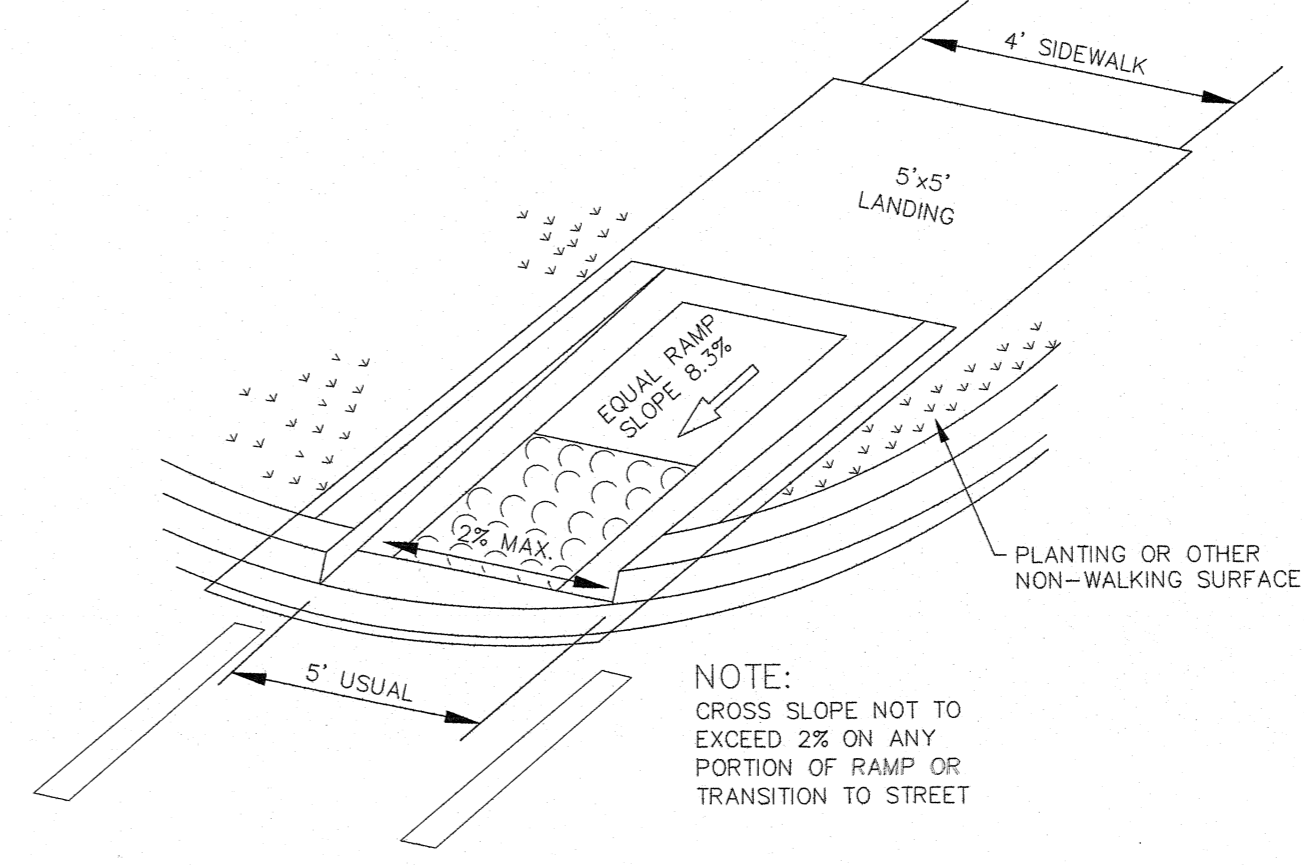

TYPE 5 DIRECTIONAL RAMP WITHIN RADIUS

SCALE: NONE

- PEDESTRIAN FACILITIES CURB RAMP NOTES:**
1. INSTALL A CURB RAMP AT EACH PEDESTRIAN STREET CROSSING.
 2. RAMP SHALL NOT BE STEEPER THAN 1:1 AND PAVEMENT COUNTER SLOPE SHALL NOT EXCEED 20:1 TOWARDS THE RAMP. ALL SLOPES SHOULD BE MAINTAINED UNLESS SLOPES THAT WILL STILL DRAIN PROPERLY SHOULD BE USED. ADJUST CURB RAMP LENGTH OR GRADE OF APPROACH SIDEWALKS AS DIRECTED.
 3. MAXIMUM ALLOWABLE CROSS SLOPE ON SIDEWALK AND CURB RAMP SURFACES IS 2%.
 4. GUTTER FLOW LINE AND STREET PROFILE SHALL BE MAINTAINED THROUGH THE RAMP AREA WITH A SMOOTH TRANSITION BETWEEN RAMP AND STREET. ENSURE THAT POSITIVE DRAINAGE IS OBTAINED OFF LANDING AREA AND RAMP. CHANGES IN LEVEL GREATER THAN 1/4" ARE NOT PERMITTED.
 5. PROVIDE FLARED SIDES WHERE THE PEDESTRIAN CIRCULATION PATH CROSSES THE CURB RAMP. FLARED SIDES SHALL BE SLOPED AT 10% MAXIMUM, MEASURED PARALLEL TO THE CURB. RETURNED CURBS MAY BE USED ONLY WHERE PEDESTRIANS WOULD NOT NORMALLY WALK ACROSS THE RAMP, OTHER BECAUSE THE ADJACENT SURFACE IS PLANTED, SUBSTANTIALLY OBSTRUCTED OR OTHERWISE PROTECTED.
 6. LANDINGS SHALL BE 5'x5' MINIMUM WITH A MAXIMUM 2% SLOPE IN ANY DIRECTION.
 7. MANEUVERING SPACE AT THE BOTTOM OF THE CURB RAMPS SHALL BE A MINIMUM OF 4'x4' WHOLLY CONTAINED WITHIN THE CROSSWALK AND WHOLLY OUTSIDE THE PARALLEL VEHICULAR TRAVEL PATH.
 8. PLACE CONCRETE AT A MINIMUM DEPTH OF 5" FOR RAMPS, FLARES AND LANDINGS UNLESS OTHERWISE DIRECTED. THE GUTTER PORTION OF THE RAMP IS MINIMUM 6" DEPTH OR MATCH ADJACENT PAVEMENT THICKNESS.
 9. ALL CONCRETE SHALL BE CLASS "A" (COMPRESSIVE STRENGTH OF 3000 PSI @ 28 DAYS).
 10. RAMP AND LANDING AREA REINFORCING SHALL BE #3 BARS @ 18" O.C.E.W.
 11. DETECTABLE WARNINGS SHALL CONSIST OF A CAST-IN-PLACE DETECTABLE WARNING SURFACE AS MANUFACTURED BY DUNLOP. ALL SURFACES SHOULD BE PERPENDICULAR TO THE GRADE BREAK BETWEEN THE RAMP RUN AND THE STREET. DETECTABLE WARNING SURFACES MAY BE CURVED ALONG THE CORNER RADIUS.
 12. DETECTABLE WARNING SURFACES SHALL BE A MINIMUM OF 24" IN DEPTH IN THE DIRECTION OF PEDESTRIAN TRAVEL AND EXTEND THE FULL WIDTH OF THE CURB RAMP OR LANDING WHERE THE PEDESTRIAN ACCESS ROUTE ENTERS THE STREET.
 13. DETECTABLE WARNING SURFACES SHALL BE LOCATED SO THAT THE EDGE NEAREST THE CURB LINE IS AT THE BACK OF THE CURB. ALONG ROADS OR CURVES TO BE PERPENDICULAR TO THE GRADE BREAK BETWEEN THE RAMP RUN AND THE STREET. DETECTABLE WARNING SURFACES MAY BE CURVED ALONG THE CORNER RADIUS.
 14. PLACE UTILITY POLES, GROUND BOXES, METER BOXES, SODS, DRAINAGE FACILITIES AND OTHER ITEMS SO AS NOT TO OBSTRUCT THE PEDESTRIAN ACCESS ROUTE OR CLEAR GROUND SPACE.
 15. RAMP LIMITS OF PAVEMENT SHALL INCLUDE RAMP, LANDINGS, REQUIRED FLARES AND GUTTER ADJACENT TO RAMP AND FLARES.

© 2018 BYSP architects, 1505 North Street - Suite 200 Wichita Falls, Texas 76798 (940) 763-5404

REV. DATE DESCRIPTION

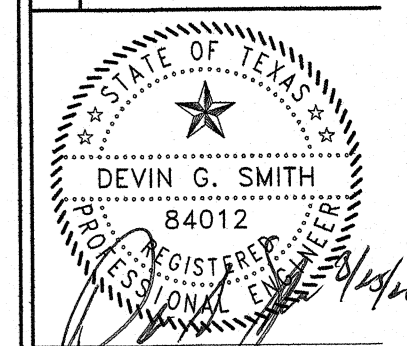

DANIEL BUILDING RENOVATION
J.S. BRIDWELL ACTIVITIES CENTER &
CANNED GREEK COMMONS



BYSP architects

DRAWN BY: WAT
CHECKED BY: DGS
DATE: AUGUST, 2020
PROJECT NO.: 34577

GRADING DETAILS

CORLETT, PROBST & BOYD, P.L.L.C.
4605 Old Jockboro Highway
Wichita Falls, Texas 76792
Telephone (940) 723-1455
Fax (940) 397-0549

C104

LEGEND

- ⊕ FIRE HYDRANT
- ⊕ FIRE RISER
- ⊕ FIRE VALVE
- ⊕ GUARD POST
- ⊕ LIGHT POLE
- ⊕ MANHOLE
- ⊕ SANITARY SEWER MANHOLE
- ⊕ STORM SEWER MANHOLE
- ⊕ SIGN
- ⊕ POWER POLE
- ⊕ SEWER CLEANOUT
- ⊕ IRRIGATION CONTROL VALVE
- ⊕ TELEPHONE PEDESTAL
- ⊕ WATER METER
- ⊕ WATER VALVE
- - - EXISTING FENCE
- - - EXISTING INDEX CONTOUR
- - - EXISTING INTERMEDIATE CONTOUR
- - - EXISTING SPOT ELEVATION
- ⊕ HANDICAPPED PARKING SYMBOL
- ⊕ EXISTING ASPHALT
- ⊕ EXISTING CONCRETE
- ⊕ EXISTING GRAVEL
- ⊕ PROPOSED CONCRETE

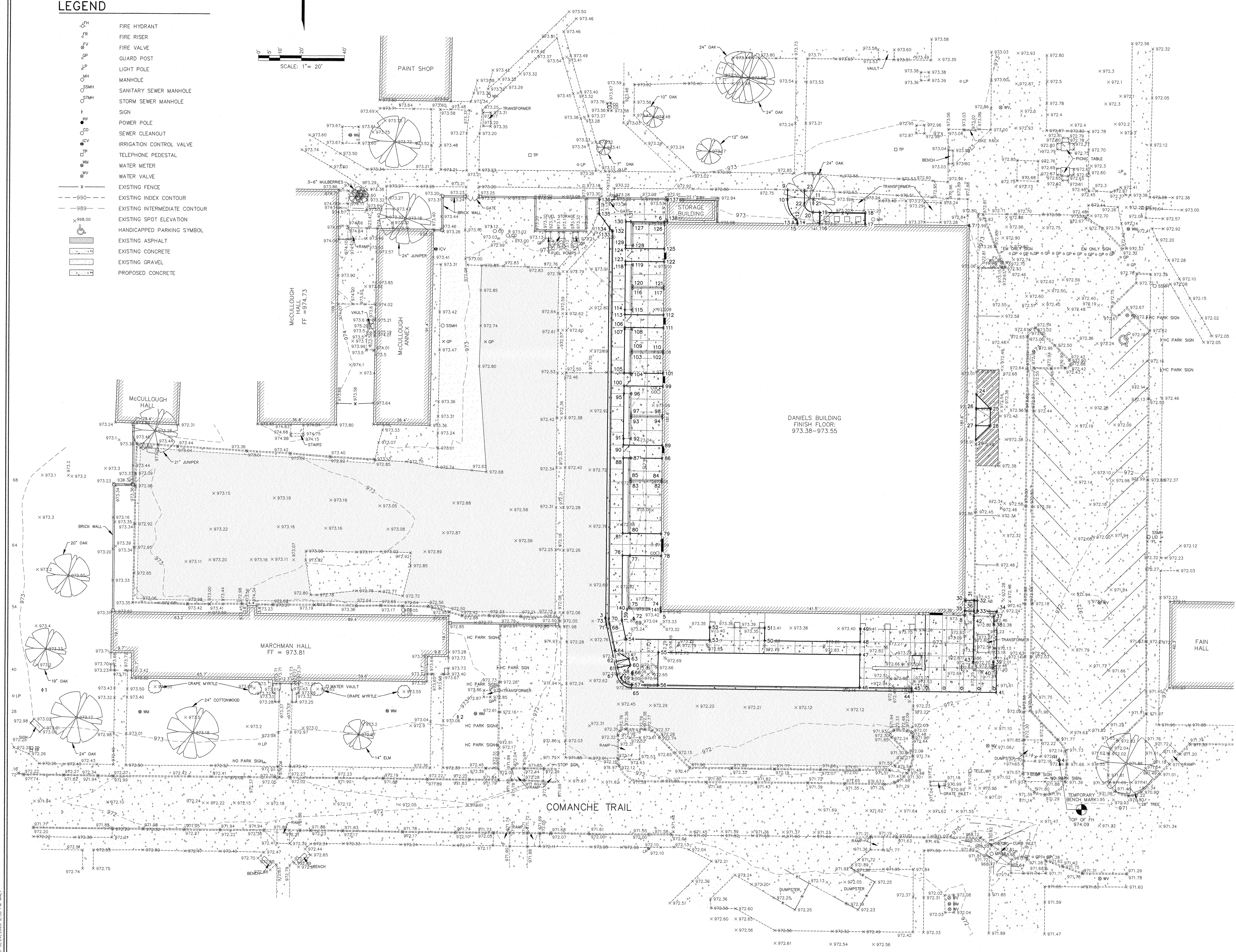
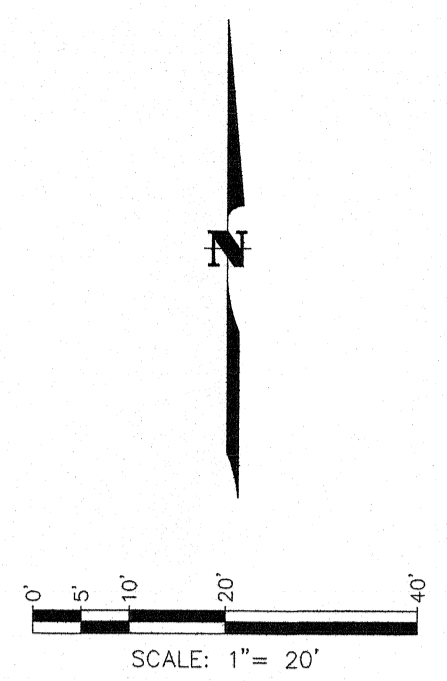

| Point Table | | | | Point Table | | | |
|-------------|------------|------------|-------------|-------------|------------|------------|-------------|
| Point # | Northing | Eastng | Description | Point # | Northing | Eastng | Description |
| 1 | 7365283.45 | 1961360.76 | WRK PT | 72 | 7365318.06 | 1961635.81 | RAD |
| 2 | 7365271.84 | 1961554.17 | WRK PT | 73 | 7365318.13 | 1961622.81 | PNT STK |
| 3 | 7365318.24 | 1961622.60 | WRK PT | 74 | 7365323.22 | 1961648.34 | ALT BID |
| 4 | 7365253.08 | 1961834.06 | TOP FH | 75 | 7365323.30 | 1961633.84 | ALT BID |
| 5 | 7365321.33 | 1961648.33 | BLDG | 76 | 7365347.40 | 1961630.47 | PNT STK |
| 6 | 7365502.88 | 1961649.29 | BLDG | 77 | 7365347.38 | 1961633.97 | ALT BID |
| 7 | 7365501.97 | 1961791.02 | BLDG | 78 | 7365347.30 | 1961648.47 | PNT STK |
| 8 | 7365320.33 | 1961789.80 | BLDG | 79 | 7365357.64 | 1961648.37 | PNT STK |
| 9 | 7365518.17 | 1961706.47 | PNT STK | 80 | 7365357.71 | 1961634.02 | ALT BID |
| 10 | 7365513.56 | 1961706.44 | PNT STK | 81 | 7365357.73 | 1961630.52 | PNT STK |
| 11 | 7365513.48 | 1961718.44 | RAD | 82 | 7365381.72 | 1961648.65 | ALT BID |
| 12 | 7365504.59 | 1961710.37 | PNT STK | 83 | 7365381.79 | 1961634.15 | ALT BID |
| 13 | 7365503.11 | 1961709.03 | RAD | 84 | 7365382.88 | 1961648.65 | ALT BID |
| 14 | 7365503.10 | 1961711.03 | PNT STK | 85 | 7365382.96 | 1961634.16 | ALT BID |
| 15 | 7365502.48 | 1961711.03 | PNT STK | 86 | 7365382.80 | 1961648.71 | PNT STK |
| 16 | 7365502.46 | 1961721.36 | PNT STK | 87 | 7365392.88 | 1961634.21 | ALT BID |
| 17 | 7365502.31 | 1961742.69 | PNT STK | 88 | 7365392.90 | 1961630.71 | PNT STK |
| 18 | 7365507.64 | 1961742.73 | PNT STK | 89 | 7365398.80 | 1961648.74 | PNT STK |
| 19 | 7365507.79 | 1961721.40 | PNT STK | 90 | 7365398.90 | 1961630.74 | PNT STK |
| 20 | 7365507.81 | 1961718.40 | PNT STK | 91 | 7365401.92 | 1961630.76 | ALT BID |
| 21 | 7365511.98 | 1961718.43 | RAD | 92 | 7365401.90 | 1961634.26 | ALT BID |
| 22 | 7365512.01 | 1961714.26 | PNT STK | 93 | 7365411.79 | 1961634.31 | PNT STK |
| 23 | 7365517.85 | 1961714.30 | PNT STK | 94 | 7365411.72 | 1961648.81 | ALT BID |
| 24 | 7365423.41 | 1961794.79 | PNT STK | 95 | 7365422.90 | 1961630.87 | ALT BID |
| 25 | 7365416.78 | 1961801.33 | PNT STK | 96 | 7365422.84 | 1961634.37 | ALT BID |
| 26 | 7365416.82 | 1961794.74 | PNT STK | 97 | 7365412.96 | 1961634.31 | ALT BID |
| 27 | 7365408.82 | 1961794.69 | PNT STK | 98 | 7365412.88 | 1961648.81 | ALT BID |
| 28 | 7365408.78 | 1961801.28 | PNT STK | 99 | 7365426.38 | 1961648.89 | PNT STK |
| 29 | 7365402.24 | 1961794.65 | PNT STK | 100 | 7365426.48 | 1961630.89 | PNT STK |
| 30 | 7365327.33 | 1961789.85 | PNT STK | 101 | 7365432.38 | 1961648.92 | PNT STK |
| 31 | 7365327.30 | 1961794.16 | PNT STK | 102 | 7365441.72 | 1961648.97 | ALT BID |
| 32 | 7365327.29 | 1961795.66 | PNT STK | 103 | 7365441.79 | 1961634.47 | ALT BID |
| 33 | 7365322.35 | 1961795.62 | PNT STK | 104 | 7365431.90 | 1961634.41 | ALT BID |
| 34 | 7365322.28 | 1961804.84 | PNT STK | 105 | 7365432.48 | 1961630.92 | PNT STK |
| 35 | 7365322.33 | 1961789.82 | PNT STK | 106 | 7365453.65 | 1961631.03 | PNT STK |
| 36 | 7365322.30 | 1961794.12 | PNT STK | 107 | 7365452.85 | 1961631.03 | ALT BID |
| 37 | 7365319.96 | 1961803.33 | PNT STK | 108 | 7365452.84 | 1961634.53 | ALT BID |
| 38 | 7365316.09 | 1961803.31 | PNT STK | 109 | 7365442.96 | 1961634.47 | ALT BID |
| 39 | 7365298.75 | 1961803.22 | PNT STK | 110 | 7365442.88 | 1961648.97 | ALT BID |
| 40 | 7365295.87 | 1961803.19 | PNT STK | 111 | 7365453.55 | 1961649.03 | PNT STK |
| 41 | 7365284.54 | 1961804.65 | PNT STK | 112 | 7365459.55 | 1961649.06 | PNT STK |
| 42 | 7365320.02 | 1961794.07 | PNT STK | 113 | 7365459.65 | 1961631.06 | PNT STK |
| 43 | 7365298.61 | 1961793.90 | PNT STK | 114 | 7365461.92 | 1961631.07 | ALT BID |
| 44 | 7365284.81 | 1961765.32 | PNT STK | 115 | 7365461.90 | 1961634.57 | ALT BID |
| 45 | 7365286.31 | 1961765.33 | PNT STK | 116 | 7365471.91 | 1961634.63 | ALT BID |
| 46 | 7365286.48 | 1961741.05 | PNT STK | 117 | 7365471.72 | 1961649.13 | ALT BID |
| 47 | 7365301.65 | 1961741.16 | PNT STK | 118 | 7365482.85 | 1961631.19 | ALT BID |
| 48 | 7365307.65 | 1961741.20 | PNT STK | 119 | 7365482.84 | 1961634.69 | ALT BID |
| 49 | 7365313.72 | 1961741.25 | PNT STK | 120 | 7365472.96 | 1961634.63 | ALT BID |
| 50 | 7365307.96 | 1961696.76 | PNT STK | 121 | 7365472.88 | 1961649.13 | ALT BID |
| 51 | 7365313.90 | 1961696.80 | PNT STK | 122 | 7365484.38 | 1961649.19 | PNT STK |
| 52 | 7365314.08 | 1961671.23 | PNT STK | 123 | 7365484.48 | 1961631.19 | PNT STK |
| 53 | 7365308.14 | 1961671.19 | PNT STK | 124 | 7365490.48 | 1961631.23 | PNT STK |
| 54 | 7365308.42 | 1961632.23 | PNT STK | 125 | 7365490.38 | 1961649.23 | PNT STK |
| 55 | 7365302.31 | 1961647.28 | PNT STK | 126 | 7365501.71 | 1961649.29 | ALT BID |
| 56 | 7365287.15 | 1961647.17 | PNT STK | 127 | 7365501.79 | 1961634.79 | ALT BID |
| 57 | 7365287.23 | 1961635.08 | PNT STK | 128 | 7365491.90 | 1961634.73 | ALT BID |
| 58 | 7365292.73 | 1961635.11 | RAD | 129 | 7365491.91 | 1961631.23 | ALT BID |
| 59 | 7365290.43 | 1961630.12 | PNT STK | 130 | 7365502.97 | 1961631.29 | PNT STK |
| 60 | 7365296.37 | 1961634.34 | PNT STK | 131 | 7365502.96 | 1961633.63 | ALT BID |
| 61 | 7365295.10 | 1961628.48 | PNT STK | 132 | 7365498.59 | 1961625.27 | PNT STK |
| 62 | 7365298.04 | 1961627.84 | PNT STK | 133 | 7365498.60 | 1961624.77 | PNT STK |
| 63 | 7365299.31 | 1961633.71 | PNT STK | 134 | 7365499.96 | 1961623.78 | PNT STK |
| 64 | 7365303.03 | 1961627.26 | PNT STK | 135 | 7365506.63 | 1961618.90 | PNT STK |
| 65 | 7365285.74 | 1961634.86 | PNT STK | 136 | 7365513.26 | 1961618.94 | PNT STK |
| 66 | 7365292.95 | 1961635.33 | RAD | 137 | 7365513.33 | 1961650.60 | PNT STK |
| 67 | 7365291.69 | 1961628.22 | PNT STK | 138 | 7365502.87 | 1961650.52 | PNT STK |
| 68 | 7365315.46 | 1961624.57 | PNT STK | 139 | 7365317.29 | 1961630.31 | PNT STK |
| 69 | 7365317.89 | 1961635.81 | RAD | 140 | 7365322.14 | 1961632.67 | ALT BID |
| 70 | 7365317.95 | 1961624.31 | PNT STK | 141 | 7365322.05 | 1961648.33 | ALT BID |
| 71 | 7365315.31 | 1961623.10 | PNT STK | | | | |

FILE: 34577DANIELS STK.ASC

REV. DATE DESCRIPTION

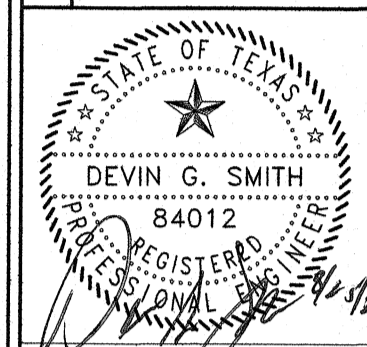

DANIEL BUILDING RENOVATION
J.S. BRIDWELL ACTIVITES CENTER &
CANNEDY GREEK COMMONS



BYSP architects
1400 S. Street - Suite 100 - Wichita Falls, Texas 76798 (940) 603-2644

DRAWN BY: WAT
 CHECKED BY: OSS
 DATE: AUGUST, 2020
 PROJECT NO.: 34577
 DIMENSION CONTROL PLAN

CORLETT, PROBST & BOYD, P.L.L.C.
 4805 Old Jackalboro Highway Telephone (940) 723-1455
 Wichita Falls, Texas 76702 Fax (940) 397-0549