

 GLENDIA G. RAMSEY #15203
 EXPIRES: 25 AUGUST 2020
 DATE SIGNED: 2/24/2020

HPA
 ARCHITECTS - PROGRAMMERS - PLANNERS
 HARPER PERKINS ARCHITECTS, INC.
 4724 OLD JACKSBORO HIGHWAY
 WICHITA FALLS, TEXAS 76302-3599
 VOICE: 843.747.1427 FAX: 843.397.0272
 E-MAIL: office@harperperkins.com WEB: www.harperperkins.com

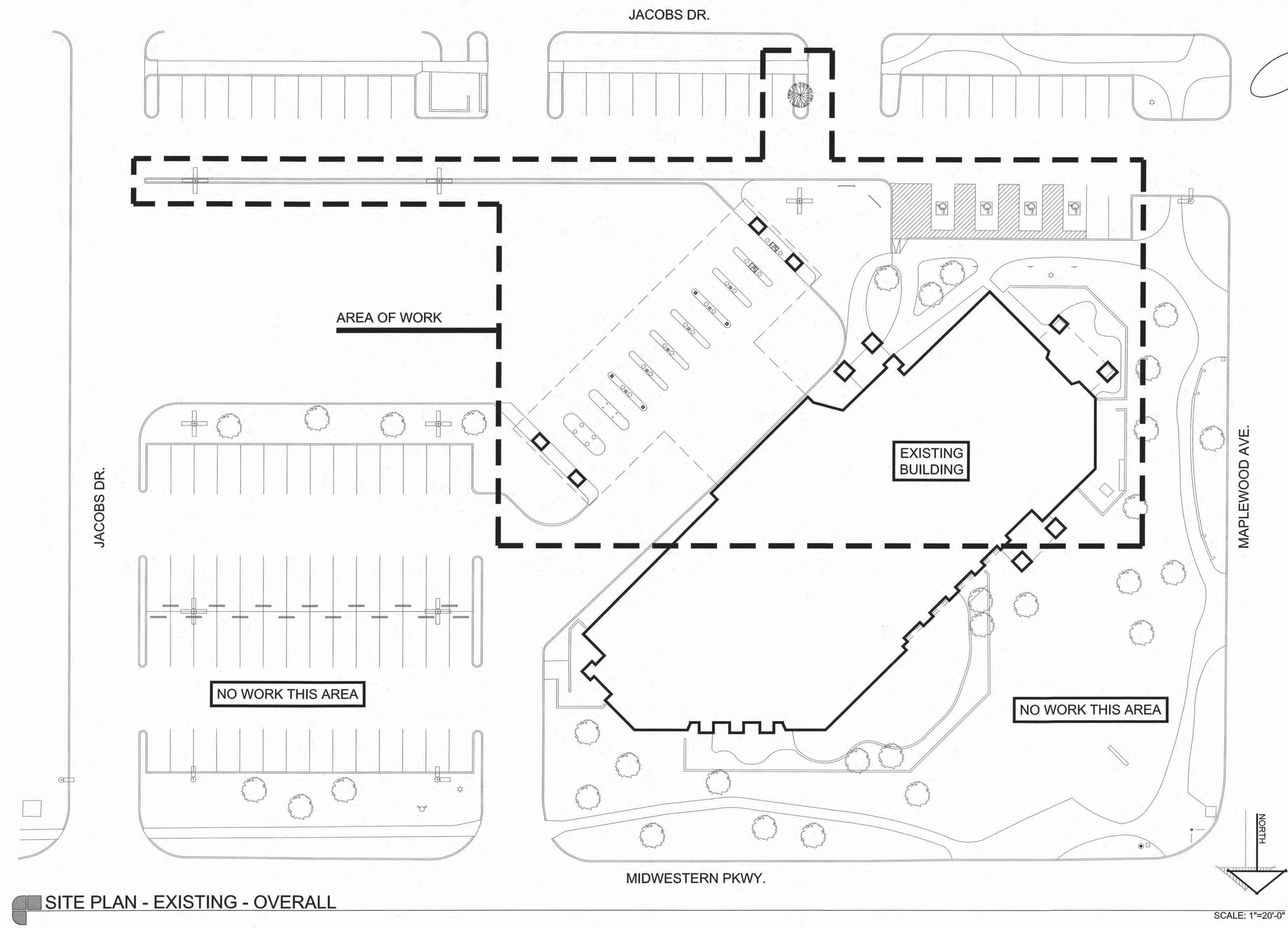

SITE PLAN - EXISTING - OVERALL

SCALE: 1"=20'-0"

OFFICE RENOVATIONS FOR
MSU TEXAS
 PURCHASING DEPARTMENT



DRAWN BY: HPA

DATE: 03 FEBRUARY 2020

REVISIONS

NO.	DESCRIPTION	DATE

19855.00

© HARPER PERKINS ARCHITECTS

CD100

2733 MIDWESTERN PARKWAY WICHITA FALLS, TX

Z:\00000\00-Master Project Directory\19855.00-MSU Purchasing Dept Renovations\Drawings\Construction Documents\Sheets\19855.00-CD 100.dwg, 2/20/2020 12:03:43 PM

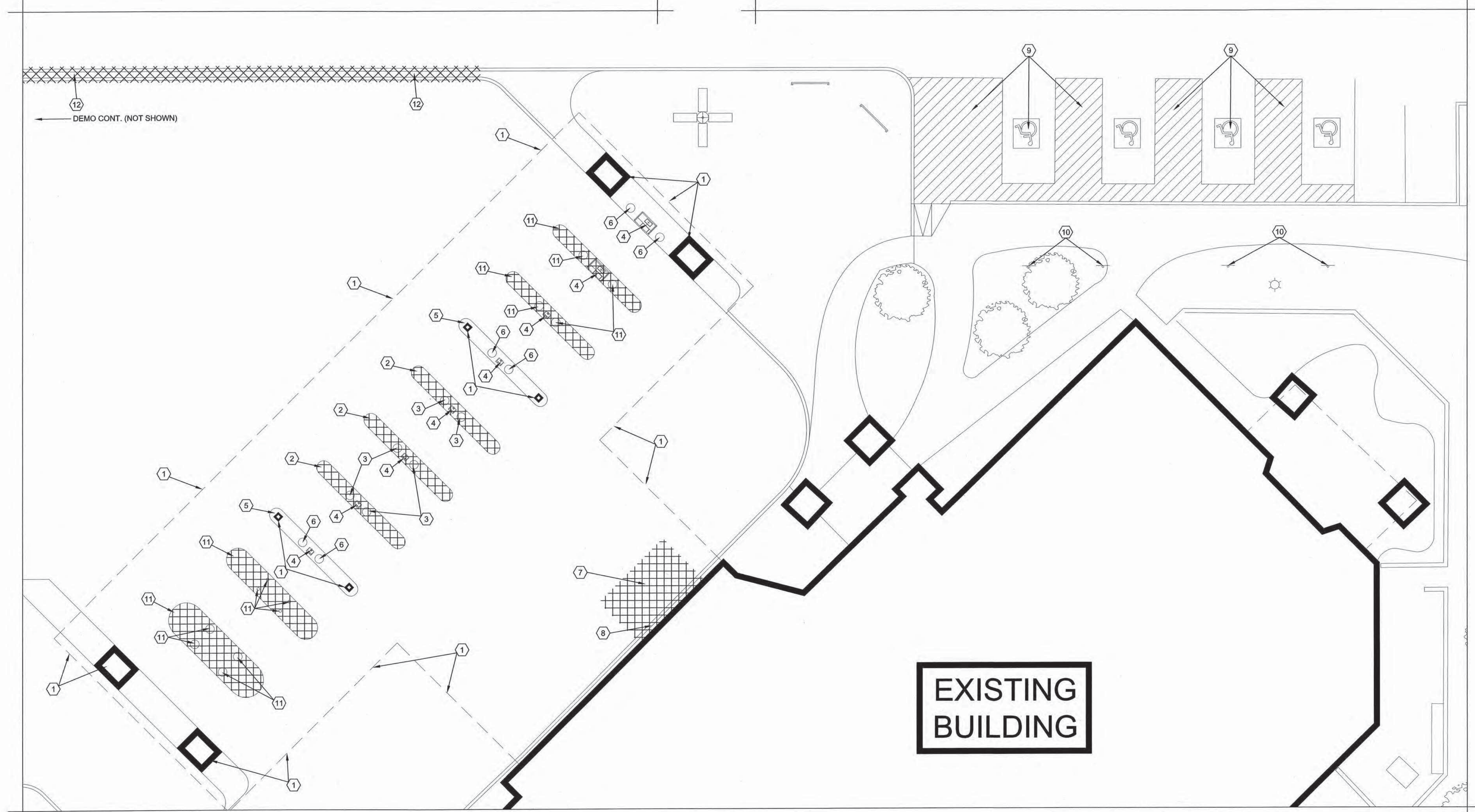

SITE DEMOLITION PLAN

SCALE: 1"=20'-0"

SITE DEMOLITION KEYNOTES	
1	EXISTING CANOPY TO REMAIN INCLUDING FOUNDATION, COLUMNS, AND OVERHEAD STRUCTURE. PROTECT FROM DAMAGE DURING CONSTRUCTION.
2	REMOVE EXISTING CONCRETE LANE SEPARATOR COMPLETELY.
3	REMOVE EXISTING CONCRETE BOLLARDS COMPLETELY.
4	REMOVE EXISTING PNEUMATIC TUBE TELLER SYSTEM AND ASSOCIATED TUBING COMPLETELY TO NEAREST FITTING ABOVE CANOPY AND PATCH HOLE IN CANOPY WITH STAINLESS STEEL PLATE AS REQUIRED. NOTE: ALL ARE BEING REMOVED UNDER THE BASE BID.
5	EXISTING CONCRETE LANE SEPARATOR TO REMAIN. PROTECT FROM DAMAGE DURING CONSTRUCTION.
6	EXISTING CONCRETE BOLLARD TO REMAIN. PROTECT FROM DAMAGE DURING CONSTRUCTION.
7	REMOVE A PORTION OF THE EXISTING CONCRETE DRIVE PAVING FOR THE INSTALLATION OF A NEW CONCRETE RAMP INTO THE EXISTING BUILDING. REFER CIVIL DRAWINGS FOR SCOPE OF WORK.
8	REMOVE A PORTION OF THE EXISTING CONCRETE CURB AND GUTTER FOR THE INSTALLATION OF A NEW CONCRETE RAMP INTO THE EXISTING BUILDING. REFER CIVIL DRAWINGS FOR SCOPE OF WORK.
9	EXISTING HANDICAPPED PARKING AREA TO REMAIN.
10	EXISTING HANDICAPPED PARKING POLE AND SIGN TO REMAIN.
11	***ALTERNATE #4*** - REMOVE EXISTING CONCRETE LANE SEPARATOR AND ASSOCIATED BOLLARDS COMPLETELY. AS CLARIFICATION, PER NOTE #4 ABOVE, PNEUMATIC TUBE SYSTEM IS TO BE REMOVED UNDER BASE BID.
12	***ALTERNATE #6*** - REMOVE EXISTING CONCRETE LANE SEPARATOR (225 L.F.) AND LEAVE EXISTING LIGHT POLES & BASES.
13	***ALTERNATE #7*** - REMOVE EXISTING TREE COMPLETELY AND A PORTION OF THE EXISTING TOPSOIL AND PREPARE ISLAND TO RECEIVE NEW CONCRETE PAVING.

OFFICE RENOVATIONS FOR
MSU TEXAS
 PURCHASING DEPARTMENT
 2733 MIDWESTERN PARKWAY
 WICHITA FALLS, TX

DRAWN BY: HPA
 DATE: 03 FEBRUARY 2020
 REVISIONS

NO.	DESCRIPTION	DATE

19855.00
 © HARPER PERKINS ARCHITECTS
CD101

Z:\000000-00-Master Project Directory\19855-00-MSU Purchasing Dept Renovations\Drawings\Construction Documents\Sheets\19855-00-CD101.dwg, 2/20/2020 11:57:59 AM

OFFICE RENOVATIONS FOR
MSU TEXAS
 PURCHASING DEPARTMENT
 2733 MIDWESTERN PARKWAY

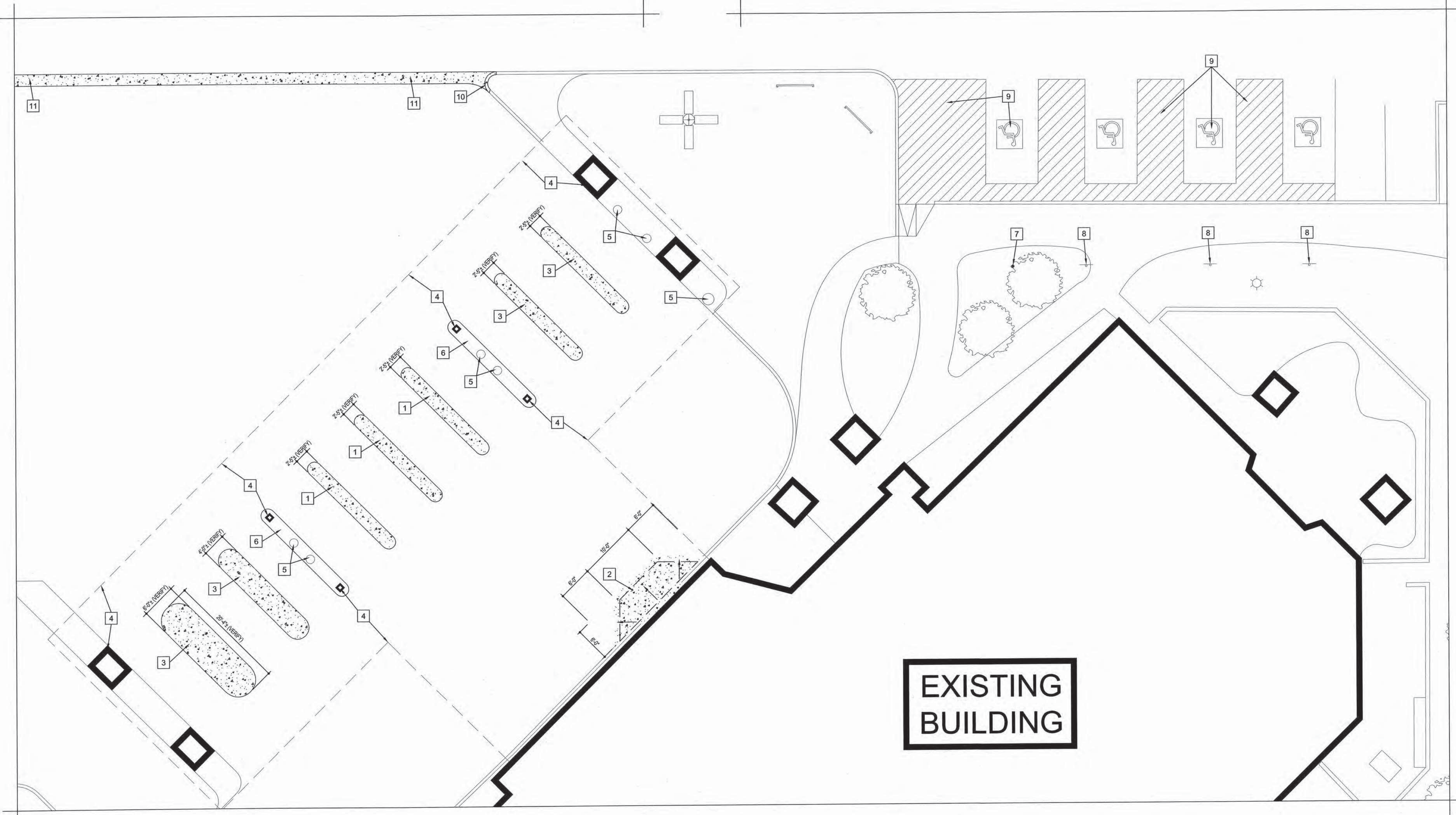

SITE DEMOLITION PLAN

SCALE: 1"=20'-0"

SITE PLAN KEYNOTES	
<p>***GENERAL NOTE: AT ALL LOCATIONS WHERE NEW CONCRETE PAVING WILL OCCUR ADJACENT TO EXISTING PAVING, PROVIDE 1/2" E.J. MATERIAL BETWEEN THEM AND CAULK-SEAL.***</p>	
1.	INSTALL NEW 3000 PSI CONCRETE PAVING. CONCRETE THICKNESS SHALL MATCH EXISTING ADJACENT PAVING THICKNESS AND SHALL BE POURED ON A 2" SAND CUSHION. REINFORCE PAVING W/ #3 @ 16" O.C.E.W. & DOWEL INTO EXISTING W/ #4 DOWELS @ 16" O.C.
2.	INSTALL NEW 3000 PSI CONCRETE RAMP WITH FLARED SIDES. SLOPE SHALL BE 1:12 MAX. CONCRETE SHALL BE REINFORCED WITH #3 @ 16" O.C.E.W. AND DOWELED INTO EXISTING PAVING W/ #4 DOWELS @ 16" O.C. PROVIDE 8"x12" WIDE THICKENED BEAM AT PERIMETER OF RAMP & REINFORCE WITH 2 - #5 CONTINUOUS. PLACE CONCRETE ON A 2" SAND CUSHION.
3.	***ALTERNATE #4*** - INSTALL NEW 3000 PSI CONCRETE PAVING. CONCRETE THICKNESS SHALL MATCH EXISTING ADJACENT PAVING AND SHALL BE POURED ON A 2" SAND CUSHION. REINFORCE PAVING W/ #3 @ 16" O.C.E.W. & DOWEL INTO EXISTING W/ #4 DOWELS @ 16" O.C.
4.	EXISTING CANOPY & ASSOCIATED STRUCTURE TO REMAIN.
5.	EXISTING CONCRETE BOLLARD TO REMAIN.
6.	EXISTING CONCRETE LANE SEPARATOR TO REMAIN.
7.	PROVIDE NEW "VAN ACCESSIBLE" SIGN BELOW EXISTING PARKING SIGNAGE.
8.	EXISTING HANDICAPPED PARKING SIGNAGE TO REMAIN.
9.	EXISTING HANDICAPPED PARKING PAINT STRIPING TO REMAIN.
10.	***ALTERNATE #6*** - PROVIDE NEW 3000 PSI CONCRETE CURB & GUTTER AND CONNECT TO EXISTING W/ #4 DOWELS. REINFORCE W/ #4 CONTINUOUS AROUND RADIUS OF CURB & GUTTER.
11.	***ALTERNATE #6*** - PROVIDE NEW 3000 PSI CONCRETE PAVING. CONCRETE THICKNESS SHALL MATCH EXISTING ADJACENT PAVING AND SHALL BE POURED ON A 2" SAND CUSHION. REINFORCE PAVING W/ #3 @ 16" O.C.E.W. & DOWEL INTO EXISTING W/ #4 DOWELS @ 16" O.C.
12.	***ALTERNATE #7*** - PROVIDE NEW 3000 PSI CONCRETE PAVING FOR ISLAND. CONCRETE THICKNESS SHALL BE 4" THICK W/ #3 @ 16" O.C.E.W. AND DOWELED INTO EXISTING CURB W/ #4 DOWELS @ 16" O.C.

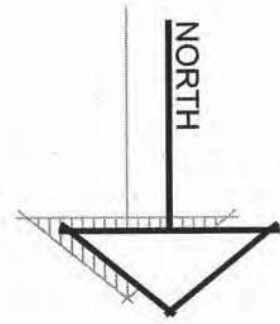

DRAWN BY: HPA

DATE: 03 FEBRUARY 2020

REVISIONS		
NO.	DESCRIPTION	DATE

19855.00

© HARPER PERKINS ARCHITECTS

CP101