

# 2017 PARKING LOT ADDITION PROJECT FOR MIDWESTERN STATE UNIVERSITY

3410 TAFT BOULEVARD  
WICHITA FALLS, TEXAS 76308

MARCH 2017



### BOARD OF REGENTS

- |                                     |                                     |
|-------------------------------------|-------------------------------------|
| MR. WARREN AYRES                    | MR. JEFF GREGG                      |
| MS. TIFFANY BURKS                   | MS. NANCY MARKS, SECRETARY          |
| MR. R. CAVEN CROSNOE, VICE CHAIRMAN | MR. SAMUEL M. SANCHEZ, CHAIRMAN     |
| DR. F. LYNWOOD GIVENS, PH.D.        | DR. SHELLEY SWEATT, ED.D.           |
| MR. SHAWN HESSING                   | MS. LINDSEY SHELLEY, STUDENT REGENT |

SUZANNE SHIPLEY, PH.D., PRESIDENT

MARILYN M. FOWLE, ED.D., V.P. ADMINISTRATION & FINANCE

KYLE C. OWEN, P.E., ASSOCIATE V.P. FACILITY SERVICES

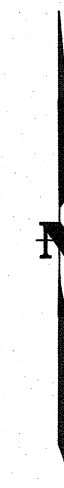
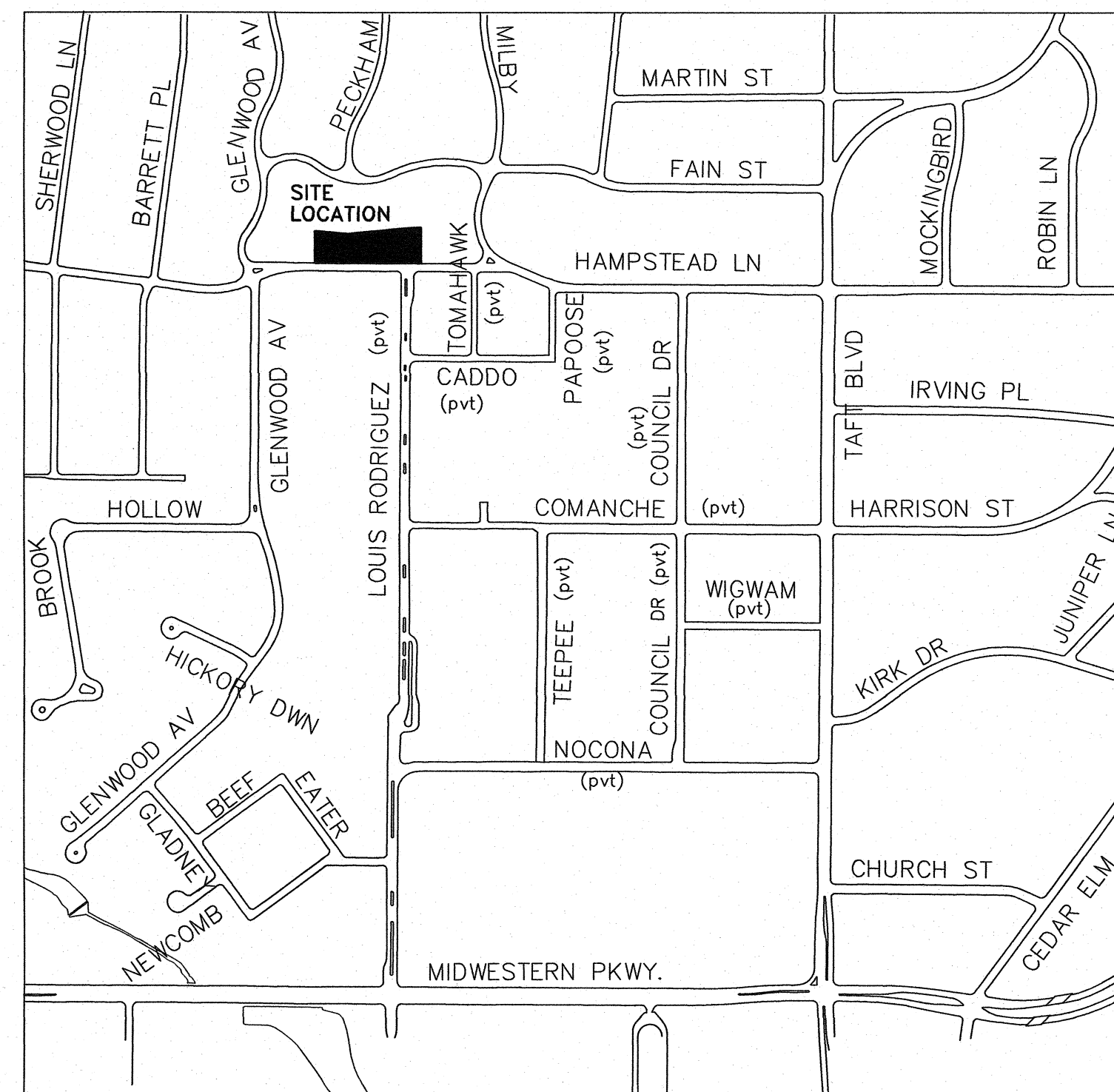

**PROJECT AREA:**

A NEW CONCRETE PARKING LOT TO BE CONSTRUCTED IN 2 PHASES. ONLY PHASE 1 WILL BE CONSTRUCTED AS PART OF THIS PROJECT.

PARKING LOT ADDITION PROJECT  
MIDWESTERN STATE UNIVERSITY  
HAMPSTEAD LANE

DRAWN	MWC	<b>CORLETT, PROBST &amp; BOYD, P.L.L.C.</b> ENGINEERS - SURVEYORS 4605 OLD JACKSBORO HIGHWAY WICHITA FALLS, TEXAS 76302
CHECKED	SLW	
APPROVED	SLW	
PHONE (840)723-1455 FAX (840)397-0549		

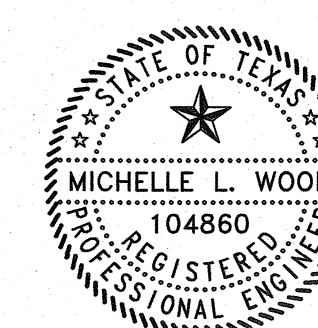

03/01/2017  
*Michelle L. Wood*  
MICHELLE L. WOOD  
REGISTERED PROFESSIONAL ENGINEER NO. 104860

SCALE: 1" = 20'	MARCH, 2017	SHEET 1 OF 7
-----------------	-------------	--------------

C:\MARK\2017\3125.DWG (OVERALL) P-31/2017 11:57 AM 5-31/2017 11:56 AM C.M.

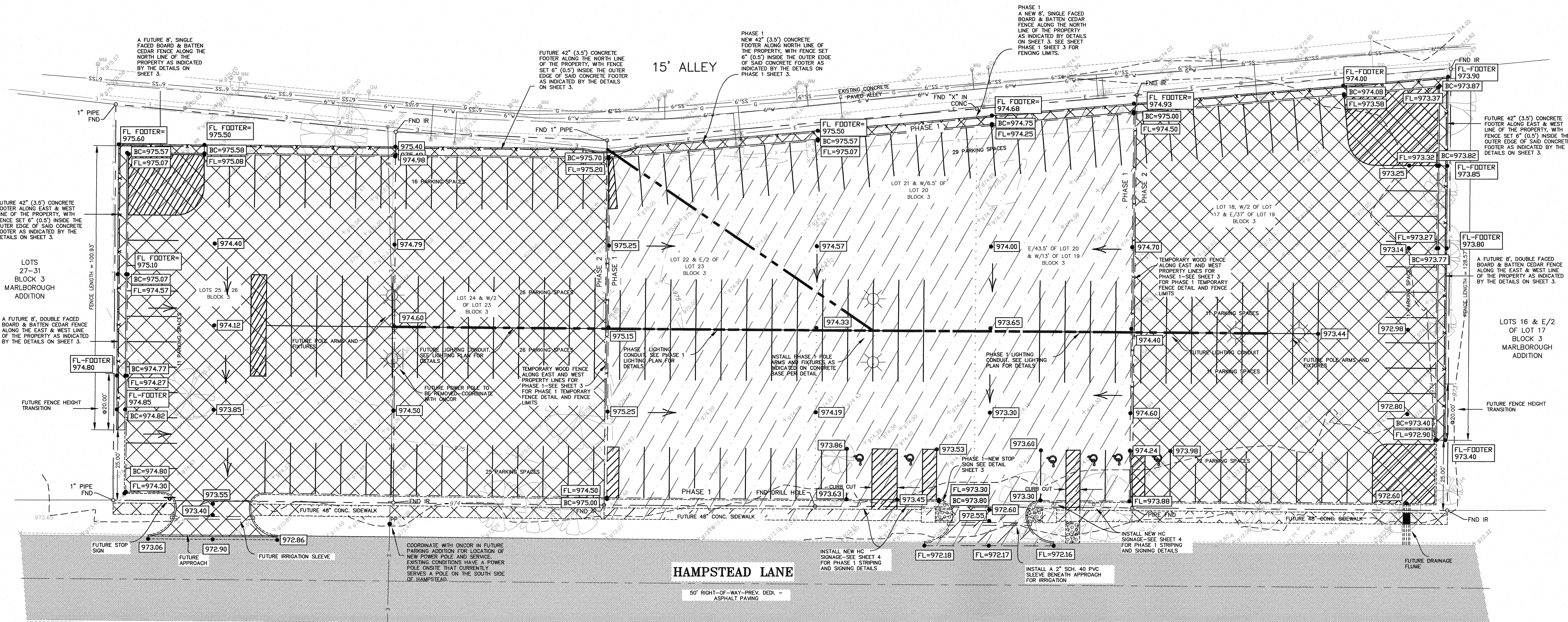

**LEGEND**

- |       |                               |        |                                 |
|-------|-------------------------------|--------|---------------------------------|
| +     | SIGN                          | 6"SS   | EXISTING 6" SANITARY SEWER LINE |
| PP    | POWER POLE                    | 6" W   | EXISTING 6" WATER LINE          |
| WM    | WATER METER                   | ---    | GUY WIRE                        |
| GM    | GAS METER                     | 988.00 | EXISTING SPOT ELEVATION         |
| ---   | EXISTING ELECTRIC LINE        | 00.00  | NEW SPOT ELEVATION              |
| x     | EXISTING FENCE                | ♿      | HANDICAPPED PARKING SYMBOL      |
| o     | EXISTING 4" GAS LINE          | CONC   | EXISTING CONCRETE               |
| -990- | EXISTING INDEX CONTOUR        | FND IR | PROPERTY CORNER (AS NOTED)      |
| -989- | EXISTING INTERMEDIATE CONTOUR |        |                                 |

**NOTE:**

THIS OVERALL CONCEPT PLAN HAS BEEN SHOWN FOR THE INTENT OF THE BUILD-OUT OF ALL SIX LOTS OWNED BY MWSU ON THE NORTH SIDE OF HAMPSTEAD LANE. MWSU INTENDS TO DEVELOP THE ENTIRE SIX LOTS AND CONSTRUCT A NEW PARKING LOT TO SERVE THE CAMPUS. THIS PROJECT WILL BE BUILT IN TWO SEPARATE PHASES. THESE PLANS ARE FOR THE CONSTRUCTION OF PHASE 1 ONLY (LOTS 22 THRU THE WEST 13' OF LOT 19, BLOCK 3, MARLBOROUGH ADDITION). THIS OVERALL CONCEPT PLAN IS FOR REFERENCE ONLY.

**CAUTION!!! - UNDERGROUND UTILITIES!!!**

EXISTING UTILITIES AND UNDERGROUND FACILITIES INDICATED ON THESE PLANS HAVE BEEN LOCATED APPROXIMATELY BY SIGHT OR FROM INFORMATION SUPPLIED BY THE VARIOUS OWNERS OF THE FACILITIES. THE ENGINEER AND OWNER DO NOT ACCEPT ANY RESPONSIBILITY FOR THE LOCATIONS SHOWN. IT SHALL BE THE SOLE RESPONSIBILITY OF THE CONTRACTOR TO VERIFY BOTH HORIZONTALLY AND VERTICALLY THE LOCATION OF ALL UTILITIES PRIOR TO CONSTRUCTION; TO TAKE NECESSARY PRECAUTIONS TO PROTECT ALL FACILITIES ENCOUNTERED; AND TO NOTIFY THE ENGINEER PROMPTLY OF ALL CONFLICTS WITH THE PROPOSED WORK. THE CONTRACTOR SHALL PRESERVE AND PROTECT ALL EXIST. UTILITIES AND FACILITIES FROM DAMAGE DURING CONSTRUCTION. ANY DAMAGE TO THESE FACILITIES BY THE CONTRACTOR SHALL BE REPAIRED BY THE CONTRACTOR AT HIS/HER SOLE EXPENSE. FACILITIES OWNED BY THE ENTITIES LISTED BELOW ARE KNOWN TO BE LOCATED ON OR IN CLOSE PROXIMITY TO THE WORK AREA OF THIS PROJECT. ADDITIONAL FACILITIES OWNED BY OTHERS MAY ALSO BE AFFECTED. CONTACT ALL POSSIBLE UTILITY AND UNDERGROUND FACILITY OWNERS.

- |  |                |
|--|----------------|
| CITY OF WICHITA FALLS UTILITY OPERATIONS | (940) 761-4333 |
| AT&T                                     | (940) 766-7217 |
| TEXAS DEPARTMENT OF TRANSPORTATION       | (940) 720-7709 |
| ONCOR ELECTRIC DELIVERY                  | (940) 766-5460 |
| UNDERGROUND FACILITIES LOCATOR SERVICE   | (800) 344-8377 |
| ATMOS ENERGY                             | (940) 696-7602 |

**HATCH LEGEND**

- |  |   |
|--|---|
|  | PHASE 1-AREA TO BE CONSTRUCTED AS PART OF THIS PROJECT                              |
|  | PHASE 2-AREA TO BE CONSTRUCTED IN FUTURE AND SHOWN FOR REFERENCE ONLY ON THIS SHEET |

**PARKING TOTALS:**

- PHASE 1 = 59 TOTAL PARKING SPACES  
4 HANDICAP PARKING SPACES
- PHASE 2 = 119 TOTAL PARKING SPACES  
2 HANDICAP PARKING SPACES
- OVERALL TOTAL (PHASE 1 & PHASE 2) =  
178 PARKING SPACES  
6 HANDICAP PARKING SPACES

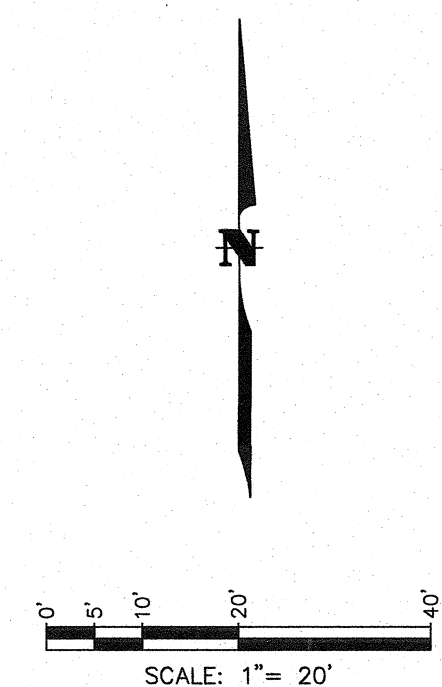

**OVERALL CONCEPT SITE PLAN  
MIDWESTERN STATE UNIVERSITY  
PARKING LOT ADDITION PROJECT  
HAMPSTEAD LANE**

DRAWN MWC  
CHECKED SLW  
APPROVED SLW

**CORLETT, PROBST & BOYD, P.L.L.C.**  
ENGINEERS - SURVEYORS  
4605 OLD JACKSBORO HIGHWAY  
WICHITA FALLS, TEXAS 76302

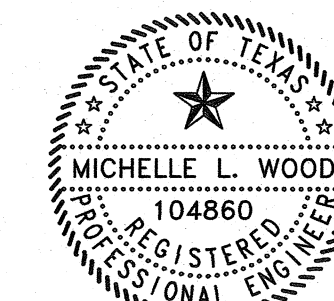

03/01/2017  
*Michelle L. Wood*  
MICHELLE L. WOOD  
REGISTERED PROFESSIONAL ENGINEER NO. 104860

SCALE: 1" = 20'

MARCH, 2017

SHEET 2 OF 7

# GENERAL NOTES FOR PAVING

- THIS PARKING LOT WILL BE CONSTRUCTED IN TWO SEPARATE PHASES. THIS PROJECT IS FOR THE CONSTRUCTION OF PHASE 1 ONLY. PHASE 2 WILL BE CONSTRUCTED IN THE FUTURE AS A SEPARATE PROJECT.
- DEMOLITION ITEMS FOR PHASE 1 ARE BEING DEMOLISHED BY A SEPARATE CONTRACT. EXISTING BUILDINGS, PAVEMENT, TREES, SHRUBS AND APPURTENANCES ARE BEING DEMOLISHED UNDER THIS SEPARATE CONTRACT. ANY REMAINING VEGETATIVE AND DELETERIOUS MATTER SHALL BE STRIPPED AND HAULED OFF-SITE TO AN OFF-SITE LOCATION BY THE CONTRACTOR.
- THE CONTRACTOR SHALL PLACE TEMPORARY FENCING AND NECESSARY TRAFFIC CONTROL AND PROTECTIVE DEVICES AROUND THE CONSTRUCTION SITE. THE TRAFFIC CONTROL AND PROTECTIVE DEVICES SHALL DISCOURAGE VEHICULAR AND PEDESTRIAN TRAFFIC FROM ENTERING OR CROSSING THE SITE. THE CONTRACTOR SHALL BE RESPONSIBLE FOR MAINTAINING THE TEMPORARY FENCE AND TRAFFIC CONTROL DEVICES USED AS WELL AS REMOVING THEM FROM SITE ONCE THEY ARE NO LONGER NEEDED.
- THE CONTRACTOR SHALL TAKE PRECAUTIONS AS TO NOT TRACK DEBRIS, DIRT AND MUD FROM THE SITE ONTO THE ADJACENT STREETS, ALLEY AND AREAS NOT WITHIN THE CONSTRUCTION SITE. ALL ADJACENT STREETS, ALLEYS AND AREAS SHALL BE SWEEP AND/OR CLEANED AS NEEDED OR AS DIRECTED BY THE OWNER.
- A CITY OF WICHITA FALLS APPROACH PERMIT IS REQUIRED FOR THE APPROACH AND THE SIDEWALK ALONG THE NORTH SIDE OF HAMPSHIRE LANE. THE APPROACH AND SIDEWALK SHALL BE INSTALLED PER CITY OF WICHITA FALLS STANDARDS AND WILL BE SUBJECT TO CITY INSPECTION AND APPROVAL. ALL WORK WITHIN CITY RIGHT-OF-WAY SHALL CONFORM TO THE STANDARD SPECIFICATIONS FOR PUBLIC WORKS CONSTRUCTION-NORTH CENTRAL TEXAS, LATEST EDITION, AS PUBLISHED BY THE NORTH CENTRAL TEXAS COUNCIL OF GOVERNMENTS. THE CITY PUBLIC WORKS DEPARTMENT SHALL BE NOTIFIED AT LEAST TWO (2) BUSINESS DAYS PRIOR TO WORK WITHIN THE CITY RIGHT-OF-WAY. ANY TRAFFIC SAFETY MEASURES USED WITHIN THE STREET RIGHT-OF-WAY TO PROTECT THE PUBLIC SHALL CONFORM TO THE REQUIREMENTS OF THE "MANUAL ON UNIFORM TRAFFIC CONTROL DEVICES".
- THE CONTRACTOR SHALL BE RESPONSIBLE FOR THE REMOVAL OF ANY EXCESS MATERIAL FROM THE SITE. THE CONTRACTOR SHALL REMOVE, LOAD, HAUL AND DISPOSE OF EXCESS MATERIAL OF AT AN OFF-SITE LOCATION, ONCE THE SITE HAS BEEN SUFFICIENTLY GRADED TO THE REQUIRED SUBGRADE DEPTH. THE SITE SHALL BE PROOF ROLLED WITH A LOADED DUMP TRUCK OR SIMILAR EQUIPMENT. ANY SOFT AREAS SHALL BE REMOVED, REWORKED AND RECOMPACTED TO ACHIEVE A MINIMUM OF 95% STANDARD PROCTOR DENSITY (ASTM D-698) AT 1 1/2" TO 3" ABOVE OPTIMUM MOISTURE.
- ALL CONCRETE STRENGTH SHALL BE A MINIMUM OF 3000 PSI AT 28 DAYS AND SHALL CONTAIN A MINIMUM OF 4% ENTRAINED AIR. THE CONTRACTOR SHALL TAKE CARE SO THAT THE MAXIMUM SLUMP DURING A POUR DOES NOT EXCEED 5-INCHES. ANY EXCESSIVELY WET CONCRETE LOADS WILL BE REJECTED. THE CONTRACTOR SHALL OBTAIN TWO SETS OF FOUR CYLINDERS FROM SEPARATE READY MIX TRUCKS FOR EACH MAJOR POUR. THESE CYLINDERS SHALL BE KEPT AT FIELD CONDITIONS AND SHALL BE BROKEN BY AN INDEPENDENT TESTING LAB AT 7, 14 AND 28 DAYS AT THE OWNER'S EXPENSE. THE RESULTS SHALL BE PROVIDED TO BOTH THE ENGINEER AND MWSU. TESTS MAY CEASE ON ANY SET OF CYLINDERS WHEN DESIGN STRENGTH HAS BEEN ACHIEVED. THE CONTRACTOR SHALL BE RESPONSIBLE FOR REMOVING AND REPLACING ANY CONCRETE NOT MEETING THE REQUIRED MINIMUM DESIGNED STRENGTH AT NO EXPENSE TO THE OWNER.
- CONCRETE SHALL BE PROTECTED FROM FREEZING FOR A MINIMUM OF 36 HOURS FOLLOWING ITS INITIAL SET AND SHALL NOT BE PLACED UNLESS THE TEMPERATURE IS AT LEAST 40 DEGREES FAHRENHEIT. ANY TRAFFIC SHALL BE KEPT OFF OF THE PAVEMENT FOR A MINIMUM OF 7 DAYS OR UNTIL APPROVED FOR TRAFFIC BY MWSU.
- ANY CONCRETE TRUCKS SHALL NOT BE WASHED OUT ON MWSU PROPERTY.
- REINFORCING SHALL BE GRADE 60 AND INSTALLED IN ACCORDANCE WITH ACI 330 LATEST EDITION AND SHALL BE FREE OF EXCESSIVE RUST, SCALE AND MUD. REINFORCING MATS SHALL BE SUPPORTED ON PLASTIC CHAIRS, NOT ON RODS DRIVING INTO THE GROUND. THE CONTRACTOR SHALL BE RESPONSIBLE FOR PROVIDING CARE DURING CONCRETE PLACEMENT TO INSURE THAT ANY REINFORCING MAINTAINS ITS PROPER POSITION IN THE PAVEMENT. CONCRETE TRUCKS SHALL NOT BE DRIVEN ACROSS REINFORCING MATS.
- PAVEMENT SURFACES SHALL HAVE A LIGHT BROOM FINISH.
- CONTRACTION JOINTS IN THE SIDEWALK SHALL BE TOOLED IN AS INDICATED ON THE DETAILS. CONTRACTION JOINTS IN THE PARKING LOT PAVING SHALL BE SAW CUT TO A DEPTH OF 3/4" WITHIN 24-HOURS AFTER THE CONCRETE HAS OBTAINED ITS INITIAL SET AT 15' ON CENTER EACH WAY. AFTER THE CONCRETE, HAS SET FOR A MINIMUM OF 14 DAYS, ALL JOINTS SHALL BE BLOWN CLEAN WITH COMPRESSED AIR AND SHALL BE SEALED WITH A 1/2" INCH BEAD OF SONOLASTIC S11, OR OTHER APPROVED SEALANT, TO WITHIN 1/4" OF THE FINISHED PAVEMENT SURFACE.
- EXPANSION JOINTS SHALL BE INSTALLED PER DETAILS AGAINST ANY EXISTING CONCRETE AND SHALL BE PLACED AT A MINIMUM OF 90' AND MAXIMUM OF 120' INTERVALS IN THE PARKING AREAS. EXPANSION JOINT MATERIAL SHALL BE SCORED OR SHALL HAVE A REMOVABLE PLASTIC CAP SO THAT THE UPPER 1/2" INCH CAN BE REMOVED TO ALLOW A SEALANT POCKET. EXPANSION JOINTS SHALL BE SEALED IN THE SAME MANNER AS MENTIONED ABOVE FOR CONTRACTION JOINTS. EXPANSION JOINTS SHALL BE LINED UP IN PARKING LOTS, CURB AND GUTTER AND SIDEWALK.
- CONSTRUCTION JOINTS SHALL BE DOWELED TOGETHER PER THE DETAILS. THE DOWELS MAY BE ELIMINATED IF THE STEEL IS LAID CONTINUOUSLY ACROSS THE JOINT.
- AFTER REMOVAL OF THE FORMS FOR CURBING, ALL VOIDS SHALL BE RUBBER FLOATED FULL WITH RICH CEMENT GROUT CONTAINING BONDING AGENT.
- THE CONTRACTOR SHALL BE RESPONSIBLE FOR THOROUGHLY PICKING UP AND RAKING THE SITE AND ALL DEBRIS REMOVED.
- THE CONTRACTOR SHALL HAVE THE SOLE RESPONSIBILITY FOR SAFETY ON THIS PROJECT. THE CONTRACTOR SHALL PROVIDE ALL NECESSARY AND PRUDENT BARRICADES, SIGNS, FENCING, WARNING LIGHTS, TRENCH SAFETY MEASURES AND DEVICES, WORK METHODS AND ALL OTHER SAFETY MEASURES NECESSARY TO PROTECT THE MWSU STUDENTS, FACULTY, STAFF, GENERAL PUBLIC AND CONTRACTOR EMPLOYEES. TRAFFIC SAFETY MEASURES SHALL BE USED WITHIN THE STREET RIGHT-OF-WAY TO PROTECT THE TRAVELING PUBLIC AND SHALL CONFORM TO THE REQUIREMENTS MEETING THE "MANUAL ON UNIFORM TRAFFIC CONTROL".

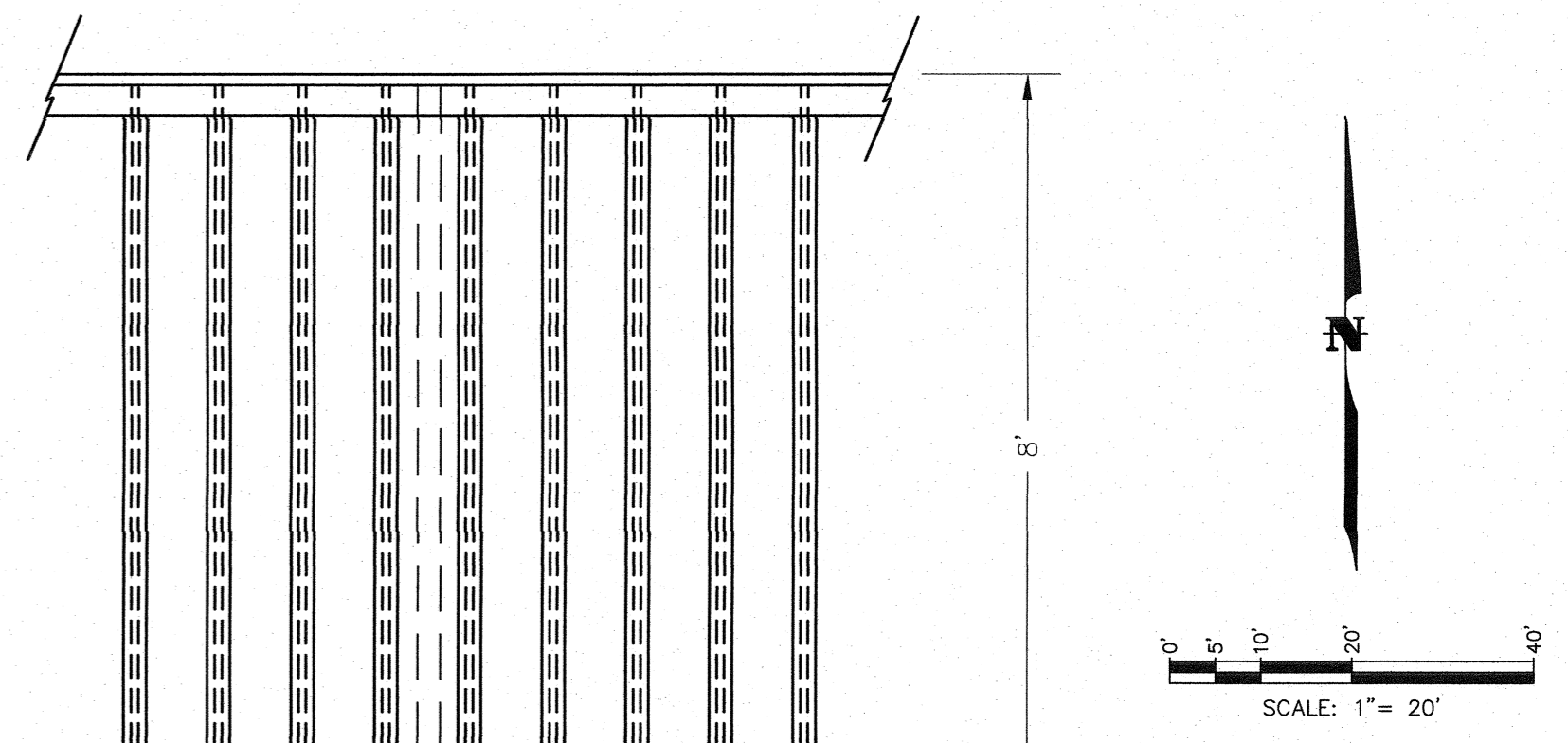
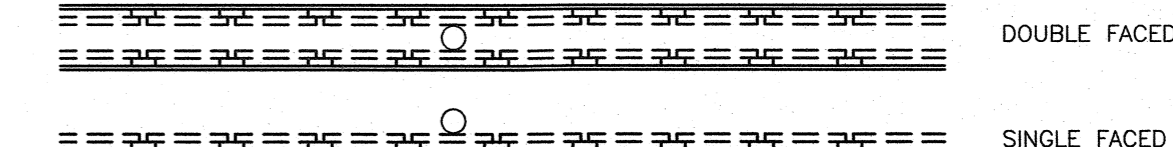
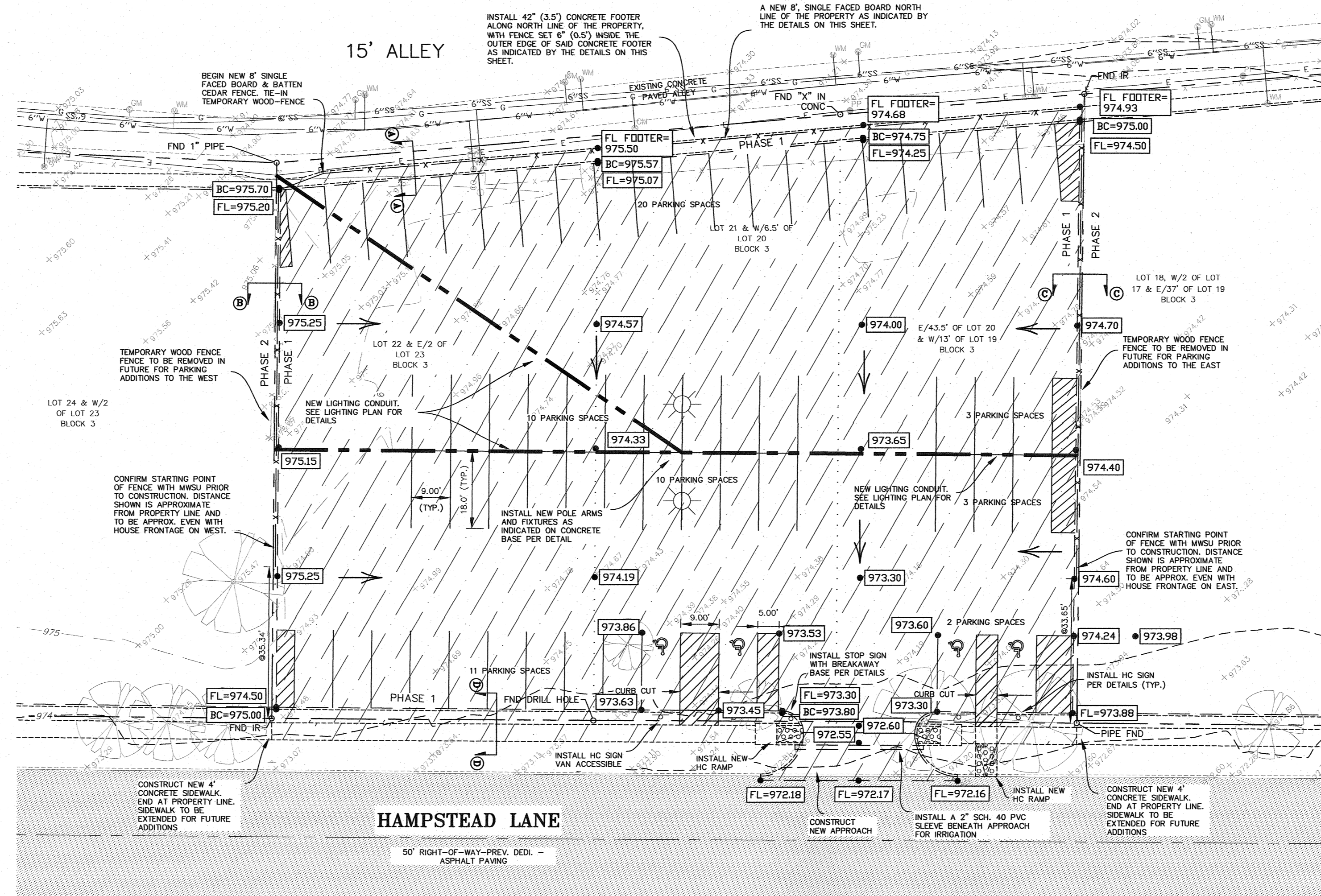

FENCING DETAIL  
NOT TO SCALE

- FENCE SHALL BE EITHER SINGLE FACED BOARD OR DOUBLE FACED BOARD. SEE PLAN VIEW.
- FENCE SHALL BE A CAPPED, BOARD & BATTEN CEDAR FENCE FACED ON NORTH SIDE. THE HEIGHT SHALL BE 8'.
- THERE SHALL BE AT LEAST THREE HORIZONTAL RAILS SUPPORTING THE FENCE. THESE SHALL BE 2" X 4" CEDAR. ALL FACING MATERIALS SHALL BE 1" X 8" X 8' #1 GRADE CEDAR. ALL NAILS USED SHALL BE GALVANIZED.
- SUPPORTING POSTS SHALL BE 3" O.D. SCHEDULE 40 GALVANIZED POSTS ON NO MORE THAN 8' CENTERS EMBEDDED A MINIMUM OF 24" INTO A 12" DIAMETER 3000 PSI CONCRETE FOOTING.
- CURBING BENEATH THE FENCE AND EXTENDING EAST TO THE BACK OF THE PARKING LOT CURB SHALL BE 4" MINIMUM THICKNESS 3000 PSI CONCRETE WITH #3 GRADE 40 REBAR AT 18" O.C.E.W. PROVIDE A LIGHT BROOM FINISH. THE PAVING WIDTH AS INDICATED ON PLANS.
- AFTER THE FENCE IS FULLY ASSEMBLED IT SHALL BE SEALED WITH CABOT 3005 PACIFIC REDWOOD STAIN APPLIED FULL STRENGTH TO ALL EXPOSED SIDES OF THE FENCE. (KELLY-MOORE OR LOWE'S)

TRIANGULAR SLIPBASE INSTALLATION GENERAL REQUIREMENTS

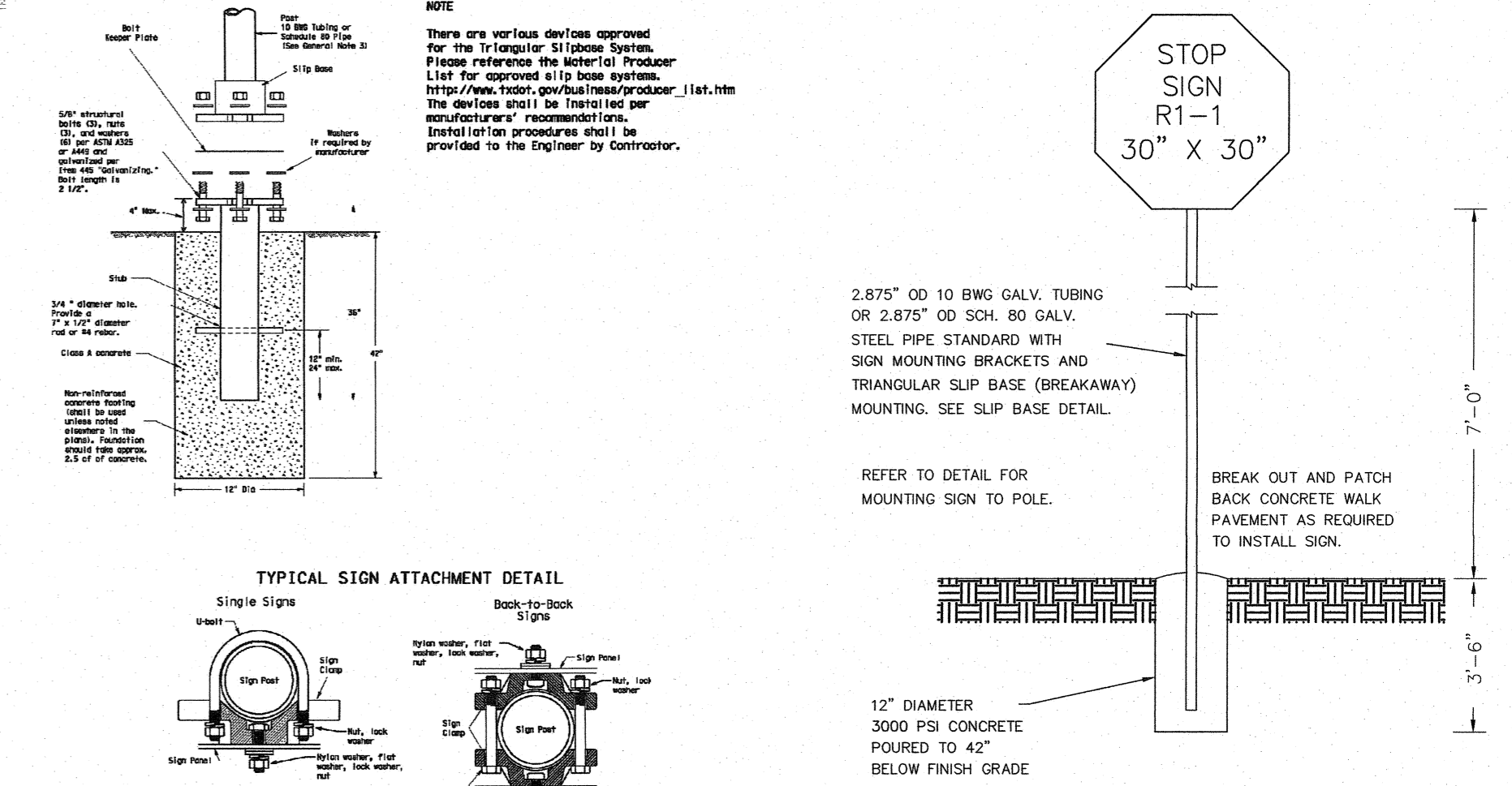

## STRIPING NOTES

- THE CONTRACTOR SHALL PROVIDE PARKING LOT STRIPING FOR PHASE 1 ONLY AND SHALL REFER TO THE PHASE 1 STRIPING AS SHOWN IN PLAN VIEW.
- THE CONCRETE SURFACE SHALL BE STRIPED SHALL BE BROOMED CLEAN AND/OR POWER WASHED TO REMOVE DEBRIS, DIRT AND MUD PRIOR TO PAINTING.
- THE SURFACES TO BE PAINTED SHALL BE THOROUGHLY DRY AND THE JOINT SEALANT SHALL BE FULLY CURED AND PAINTABLE. PPG OR SHERWIN-WILLIAMS TRAFFIC MARKING PAINT SHALL BE APPLIED IN ACCORDANCE WITH MANUFACTURER'S RECOMMENDATIONS.
- PARKING SPACE STRIPING SHALL BE 4 INCHES WIDE AND SHALL BE TRAFFIC SAFETY YELLOW. HANDICAP SPACES, INCLUDING STRIPING, CURB FACE AND SYMBOLS, SHALL BE SAFETY BLUE.
- THE CONCRETE BASE SHOWN IN LOT LIGHTING DETAILS IN PHASE 1 LIGHTING PLAN SHALL BE PAINTED TRAFFIC SAFETY YELLOW.
- ALL PAINTED AREAS SHALL BE PROTECTED FROM TRAFFIC UNTIL THOROUGHLY DRY AND ACCEPTED BY MWSU.

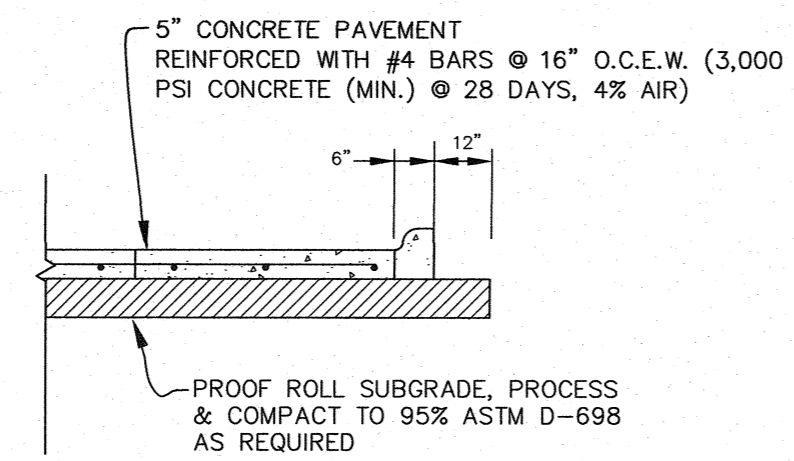

CONCRETE PAVING SECTION  
NOT TO SCALE

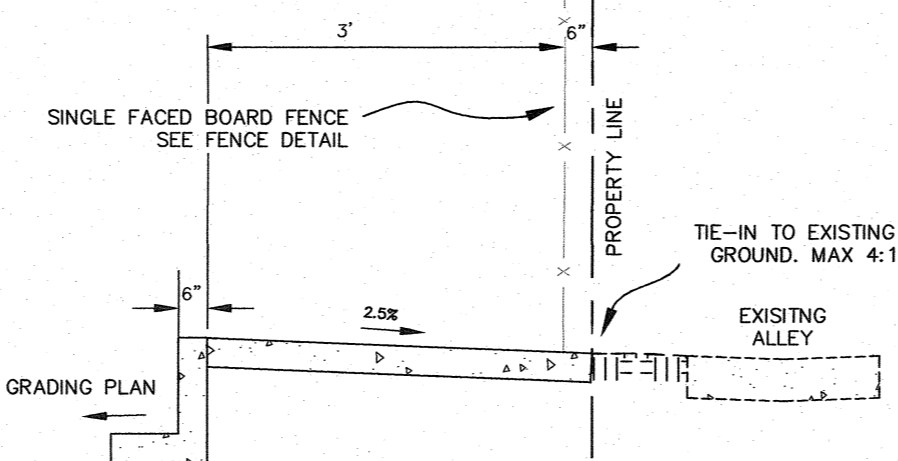

NORTH FENCE DETAIL  
SECTION A-A  
NOT TO SCALE

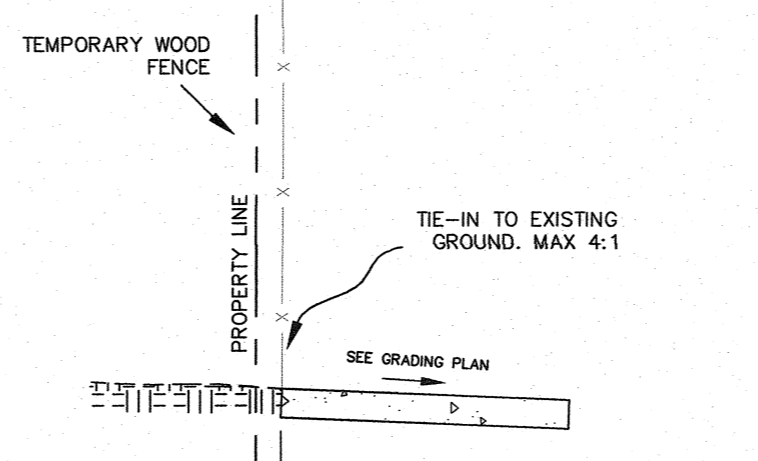

WEST FENCE DETAIL  
SECTION B-B  
NOT TO SCALE

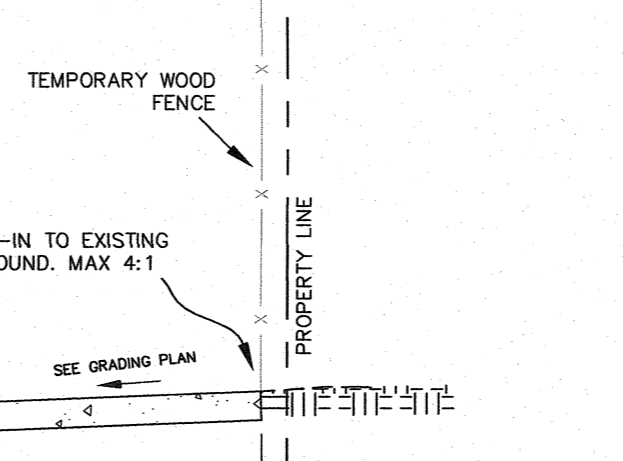

EAST FENCE DETAIL  
SECTION C-C  
NOT TO SCALE

## LEGEND

+	SIGN	6"SS	EXISTING 6" SANITARY SEWER LINE
PP	POWER POLE	6"V	EXISTING 6" WATER LINE
WM	WATER METER	---	GUY WIRE
GM	GAS METER	998.00	EXISTING SPOT ELEVATION
E	EXISTING ELECTRIC LINE	00.00	NEW SPOT ELEVATION
X	EXISTING FENCE	HC	HANDICAPPED PARKING SYMBOL
G	EXISTING 4" GAS LINE	CC	EXISTING CONCRETE
-990-	EXISTING INDEX CONTOUR	CC	PROPOSED CONCRETE
-989-	EXISTING INTERMEDIATE CONTOUR	FND IR	PROPERTY CORNER (AS NOTED)

## CAUTION!!! - UNDERGROUND UTILITIES!!!

EXISTING UTILITIES AND UNDERGROUND FACILITIES INDICATED ON THESE PLANS HAVE BEEN LOCATED APPROXIMATELY BY SIGHT OR FROM INFORMATION SUPPLIED BY THE VARIOUS OWNERS OF THE FACILITIES. THE ENGINEER AND OWNER DO NOT ACCEPT ANY RESPONSIBILITY FOR THE LOCATIONS SHOWN. IT SHALL BE THE SOLE RESPONSIBILITY OF THE CONTRACTOR TO VERIFY BOTH HORIZONTALLY AND VERTICALLY THE LOCATION OF ALL UTILITIES PRIOR TO CONSTRUCTION; TO TAKE NECESSARY PRECAUTIONS TO PROTECT ALL FACILITIES ENCOUNTERED; AND TO NOTIFY THE ENGINEER PROMPTLY OF ALL CONFLICTS WITH THE PROPOSED WORK. THE CONTRACTOR SHALL PRESERVE AND PROTECT ALL EXIST. UTILITIES AND FACILITIES FROM DAMAGE DURING CONSTRUCTION. ANY DAMAGE TO THESE FACILITIES BY THE CONTRACTOR SHALL BE REPAIRED BY THE CONTRACTOR AT HIS/HER SOLE EXPENSE. FACILITIES OWNED BY THE ENTITIES LISTED BELOW ARE KNOWN TO BE LOCATED ON OR IN CLOSE PROXIMITY TO THE WORK AREA OF THIS PROJECT. ADDITIONAL FACILITIES OWNED BY OTHERS MAY ALSO BE AFFECTED. CONTACT ALL POSSIBLE UTILITY AND UNDERGROUND FACILITY OWNERS.

- CITY OF WICHITA FALLS UTILITY OPERATIONS (940) 761-4333
- AT&T (940) 766-7217
- TEXAS DEPARTMENT OF TRANSPORTATION (940) 720-7709
- ONCOR ELECTRIC DELIVERY (940) 766-5460
- UNDERGROUND FACILITIES LOCATOR SERVICE (800) 344-8377
- ATMOS ENERGY (940) 696-7602

## SIDEWALK-PAVEMENT DETAIL SECTION D-D

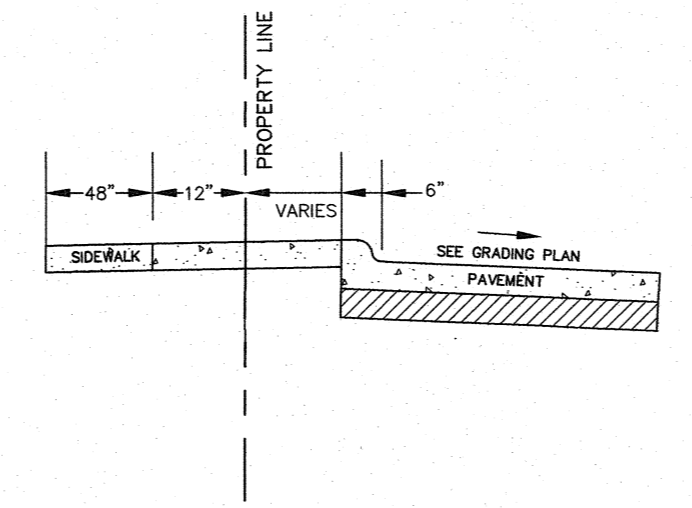

NOT TO SCALE



03/01/2017  
Michelle L. Wood  
REGISTERED PROFESSIONAL ENGINEER NO. 104860

## PHASE 1: GRADING & PAVING PLAN MIDWESTERN STATE UNIVERSITY PARKING LOT ADDITION PROJECT HAMPSHIRE LANE

CORLETT, PROBST & BOYD, P.L.L.C.  
ENGINEERS - SURVEYORS  
4605 OLD JACKSBORO HIGHWAY  
WICHITA FALLS, TEXAS 76302

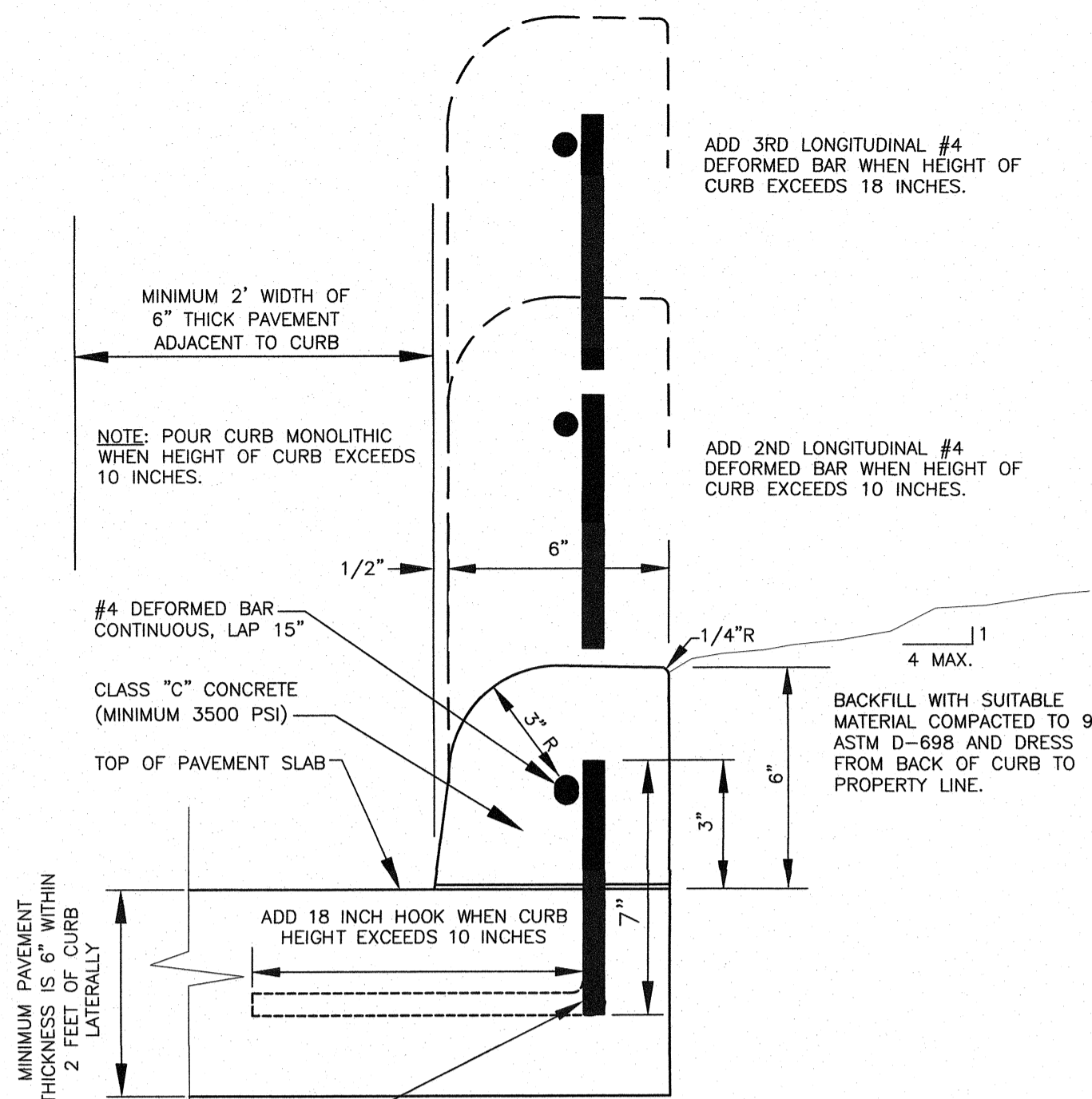

**DOWELED-ON CURB**  
NOT TO SCALE

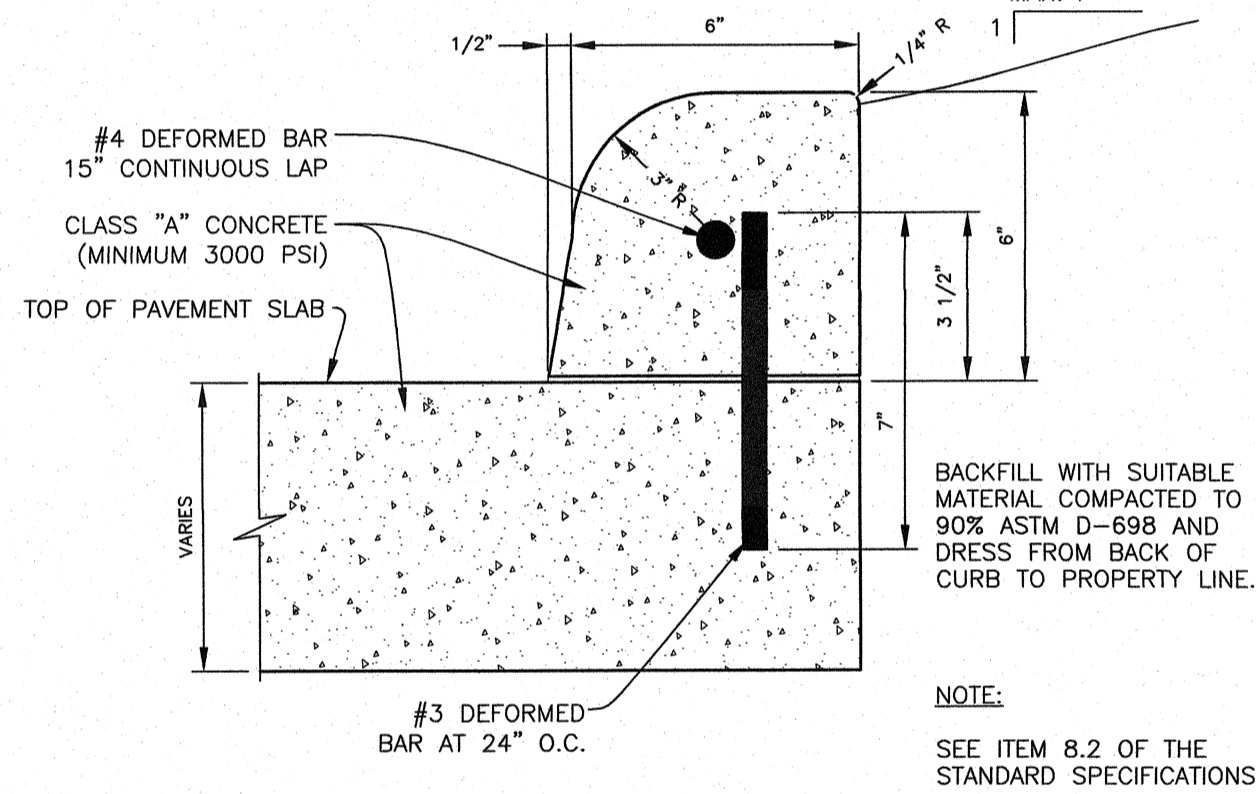

**DOWELED-ON CURB**  
NO SCALE

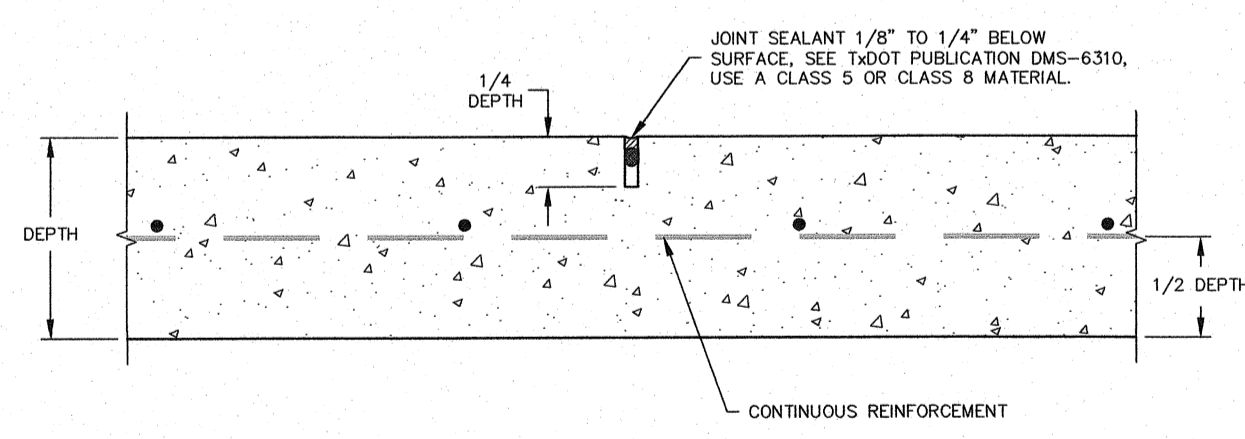

**SAWED CONTRACTION JOINT**  
NOT TO SCALE

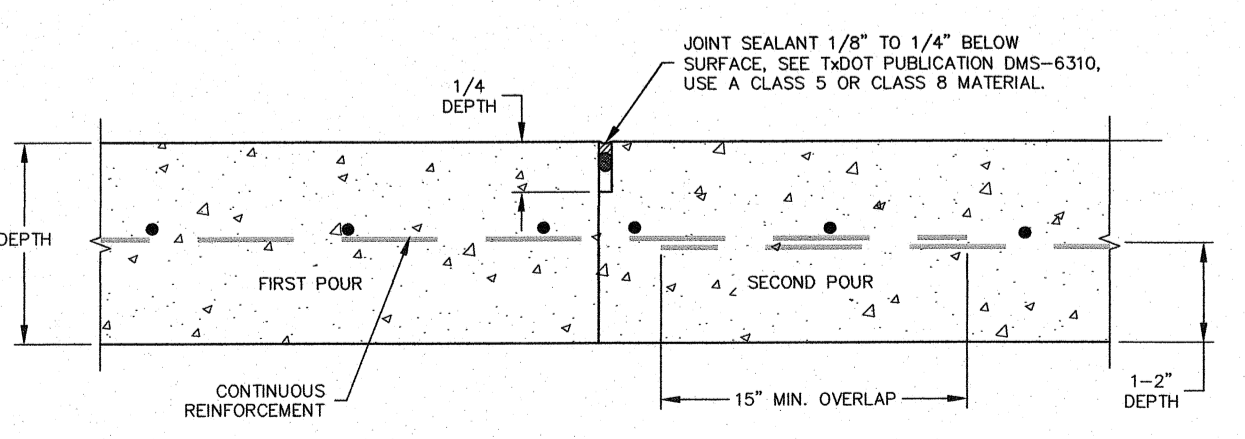

**CONSTRUCTION JOINT**  
NOT TO SCALE

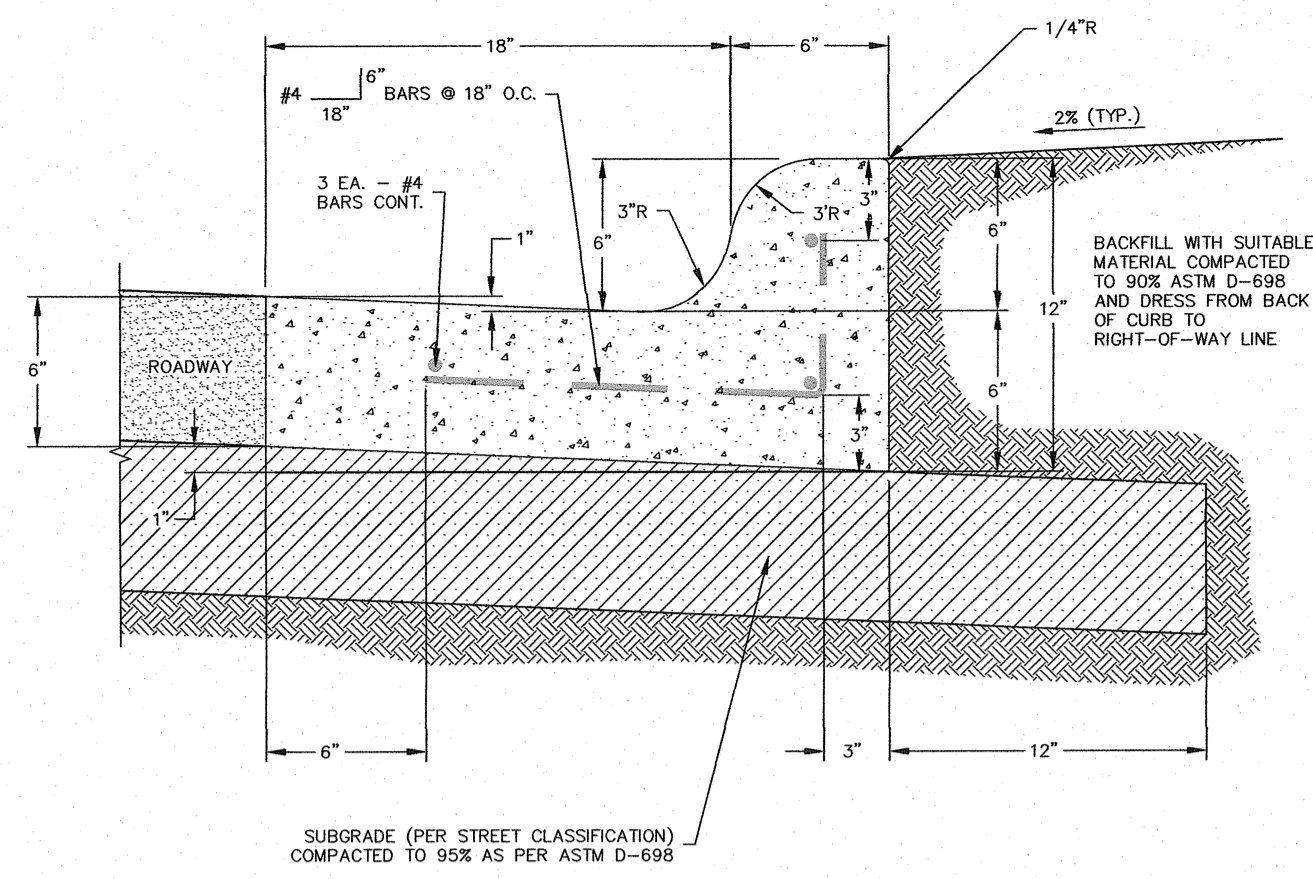

**6" CURB AND GUTTER**  
NOT TO SCALE

- GENERAL NOTES:**
1. DOWEL REINFORCEMENT 6" INTO EXISTING CURB AND GUTTER.
  2. CONSTRUCT 1/2" EXPANSION JOINTS AT 60" ON CENTER AND CONTRACTION JOINTS AT 15' ON CENTER.
  3. SEE CONCRETE CURB & GUTTER, ITEM 305.1 OF THE STANDARD SPECIFICATIONS.
  4. ALL CONCRETE SHALL BE CLASS "C" (COMPRESSIVE STRENGTH OF 3500 PSI @ 28 DAYS).
  5. SAND WILL NOT BE ACCEPTED AS COMPACTED SUBGRADE. SAND WILL BE ALLOWED FOR LEVEL-UP ONLY (2" MAX).
  6. MATCH PAVEMENT THICKNESS WHEN PLACED MONOLITHIC WITH CONCRETE PAVEMENT.
  7. PROVIDE 1" GUTTER DEPRESSION.

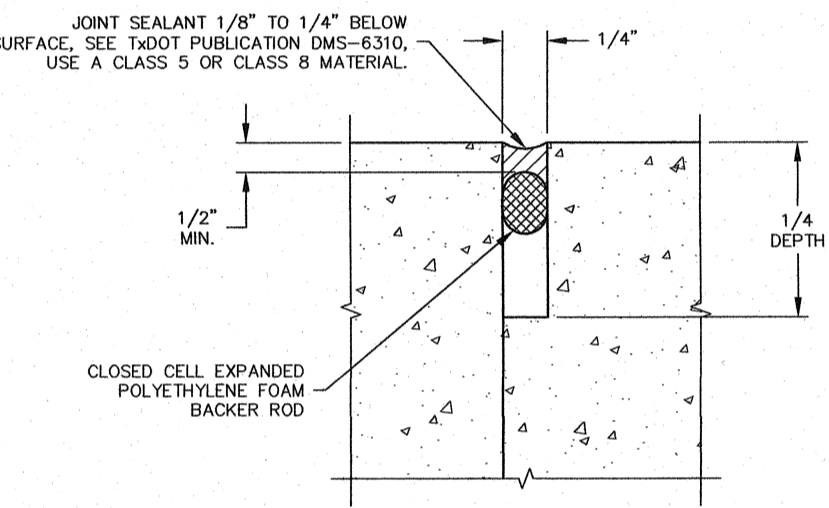

**JOINT SEALANT**

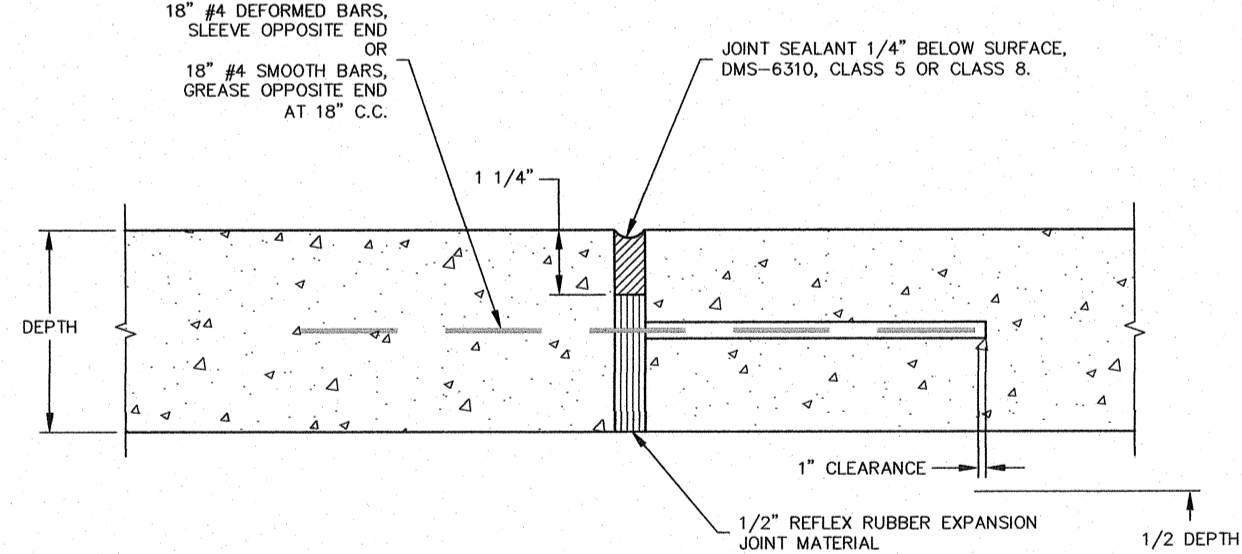

- GENERAL NOTES:**
1. SEE EXPANSION JOINTS, ITEM 303.5.4.2 OF THE STANDARD SPECIFICATIONS.
  2. DOWEL BARS MUST BE ADEQUATELY BRACED TO ASSURE THEY WILL BE MAINTAINED PERPENDICULAR TO JOINT DURING PLACEMENT OF CONCRETE.

**EXPANSION JOINT**  
NOT TO SCALE

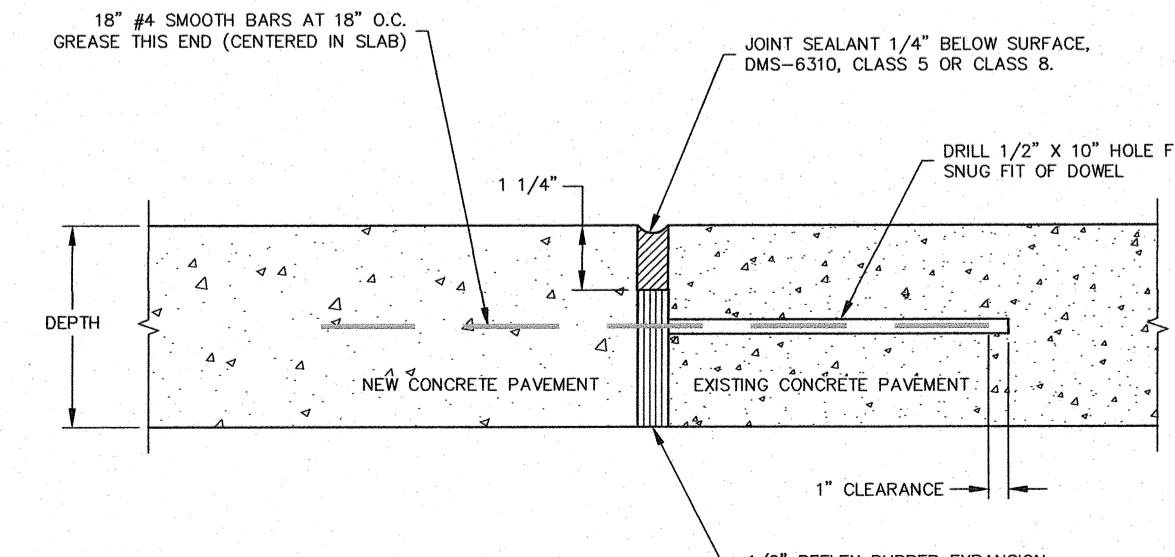

- GENERAL NOTES:**
1. SEE EXPANSION JOINTS, ITEM 303.5.4.2 OF THE STANDARD SPECIFICATIONS.

**EXISTING PAVEMENT TIE-IN JOINT**  
NOT TO SCALE

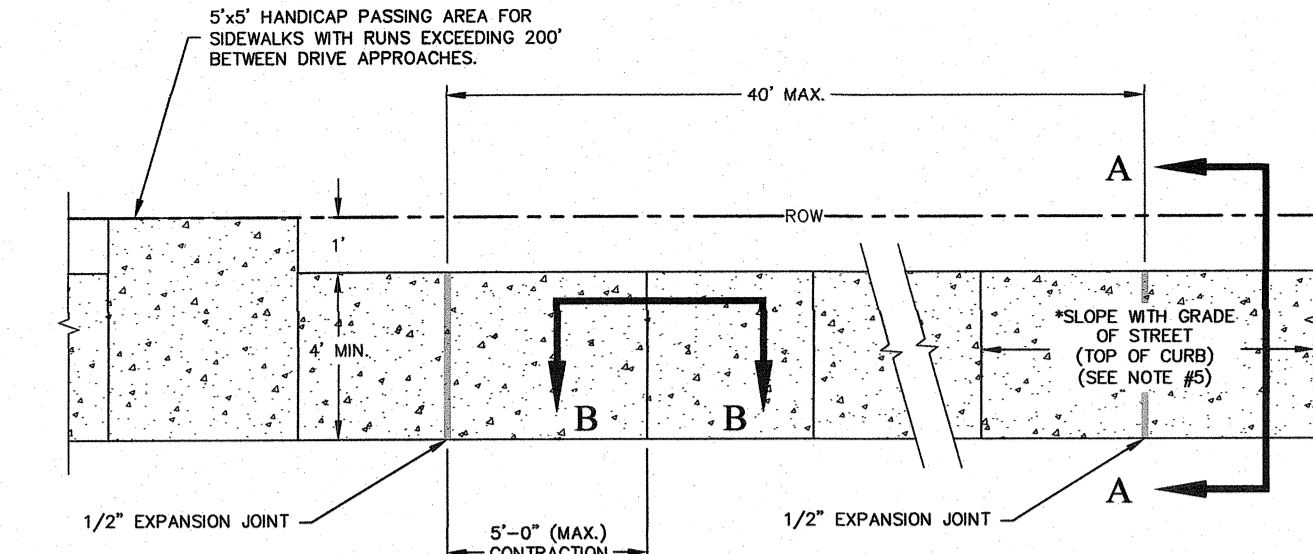

**SECTION A-A**

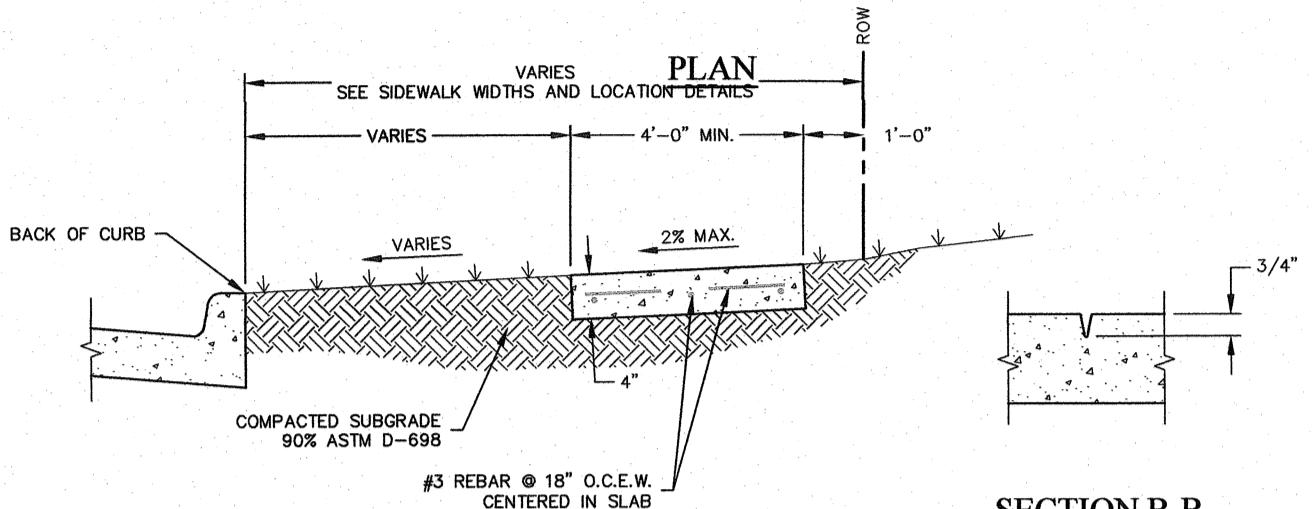

**SECTION B-B**  
CONTRACTION JOINT

- GENERAL NOTES:**
1. SIDEWALK REINFORCING (EXCLUDING DRIVE APPROACHES) SHALL BE #3 BARS @ 18" O.C.E.W. OR #4 BARS ON 24" O.C.
  2. ALL CONCRETE SHALL BE CLASS "A", (COMPRESSIVE STRENGTH OF 3,000 PSI @ 28 DAYS).
  3. SAND SHALL NOT BE ACCEPTED AS COMPACTED SUBGRADE. SAND WILL BE ALLOWED FOR LEVEL-UP ONLY.
  4. ANY UTILITY BOXES OR MANHOLES WITHIN THE SIDEWALK MUST BE ADJUSTED BY THE CITY UTILITY DEPARTMENT, OR OWNER OF UTILITY, TO BE FLUSH WITH FINISH GRADE, OR RELOCATED OUT OF THE SIDEWALK TO THE PROPER GRADE. ALL ADJUSTMENT COST WILL BE THE RESPONSIBILITY OF THE CONTRACTOR, OR THE OWNER INSTALLING THE SIDEWALK.
  5. CROSS SLOPE AT DRIVE APPROACHES AND RAMPS MUST COMPLY WITH ADA REQUIREMENTS. (1" INCH PER FOOT MAXIMUM)
  6. IF SIDEWALK IS PLACED ADJACENT TO CURB, MINIMUM WIDTH SHALL BE 6'.
  7. PLACE SIDEWALK 1' OFF ROW LINE. PROVIDE 5" MINIMUM WIDTH SIDEWALK IN COMMERCIAL AREAS WITH HEAVY PEDESTRIAN MOVEMENTS.
  8. SIDEWALKS INSTALLED WITHIN 1/2" RIGHT OF WAY SHALL BE A MINIMUM WIDTH OF 5' AND MEET REQUIREMENTS OF 1/2" PEDESTRIAN STANDARDS.

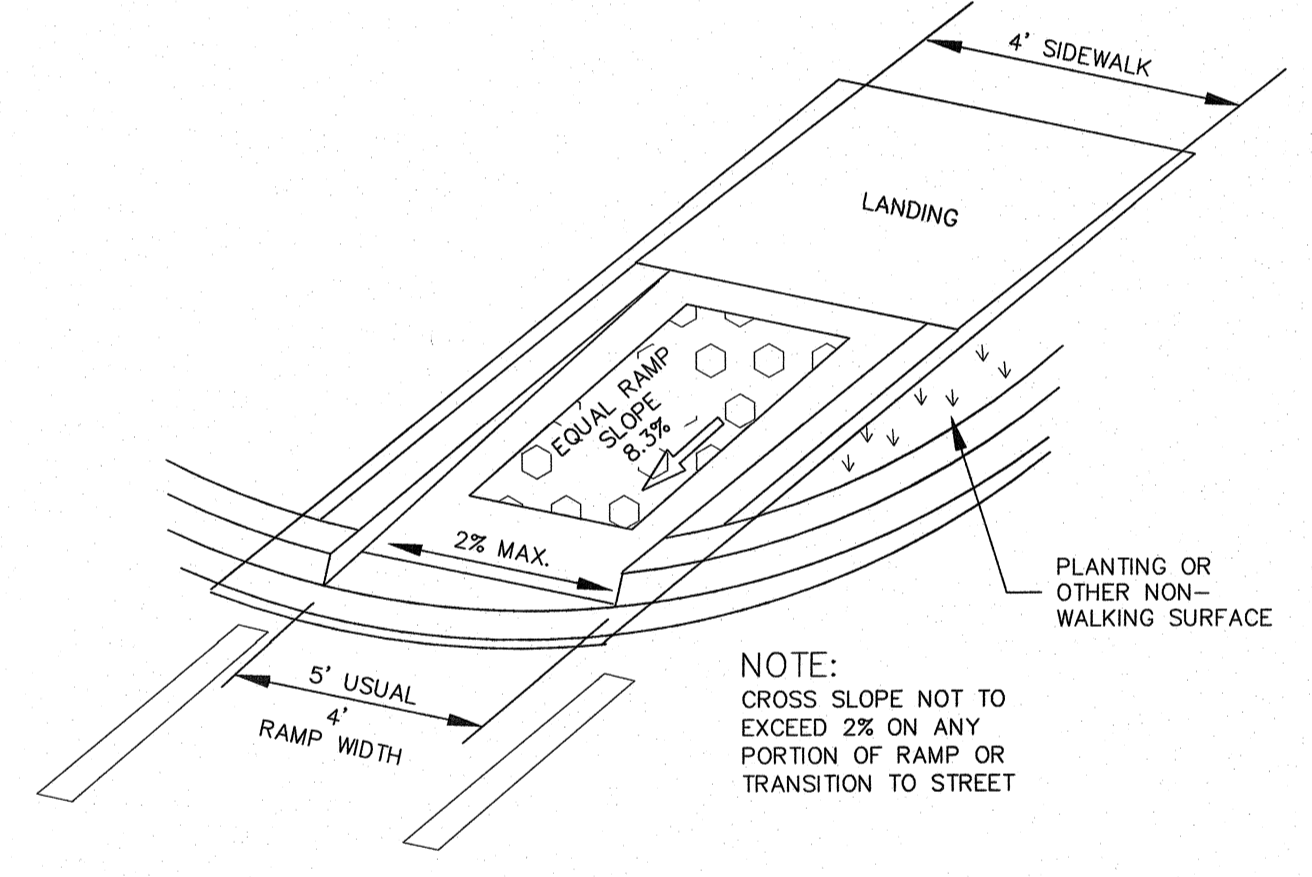

**TYPE 5 DIRECTIONAL RAMP WITHIN RADIUS**  
NO TO SCALE

**CURB RAMP GENERAL NOTES:**

1. INSTALL A CURB RAMP AT EACH PEDESTRIAN STREET CROSSING.
2. RAMP SHALL NOT BE STEEPER THAN 12:1 AND PAVEMENT COUNTER SLOPE SHALL NOT EXCEED 20:1 TOWARDS THE RAMP. ALL SLOPES SHOWN ARE MAXIMUM ALLOWABLE. LESSER SLOPES THAT WILL STILL DRAIN PROPERLY SHOULD BE USED. ADJUST CURB RAMP LENGTH OR GRADE OF APPROACH SIDEWALKS AS DIRECTED.
3. MAXIMUM ALLOWABLE CROSS SLOPE ON SIDEWALK AND CURB RAMP SURFACES IS 2%.
4. GUTTER FLOW LINE AND STREET PROFILE SHALL BE MAINTAINED THROUGH THE RAMP AREA WITH A SMOOTH TRANSITION BETWEEN RAMP AND STREET. ENSURE THAT POSITIVE DRAINAGE IS OBTAINED OFF LANDING AREA AND RAMP. CHANGES IN LEVEL GREATER THAN 1/4" ARE NOT PERMITTED.
5. PROVIDE FLARED SIDES WHERE THE PEDESTRIAN CIRCULATION PATH CROSSES THE CURB RAMP. FLARED SIDES SHALL BE SLOPED AT 10% MAXIMUM, MEASURED PARALLEL TO THE CURB. RETURNED CURBS MAY BE USED ONLY WHERE PEDESTRIANS WOULD NOT NORMALLY WALK ACROSS THE RAMP, EITHER BECAUSE THE ADJACENT SURFACE IS PLANTED, SUBSTANTIALLY OBSTRUCTED OR OTHERWISE PROTECTED.
6. LANDINGS SHALL BE 4' X 4' MINIMUM WITH A MAXIMUM 2% SLOPE IN ANY DIRECTION.
7. MANEUVERING SPACE AT THE BOTTOM OF THE CURB RAMPS SHALL BE A MINIMUM OF 4' X 4' WHOLLY CONTAINED WITHIN THE CROSSWALK AND WHOLLY OUTSIDE THE PARALLEL VEHICULAR TRAVEL PATH.
8. PLACE CONCRETE AT A MINIMUM DEPTH OF 5" FOR RAMPS, FLARES AND LANDINGS, UNLESS OTHERWISE DIRECTED. THE GUTTER PORTION OF THE RAMP IS MINIMUM 6" DEPTH OR MATCH ADJACENT PAVEMENT THICKNESS.
9. ALL CONCRETE SHALL BE CLASS "A" (COMPRESSIVE STRENGTH OF 3000 PSI @ 28 DAYS.)
10. RAMP AND LANDING AREA REINFORCING SHALL BE #3 BARS @ 18" O.C.E.W.
11. DETECTABLE WARNINGS SHALL CONSIST OF A CAST IN PLACE DETECTABLE WARNING SURFACE AS MANUFACTURED BY ARMOR-TILE, ADA SOLUTIONS OR APPROVED EQUAL. THE DETECTABLE WARNING SHALL BE BRICK RED UNLESS DIRECTED OTHERWISE BY THE ENGINEER OR A DESIGNATED REPRESENTATIVE. THE COLOR SHALL BE A HOMOGENEOUS PART OF THE DETECTABLE WARNING DEVICE.
12. DETECTABLE WARNING SURFACES SHALL BE A MINIMUM OF 24" IN DEPTH IN THE DIRECTION OF PEDESTRIAN TRAVEL, AND EXTEND THE FULL WIDTH OF THE CURB RAMP OR LANDING WHERE THE PEDESTRIAN ACCESS ROUTE ENTERS THE STREET.
13. DETECTABLE WARNING SURFACES SHALL BE LOCATED SO THAT THE EDGE NEAREST THE CURB LINE IS AT THE BACK OF THE CURB. ALIGN ROWS OF DOWELS TO BE PERPENDICULAR TO THE GRADE BREAK BETWEEN THE RAMP RUN AND THE STREET. DETECTABLE WARNING SURFACES MAY BE CURVED ALONG THE CORNER RADIUS.
14. PLACE UTILITY POLES, GROUND BOXES, METER BOXES, SIGNS, DRAINAGE FACILITIES AND OTHER ITEMS SO AS NOT TO OBSTRUCT THE PEDESTRIAN ACCESS ROUTE OR CLEAR GROUND SPACE.
15. RAMP LIMITS OF PAYMENT SHALL INCLUDE RAMP, LANDING, REQUIRED FLARES AND GUTTER ADJACENT TO RAMP AND FLARES.

**PEDESTRIAN FACILITIES CURB RAMP NOTES**

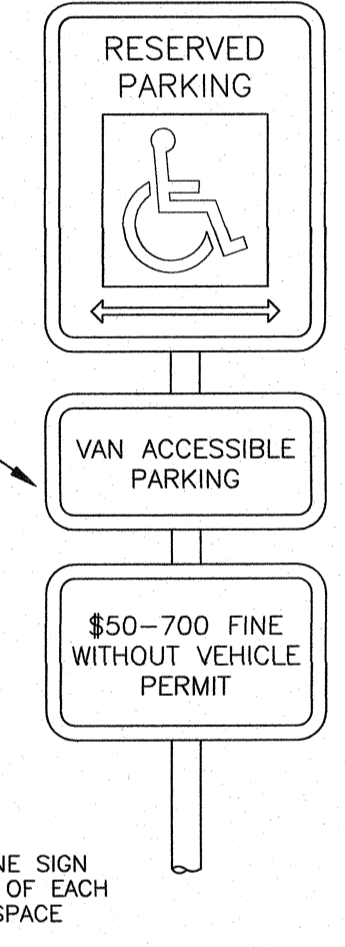

**HANDICAP SIGN DETAIL**  
NO TO SCALE

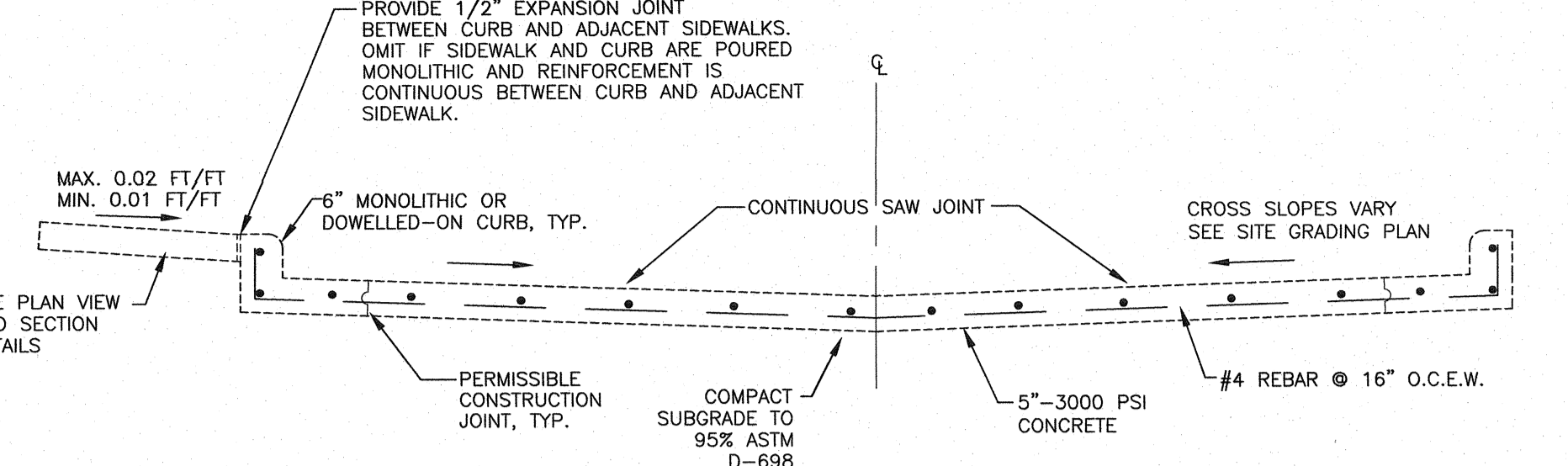

**TYPICAL CONCRETE PARKING SECTION**  
NO SCALE

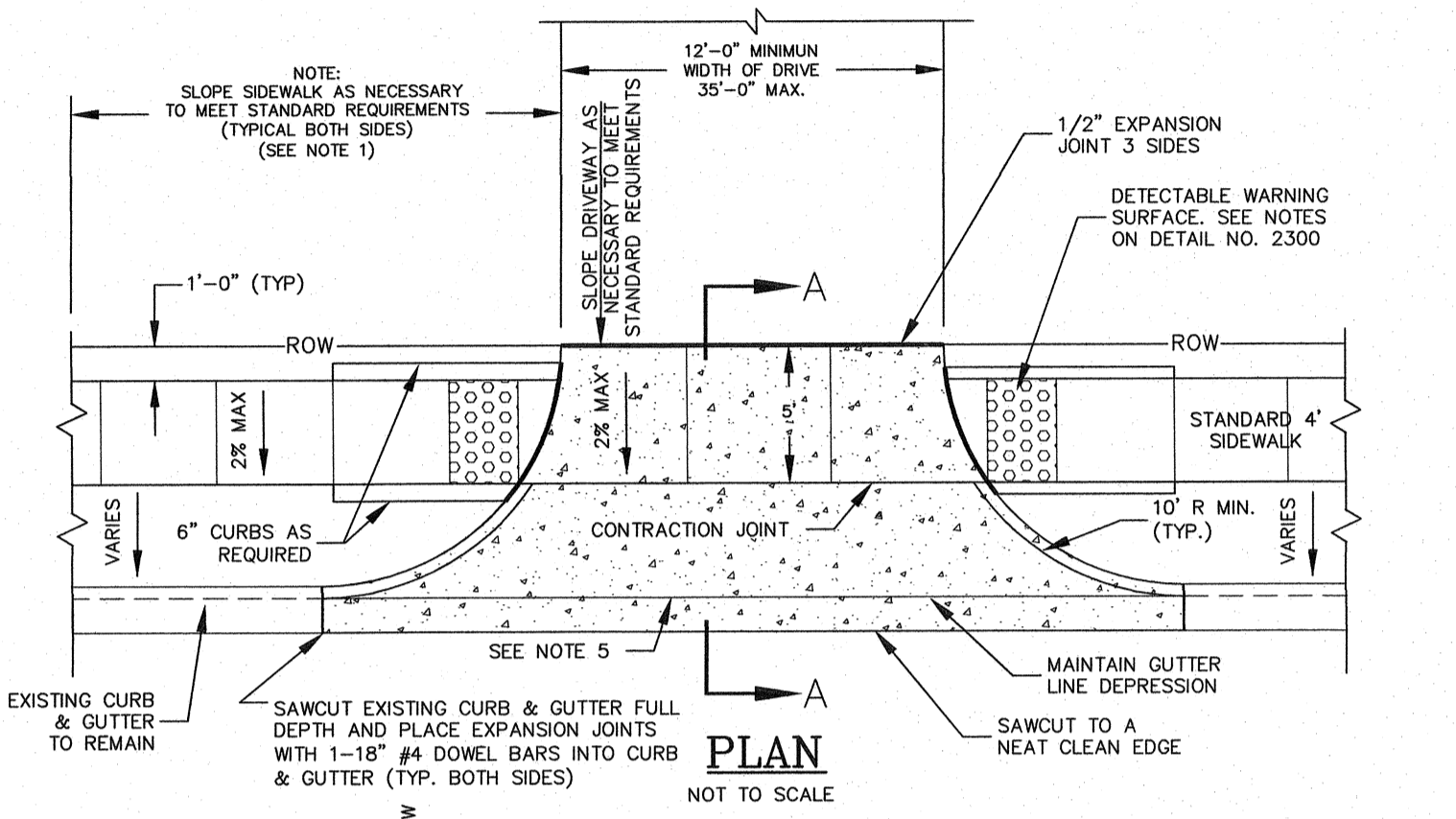

- GENERAL NOTES:**
1. SLOPE OF SIDEWALK AT DRIVE APPROACHES, AND DETECTABLE WARNING SURFACES MUST COMPLY WITH ADA REQUIREMENTS (1" PER FOOT MAXIMUM).
  2. SEE DRIVE APPROACHES, ITEM 305.2 OF THE STANDARD SPECIFICATIONS.
  3. ALL CONCRETE SHALL BE CLASS "C" (COMPRESSIVE STRENGTH OF 3000 PSI @ 28 DAYS)
  4. SAND SHALL NOT BE ACCEPTED AS COMPACTED SUBGRADE. SAND WILL BE ALLOWED FOR LEVEL-UP ONLY.
  5. ALL STEEL SHALL HAVE A 2" MINIMUM COVER.
  6. REBAR SHALL STOP 2" PRIOR TO EDGE OF EXISTING STREET.
  7. ANY UTILITY BOXES OR MANHOLES WITHIN THE APPROACH MUST BE ADJUSTED BY THE CITY UTILITY DEPARTMENT, OR THE OWNER OF UTILITY, TO BE FLUSH WITH FINISH GRADE, OR RELOCATED OUT OF THE APPROACH TO THE PROPER GRADE. ALL ADJUSTMENT COST WILL BE THE RESPONSIBILITY OF THE CONTRACTOR, OR THE OWNER INSTALLING THE APPROACH.

**COMMERCIAL DRIVE APPROACH ASPHALT STREET**  
NOT TO SCALE

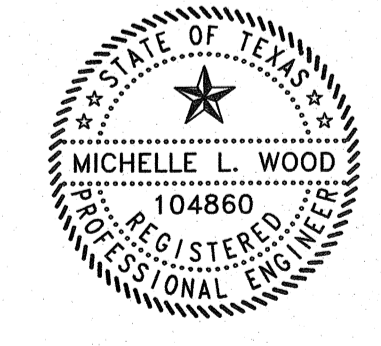

03/01/2017  
*Michelle L. Wood*  
MICHELLE L. WOOD  
REGISTERED PROFESSIONAL ENGINEER NO. 104860

**PHASE 1: PAVING DETAILS  
MIDWESTERN STATE UNIVERSITY  
PARKING LOT ADDITION PROJECT  
HAMPSTEAD LANE**

DRAWN	MWC	<b>CORLETT, PROBST &amp; BOYD, P.L.L.C.</b> ENGINEERS - SURVEYORS 4605 OLD JACKSBORO HIGHWAY WICHITA FALLS, TEXAS 76302
CHECKED	SLW	
APPROVED	SLW	
PHONE (940)723-1455 FAX (940)397-0549		
SCALE: 1" = 20'	MARCH, 2017	SHEET 4 OF 7

CONTRACTOR SHALL CONFIRM AND SHALL COORDINATE WITH ONCOR ELECTRIC FOR THE LOCATION FOR SERVICE. INSTALL NEW LOCKABLE NEMA 3R LIGHTING CONTROL DISCONNECT WITH AN INTERMATIC TIMER AND A PHOTOCELL TO CONTROL THE LIGHTS ON THE EXISTING SERVICE POLE IN THE ADJACENT ALLEY WHICH IS TO REMAIN. INSTALL CONDUIT FROM CONTROL PANEL TO LIGHTING LOCATIONS AS INDICATED. METALIC CONDUIT TO BE USED ABOVE GROUND AND PVC BELOW GROUND. LONG SWEEP ELBOWS SHALL BE USED AND PIPING SHALL BE BURIED AT LEAST 24" BELOW FINISHED GRADE. CONDUIT AND CONDUCTOR SHALL BE SIZED PER NEC FOR FIXTURES AND DISTANCES REQUIRED.

15' ALLEY

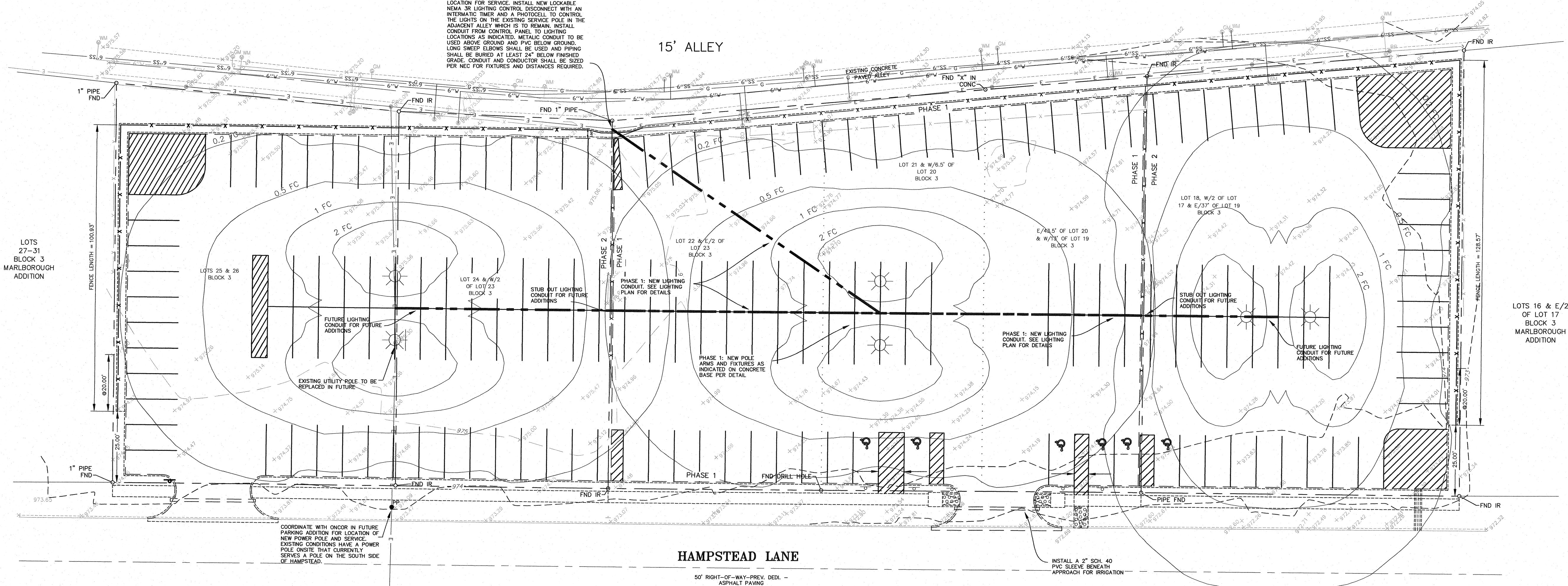

COORDINATE WITH ONCOR IN FUTURE PARKING ADDITION FOR LOCATION OF NEW POWER POLE AND SERVICE. EXISTING CONDITIONS HAVE A POWER POLE ON-SITE THAT CURRENTLY SERVES A POLE ON THE SOUTH SIDE OF HAMPSTEAD.

HAMPSTEAD LANE  
50' RIGHT-OF-WAY-PREV. DEED. - ASPHALT PAVING

LOUIS J. RODRIGUEZ DRIVE  
CONCRETE PAVING

**NOTE:**

THIS OVERALL CONCEPT LIGHTING PLAN HAS BEEN SHOWN FOR THE INTENT OF THE BUILD-OUT OF ALL SIX LOTS OWNED BY MWSU ON THE NORTH SIDE OF HAMPSTEAD LANE. MWSU INTENDS TO DEVELOP THE ENTIRE SIX LOTS AND CONSTRUCT A NEW PARKING LOT TO SERVE THE CAMPUS. THIS PROJECT WILL BE BUILT IN TWO SEPARATE PHASES. THESE PLANS ARE FOR THE CONSTRUCTION OF PHASE 1 ONLY (LOTS 22 THRU THE WEST 13' OF LOT 19, BLOCK 3, MARLBOROUGH ADDITION). THIS OVERALL CONCEPT LIGHTING PLAN IS FOR REFERENCE ONLY.

**CAUTION!!! - UNDERGROUND UTILITIES!!!**

EXISTING UTILITIES AND UNDERGROUND FACILITIES INDICATED ON THESE PLANS HAVE BEEN LOCATED APPROXIMATELY BY SIGHT OR FROM INFORMATION SUPPLIED BY THE VARIOUS OWNERS OF THE FACILITIES. THE ENGINEER AND OWNER DO NOT ACCEPT ANY RESPONSIBILITY FOR THE LOCATIONS SHOWN. IT SHALL BE THE SOLE RESPONSIBILITY OF THE CONTRACTOR TO VERIFY BOTH HORIZONTALLY AND VERTICALLY THE LOCATION OF ALL UTILITIES PRIOR TO CONSTRUCTION; TO TAKE NECESSARY PRECAUTIONS TO PROTECT ALL FACILITIES ENCOUNTERED; AND TO NOTIFY THE ENGINEER PROMPTLY OF ALL CONFLICTS WITH THE PROPOSED WORK. THE CONTRACTOR SHALL PRESERVE AND PROTECT ALL EXIST. UTILITIES AND FACILITIES FROM DAMAGE DURING CONSTRUCTION. ANY DAMAGE TO THESE FACILITIES BY THE CONTRACTOR SHALL BE REPAIRED BY THE CONTRACTOR AT HIS/HER SOLE EXPENSE. FACILITIES OWNED BY THE ENTITIES LISTED BELOW ARE KNOWN TO BE LOCATED ON OR IN CLOSE PROXIMITY TO THE WORK AREA OF THIS PROJECT. ADDITIONAL FACILITIES OWNED BY OTHERS MAY ALSO BE AFFECTED. CONTACT ALL POSSIBLE UTILITY AND UNDERGROUND FACILITY OWNERS.

- |  |                |
|--|----------------|
| CITY OF WICHITA FALLS UTILITY OPERATIONS | (940) 761-4333 |
| AT&T                                     | (940) 766-7217 |
| TEXAS DEPARTMENT OF TRANSPORTATION       | (940) 720-7709 |
| ONCOR ELECTRIC DELIVERY                  | (940) 766-5460 |
| UNDERGROUND FACILITIES LOCATOR SERVICE   | (800) 344-8377 |
| ATMOS ENERGY                             | (940) 696-7602 |

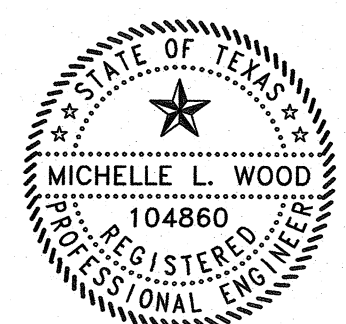

03/01/2017  
Michelle L. Wood  
REGISTERED PROFESSIONAL ENGINEER NO. 104860

**LEGEND**

- |         |                               |          |                                 |
|---------|-------------------------------|----------|---------------------------------|
| ⊠       | SIGN                          | — 6"SS — | EXISTING 6" SANITARY SEWER LINE |
| ●       | POWER POLE                    | — 6"W —  | EXISTING 6" WATER LINE          |
| ⊙       | WATER METER                   | — GUY —  | GUY WIRE                        |
| ⊙       | GAS METER                     | 998.00   | EXISTING SPOT ELEVATION         |
| — E —   | EXISTING ELECTRIC LINE        | 00.00    | NEW SPOT ELEVATION              |
| — X —   | EXISTING FENCE                | ♿        | HANDICAPPED PARKING SYMBOL      |
| — G —   | EXISTING 4" GAS LINE          | FND IR   | PROPERTY CORNER (AS NOTED)      |
| — 990 — | EXISTING INDEX CONTOUR        |          |                                 |
| — 989 — | EXISTING INTERMEDIATE CONTOUR |          |                                 |

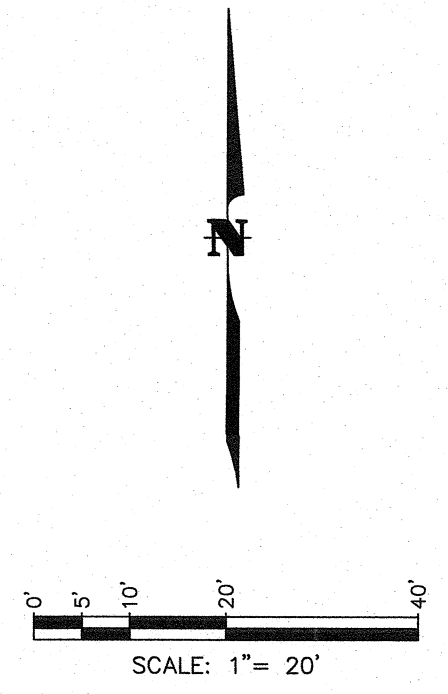

**OVERALL CONCEPT LIGHTING PLAN  
MIDWESTERN STATE UNIVERSITY  
PARKING LOT ADDITION PROJECT  
HAMPSTEAD LANE**

DRAWN	MWC	<b>CORLETT, PROBST &amp; BOYD, P.L.L.C.</b> ENGINEERS - SURVEYORS 4605 OLD JACKSBORO HIGHWAY WICHITA FALLS, TEXAS 76302 PHONE (940)723-1455 FAX (940)397-0549
CHECKED	SLW	
APPROVED	SLW	
MICHELLE L. WOOD REGISTERED PROFESSIONAL ENGINEER NO. 104860		

C:\MARK\2017\31735\31735.DWG 09/14/2017 1:42 PM C:\MARK

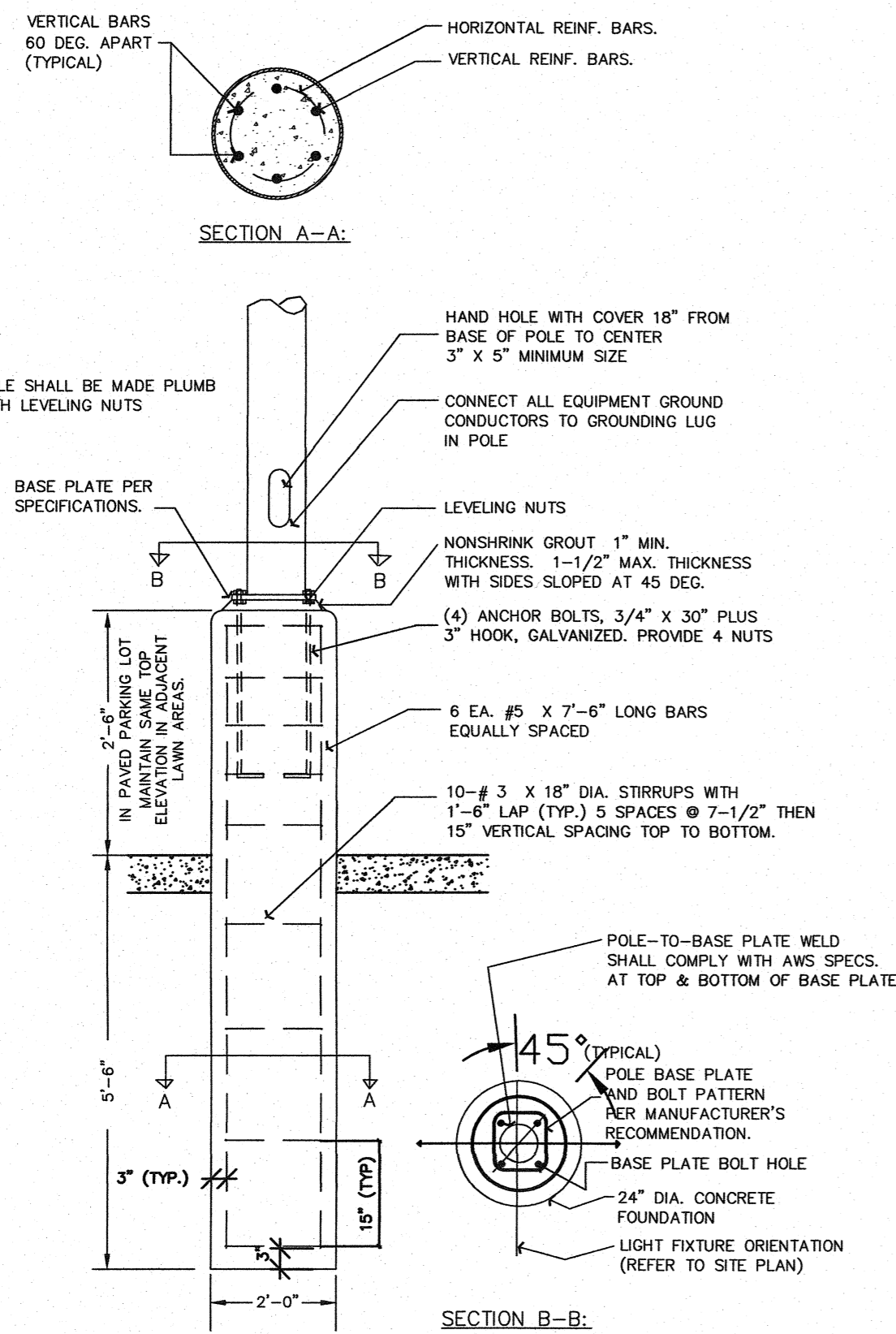

- NOTES:**
1. USE 3500 PSI MIN. 28 DAY COMPRESSIVE STRENGTH CONC. WITH GRADE 60 RE-BAR.
  2. IF WATER IS PRESENT IN HOLE, REMOVE BEFORE POURING CONCRETE.
  3. FOUNDATION EXCAVATION SHALL BE BY 24" AUGER IN UNDISTURBED SOIL. ALL LOOSE SOIL MATERIAL SHALL BE REMOVED PRIOR TO POURING CONCRETE.
  4. CONFIRM ACTUAL ANCHOR BOLT PATTERN AND DIMENSIONS WITH POLE MANUFACTURER'S DRAWINGS.

**LIGHT POLE FOUNDATION  
DETAIL**  
SCALE: NONE

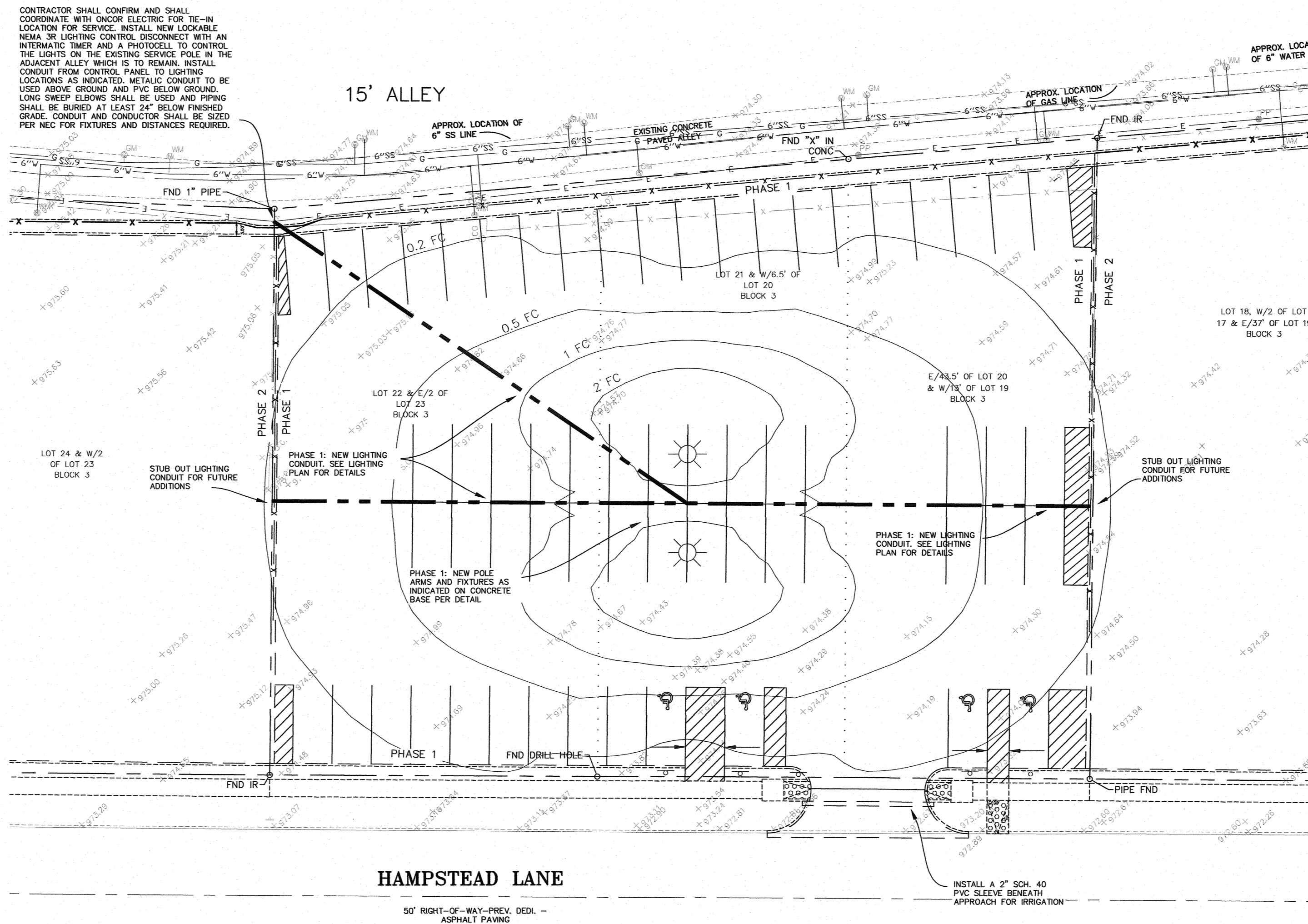

**PHASE 1 LIGHTING NOTES**

1. THE NEW PARKING LOT LIGHTS SHALL BE MOUNTED ON 24" DIAMETER CONCRETE FOUNDATIONS AS DESCRIBED ON DETAIL SHEET 6. THE PARKING LOT WILL BE BUILT IN TWO PHASES SO ONLY ONE LIGHT IS TO BE INSTALLED FOR PHASE 1. THE OTHER LIGHT POLES SHOWN IN PHASE 2 SHALL BE BUILT IN A FUTURE ADDITION TO THE PARKING LOT. ELECTRICAL CONDUIT SHALL BE PROVIDED TO THE EDGE OF PAVEMENT FOR THE PHASE 1 PARKING LOT DESIGN. THIS ELECTRICAL CONDUIT WILL BE EXTENDED FOR FUTURE ADDITIONS.
2. THE NEW LIGHT POLES SHALL BE KW INDUSTRIES RTS25-6.1-11-BRZ 185-BC (SINGLE ARM) AND KW INDUSTRIES RTS25-6.1-11-BRZ 285-BC (DOUBLE ARM AT 180°) MOUNTED TO THE CONCRETE FOUNDATIONS WITH GALVANIZED 3/4" X 30" LONG WITH 3" HOOK ANCHOR BOLTS. THE ANCHOR BOLTS SHALL BE DOUBLE-NUTTED TO PLUMB THE POLE. ONCE THE POLE HAS BEEN PLUMBED AND BOLTS TIGHTENED, THE SPACE BETWEEN THE BASE PLATE SHALL BE PACKED WITH NON-SHRINK, HIGH STRENGTH GROUT. POLE ARMS SHALL BE ORIENTED AS INDICATED ON THE PLAN.
3. THE NEW LIGHT FIXTURES SHALL BE GE EVOLVE LED MEDIUM COBRAHEAD ROADWAY LIGHT, ERMC-0-A3-60-A-4-GRAY, 208/1. PROVIDE A PHOTOCELL ON THE LIGHT STANDARD NEAREST THE SERVICE POLE. INSTALL SHORTING CAPS IN THOSE FIXTURES THAT ARE CONTROLLED BY A REMOTE PHOTOCELL.
4. BURIED 3/4" SCH. 40 PVC CONDUIT RUNS AND WIRING ARE REQUIRED TO MAKE THE CONNECTIONS. CONDUIT SHALL BE BURIED A MINIMUM OF 24" BELOW FINISH GRADE. USE LONG SWEEP ELBOWS TO BRING CONDUIT UP INTO LIGHT FOUNDATIONS. ALL WORK SHALL BE DONE BY A LICENSED ELECTRICIAN IN KEEPING WITH THE NATIONAL ELECTRIC CODE, LATEST EDITION.
5. ALL ELECTRICAL WORK SHALL BE COORDINATED THROUGH AND INSPECTED BY THE MWSU ELECTRICAL SUPERINTENDENT, DOUGLAS ALLISON (940) 397-4706.

**LEGEND**

— 6"V —	EXISTING 6" WATER LINE	— 6"SS —	EXISTING 6" SANITARY SEWER LINE
— 4"G —	EXISTING 4" GAS LINE	— 4" —	EXISTING ELECTRIC LINE
— 3" —	EXISTING FENCE	— 3" —	EXISTING SPOT ELEVATION
— 6" —	POWER POLE	— 00.00 —	NEW SPOT ELEVATION
— 6" —	WATER METER	FND IR	PROPERTY CORNER (AS NOTED)
— 6" —	EXISTING ELECTRIC LINE		
— 6" —	EXISTING FENCE		
— 6" —	EXISTING 4" GAS LINE		
— 6" —	EXISTING 6" SANITARY SEWER LINE		

**CAUTION!!! — UNDERGROUND UTILITIES!!!**

EXISTING UTILITIES AND UNDERGROUND FACILITIES INDICATED ON THESE PLANS HAVE BEEN LOCATED APPROXIMATELY BY SIGHT OR FROM INFORMATION SUPPLIED BY THE VARIOUS OWNERS OF THE FACILITIES. THE ENGINEER AND OWNER DO NOT ACCEPT ANY RESPONSIBILITY FOR THE LOCATIONS SHOWN. IT SHALL BE THE SOLE RESPONSIBILITY OF THE CONTRACTOR TO VERIFY BOTH HORIZONTALLY AND VERTICALLY THE LOCATION OF ALL UTILITIES PRIOR TO CONSTRUCTION; TO TAKE NECESSARY PRECAUTIONS TO PROTECT ALL FACILITIES ENCOUNTERED; AND TO NOTIFY THE ENGINEER PROMPTLY OF ALL CONFLICTS WITH THE PROPOSED WORK. THE CONTRACTOR SHALL PRESERVE AND PROTECT ALL EXIST. UTILITIES AND FACILITIES FROM DAMAGE DURING CONSTRUCTION. ANY DAMAGE TO THESE FACILITIES BY THE CONTRACTOR SHALL BE REPAIRED BY THE CONTRACTOR AT HIS/HER SOLE EXPENSE. FACILITIES OWNED BY THE ENTITIES LISTED BELOW ARE KNOWN TO BE LOCATED ON OR IN CLOSE PROXIMITY TO THE WORK AREA OF THIS PROJECT. ADDITIONAL FACILITIES OWNED BY OTHERS MAY ALSO BE AFFECTED. CONTACT ALL POSSIBLE UTILITY AND UNDERGROUND FACILITY OWNERS.

CITY OF WICHITA FALLS UTILITY OPERATIONS (940) 761-4333  
 AT&T (940) 766-7217  
 TEXAS DEPARTMENT OF TRANSPORTATION (940) 720-7709  
 ONCOR ELECTRIC DELIVERY (940) 766-5460  
 UNDERGROUND FACILITIES LOCATOR SERVICE (800) 344-8377  
 ATMOS ENERGY (940) 696-7602

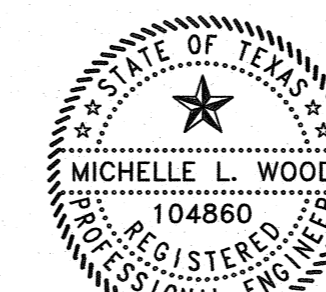

03/01/2017  
 Michelle L. Wood  
 REGISTERED PROFESSIONAL ENGINEER NO. 104860

**PHASE 1: LIGHTING PLAN**  
 MIDWESTERN STATE UNIVERSITY  
 PARKING LOT ADDITION PROJECT  
 HAMPSTEAD LANE

DRAWN: MWC  
 CHECKED: SLW  
 APPROVED: SLW

**CORLETT, PROBST & BOYD, P.L.L.C.**  
 ENGINEERS - SURVEYORS  
 4605 OLD JACKSBORO HIGHWAY  
 WICHITA FALLS, TEXAS 76302  
 PHONE (940) 723-1455  
 FAX (940) 397-0549

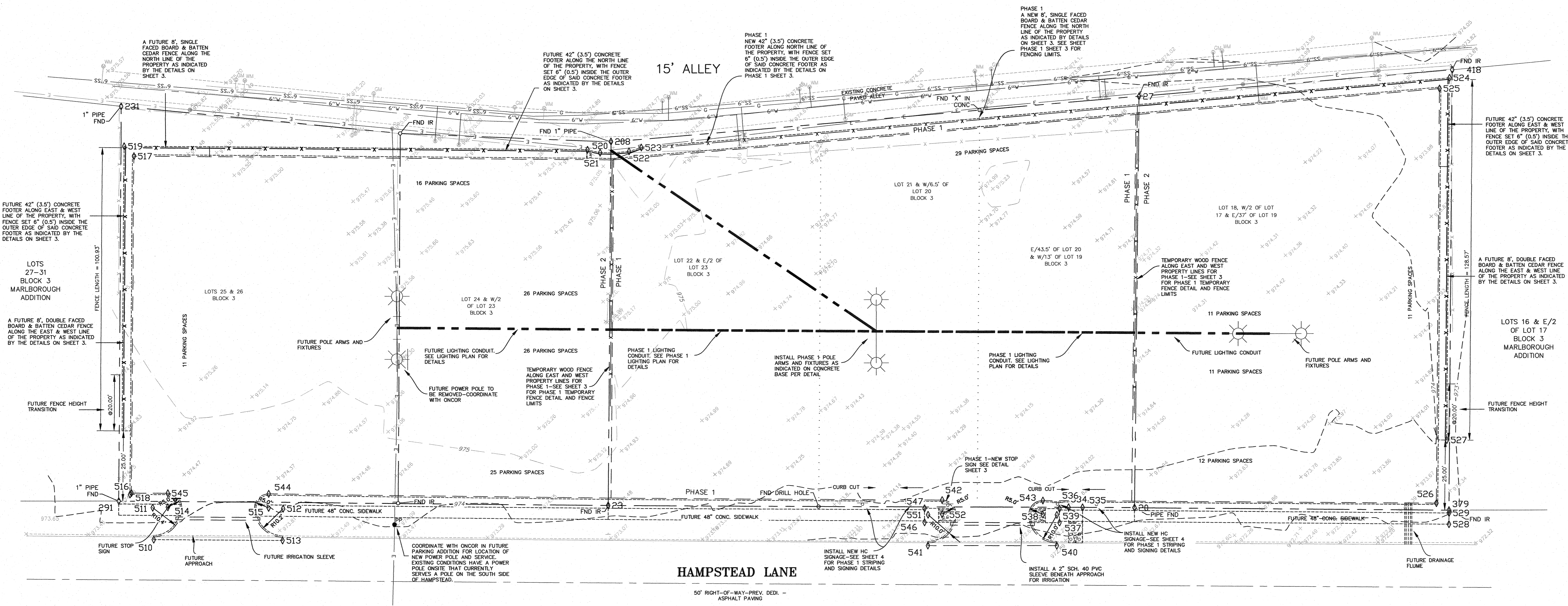

**CAUTION!!! - UNDERGROUND UTILITIES!!!**

EXISTING UTILITIES AND UNDERGROUND FACILITIES INDICATED ON THESE PLANS HAVE BEEN LOCATED APPROXIMATELY BY SIGHT OR FROM INFORMATION SUPPLIED BY THE VARIOUS OWNERS OF THE FACILITIES. THE ENGINEER AND OWNER DO NOT ACCEPT ANY RESPONSIBILITY FOR THE LOCATIONS SHOWN. IT SHALL BE THE SOLE RESPONSIBILITY OF THE CONTRACTOR TO VERIFY BOTH HORIZONTALLY AND VERTICALLY THE LOCATION OF ALL UTILITIES PRIOR TO CONSTRUCTION; TO TAKE NECESSARY PRECAUTIONS TO PROTECT ALL FACILITIES ENCOUNTERED; AND TO NOTIFY THE ENGINEER PROMPTLY OF ALL CONFLICTS WITH THE PROPOSED WORK. THE CONTRACTOR SHALL PRESERVE AND PROTECT ALL EXIST. UTILITIES AND FACILITIES FROM DAMAGE DURING CONSTRUCTION. ANY DAMAGE TO THESE FACILITIES BY THE CONTRACTOR SHALL BE REPAIRED BY THE CONTRACTOR AT HIS/HER SOLE EXPENSE. FACILITIES OWNED BY THE ENTITIES LISTED BELOW ARE KNOWN TO BE LOCATED ON OR IN CLOSE PROXIMITY TO THE WORK AREA OF THIS PROJECT. ADDITIONAL FACILITIES OWNED BY OTHERS MAY ALSO BE AFFECTED. CONTACT ALL POSSIBLE UTILITY AND UNDERGROUND FACILITY OWNERS.

- CITY OF WICHITA FALLS UTILITY OPERATIONS (940) 761-4333
- AT&T (940) 766-7217
- TEXAS DEPARTMENT OF TRANSPORTATION (940) 720-7709
- ONCOR ELECTRIC DELIVERY (940) 766-5460
- UNDERGROUND FACILITIES LOCATOR SERVICE (800) 344-8377
- ATMOS ENERGY (940) 696-7602

**LEGEND**

- PP SIGN
- PP POWER POLE
- WM WATER METER
- GM GAS METER
- E EXISTING ELECTRIC LINE
- X EXISTING FENCE
- G EXISTING 4" GAS LINE
- 990- EXISTING INDEX CONTOUR
- 989- EXISTING INTERMEDIATE CONTOUR
- 6"SS EXISTING 6" SANITARY SEWER LINE
- 6"W EXISTING 6" WATER LINE
- GUY WIRE
- 998.00 EXISTING SPOT ELEVATION
- 998.00 NEW SPOT ELEVATION
- Handicapped Parking Symbol
- FND IR PROPERTY CORNER (AS NOTED)

Point #	Raw Description	Northing	Easting
551	RAD PT	4997.6099	4926.2586
552	RAD PT	4997.8411	4931.2604
540	PI APP	4986.4572	4972.2325
541	PI APP	4986.6101	4926.1873
542	PI FL	5002.8410	4931.2960
543	PI FL	5002.5848	4967.2951
544	PI FL	5005.0515	4690.9005
545	PI FL	5005.3078	4654.9014
546	PI RAMP	4994.9156	4924.9984
547	PI RAMP	4999.9156	4925.0261
510	PI APP	4988.7714	4649.7859
511	RAD PNT	5000.1502	4649.4822
512	RAD PNT	4999.7495	4696.0480
513	PI APP	4988.4116	4695.7917
514	RAD	5000.3079	4654.8658
515	RAD	5000.0517	4690.8649
516	PI FL	5005.4003	4641.9017
517	PI FL	5125.3972	4642.7557
518	PI BC	5004.9039	4641.3981
519	PI BACK RUNNER	5128.9221	4639.2807

Point #	Raw Description	Northing	Easting
520	PI BACK RUNNER	5127.7442	4804.7765
521	PI BACK RUNNER	5126.7122	4809.2693
522	PI BACK RUNNER	5127.1877	4819.5837
523	PI BACK RUNNER	5128.5672	4823.9822
524	PI BACK RUNNER	5153.2077	5112.3376
525	PI FL	5149.3934	5108.8089
526	PI FL	5001.5855	5107.6983
527	PI BACK RUNNER	5024.0875	5111.3675
528	PI FC WALK	4994.0802	5112.1390
529	PI BACK WALK	4998.0800	5112.1718
534	PI RAMP	5000.1304	4976.4769
535	PI RAMP	5000.1027	4981.4768
536	PI RAMP	4999.6484	4973.2191
537	PI RAMP	4994.6485	4973.1914
538	RAD	4997.5849	4967.2595
539	RAD	4997.4572	4972.2587
379	FIR	4999.0800	5112.1800
418	FIR	5156.0960	5113.3120
208	1IN PIPE FND	5130.6920	4813.1700
231	1IN PIPE FND	5143.1440	4638.2720

Point #	Raw Description	Northing	Easting
291	1IN PIPE FND	5002.5090	4637.3810
23	FIR	5001.0410	4812.1910
20	PIPE FND INPUT	5000.0000	5000.0000
27	FIR	5146.6290	5001.5830

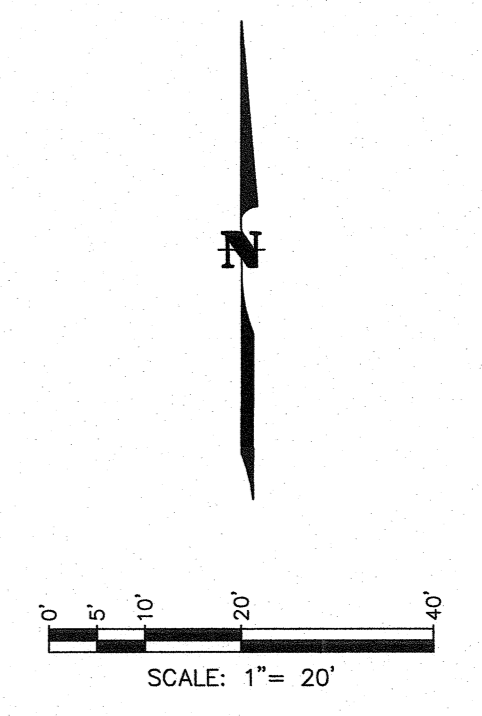

**DIMENSION CONTROL PLAN**  
**MIDWESTERN STATE UNIVERSITY**  
**PARKING LOT ADDITION PROJECT**  
**HAMPSTEAD LANE**

**CORLETT, PROBST & BOYD, P.L.L.C.**  
 ENGINEERS - SURVEYORS  
 4605 OLD JACKSBORO HIGHWAY  
 WICHITA FALLS, TEXAS 76302

SCALE: 1" = 20'      MARCH, 2017      SHEET 7 OF 7



03/01/2017  
*Michelle L. Wood*  
 MICHELLE L. WOOD  
 REGISTERED PROFESSIONAL ENGINEER NO. 104860