

**REQUEST FOR PROPOSAL  
MIDWESTERN STATE UNIVERSITY  
PURCHASING & CONTRACT MANAGEMENT DEPARTMENT  
3410 Taft Blvd., Daniel Bldg., Rm. 202  
Wichita Falls, TX. 76308**

BID NUMBER

BID TITLE

**735-17-8178**

**Hampstead Parking Lot Construction**

**BIDS WILL BE RECEIVED BY SEALED BID OR EMAIL UNTIL:**

**2:00 P.M.,**

**April 7, 2017:**

**at the office's of the Director of Purchasing & Contract Management,  
3410 Taft Blvd., Daniel Bldg., Rm. 202  
Wichita Falls, TX. 76308**

---

**GENERAL TERMS AND CONDITIONS**

These General Terms and Conditions apply to all offers made to Midwestern State University (herein after referred to as "University") by all prospective vendors (herein after referred to as "Bidders") on behalf of Solicitations including, but not limited to, Invitations to Bid and Request for Quotes.

**INSTRUCTIONS FOR SUBMITTING BIDS**

Review this document in its entirety. Be sure your bid is complete, and double check your bid for accuracy.

Questions requiring only clarification of instructions or specifications will be handled through the email process. If any questions results in a change or addition to this Bid, the change(s) and addition(s) will be addressed to all vendors involved as quickly as possible in the form of an addendum. It is the responsibility of the bidder to view the posting on the MSU purchasing web page located at <http://mwsu.edu/purchasing/>.

Sign the **Vendor's Affidavit Notice** and return with your bid.

**BIDDERS SHALL SUBMIT BID ON THE FORM PROVIDED, SIGN THE VENDOR AFFIDAVIT, AND RETURN ENTIRE BID PACKET.** In the event of inclement weather and the University Offices are officially closed on a bid opening day, bids will be received until 2:00 p.m. of the next business day. At which time said bids will be privately opened.

---

**BIDS SUBMITTED AFTER THE SUBMISSION DEADLINE SHALL BE RETURNED UNOPENED AND WILL BE CONSIDERED VOID AND UNACCEPTABLE.**

SUCCESSFUL VENDOR WILL BE NOTIFIED BY EMAIL OR MAIL. All responding vendors will receive written notification regarding the outcome of the award. Bid tabulations will be posted to the MSU Purchasing we page.

**PLEASE NOTE CAREFULLY**

**THIS IS THE ONLY APPROVED INSTRUCTION FOR THIS BID. ITEMS BELOW APPLY TO AND BECOME PART OF TERMS AND CONDITIONS OF BID. ANY EXCEPTIONS THERETO MUST BE IN WRITING.**

1. Each bid shall be emailed or placed in a separate envelope completely and properly identified with the name and number of bid. Bids must be in the Purchasing Office **BEFORE** the hour and date specified.
2. **QUOTE F.O.B. DESTINATION.** If otherwise, show exact cost to deliver. Bid unit price on quantity specified – extend and show total. In case of errors in extension, UNIT prices shall govern. Bids subject to unlimited price increase will not be considered.
3. Bids **MUST** give full firm name and address of the bidder. Failure to manually sign bid will disqualify it. Person signing bid should show TITLE or AUTHORITY TO BIND HIS FIRM IN A CONTRACT.
4. Bids **CANNOT** be altered or amended after opening time. Any alterations made before opening time must be initialed by bidder or his authorized agent. No bid can be withdrawn after opening without the approval by the Vice-President of Administration & Finance based on a written acceptable reason.
5. The University is exempt from State Sales Tax and Federal Excise Tax. **DO NOT INCLUDE TAX IN BID.**
6. Any catalog, brand name or manufacturer's reference used in a bid invitation is descriptive-**NOT** restrictive-it is to indicate type and quality desired unless otherwise indicated. Bids on brand of like nature and quality will be considered. If bid is based on other than referenced specifications, proposal must show manufacturer, brand or trade name, lot number, etc., of article offered. If other than brand(s) specified is offered, illustrations and complete description should be made part of the bid. If bidder takes no exception to specifications or reference data, he will be required to furnish brand names, numbers, etc., as specified.
7. Samples, when requested, must be furnished free of expense to the University. If not destroyed in examination, they will be returned to the bidder on request, at his

expense. Each sample should be marked with bidder's name, address, and University bid number. **DO NOT ENCLOSE OR ATTACH SAMPLE TO BID.**

8. **Delivery:** Bid must show number of days required to make delivery to place material in receiving agency's designated location under normal conditions. Failure to state delivery time obligates bidder to complete delivery in 14 calendar days. A five-day difference in delivery promise may break a tie. Unrealistically short or long delivery promises may cause bid to be disregarded. Consistent failure to meet delivery promises without valid reason may cause removal from bidder list. Delivery shall be made during normal working hours only, 8:00 a.m. to 5:00 p.m., unless prior approval for late delivery has been obtained from the Director of Purchasing.
9. If delay is foreseen, contractor shall give written notice to Director of Purchasing. The University has the right to extend delivery date if reasons appear valid. Contractor must keep University advised at all times of status of order. Default in promised delivery (without accepted reasons) or failure to meet specifications, authorizes the University to purchase supplies elsewhere and charge full increase in cost and handling to defaulting contractor.
10. All items proposed shall be new, in first class condition suitable for shipment and storage (Midwestern State University prefers recycled packaging whenever possible), unless otherwise indicated in bid. Verbal agreements to the University will not be recognized. All materials and services shall be subject to Purchaser's approval. Unsatisfactory materials will be returned at Seller's expense.
11. Written and verbal inquiries pertaining to bids must give Bid Number and Commodity.
12. No substitutions or cancellations permitted without written approval of Director of Purchasing.
13. The University reserves the right to accept or reject all or any part of any bid, waive minor technicalities and award to the Bidder that bids to the Best Value to the University. The University reserves the right to award by item or by total bid. Prices should be itemized.
14. Consistent and continued tie bidding could cause rejection of bids by the University and/or investigation for Anti-Trust violations.
15. The contractor agrees to protect the University from claims involving infringement of patents or copyrights.
16. This is a Quotation inquiry only and implies no obligation on the part of the University. All cost quotations must include all the various features needed to satisfy the requirements. Note: No amounts will be paid for the items in this BID in excess of the amounts quoted.

17. **Award:** A written purchase order or notice of award mailed or otherwise furnished to the successful bidder within the time of acceptance specified in this package results in a binding contract without further action by either party.
18. **Variation in Quantity:** The University assumes no liability for commodities produced, processed or shipped in excess of the amount specified herein.
19. **Invoicing:** Bidder shall submit two (2) copies of an itemized invoice showing bid number and purchase order number to:

**Midwestern State University  
Accounts Payable  
3410 Taft Blvd.  
Wichita Falls, TX. 76308**

20. **Payments:** The University, after receipt of completed order will make payment to the contractor within 30 days from the receipt of goods or invoice whichever is later. All partial shipment must be pre-approved by the Director of Purchasing. In the event of partial shipments the University is not required to make payments until the order is complete. Acceptance of and final payment for the item will be contingent upon satisfactory performance of the product received by the University.
21. **Discrimination:** In order to comply with the provisions of fair employment practices, the contractor agrees as follows; 1.) the contractor will not discriminate against any employee or applicant for employment because of race, sex, religion, handicap, or national origin; 2.) in all solicitations or advertisements for employees, the contractor will state that all qualified applicants will receive consideration without regard to race, color, sex, age, religion, handicap or national origin; 3.) the contractor will furnish such relevant information and reports as requested by the University for the purpose of determining compliance with these regulations; and 4.) failure of the contractor to comply with these laws will be deemed a breach of contract and it may be cancelled, terminated or suspended in whole or in part.
22. **Assignment:** Any contract entered into pursuant to this request is not assignable, nor the duties thereunder, by either party without the written consent of the other party in the contract.
23. **Other Remedies:** In addition to the remedies stated herein, the University has the right to pursue other remedies permitted by law or in equity.
24. **E-Verify:** Contractor is responsible to verify all employees are approved by The Homeland Security E-Verify program.



## REQUEST FOR PROPOSAL

### HAMPSTEAD PARKING LOT CONSTRUCTION MIDWESTERN STATE UNIVERSITY

It is the intent of these specifications to describe the minimum requirements for **the above titled project** at Midwestern State University in sufficient detail to secure comparable bids.

Each bidder must confirm he fully understands these specifications and the University's needs and satisfies himself that he is cognizant of all factors relating to requirements contained in these specifications.

The bid analysis will include compliance to bid specifications, past performance with vendor, references, delivery time, which will have a weighted average of 30 percent and the overall cost to the university, which will have a weighted average of 70 percent. Midwestern State University reserves the right to consider deviations from these specifications.

Award of this bid will be contingent on availability of Midwestern State University funds.

References shall be included on this bid form. Three current customers with a comparable purchase shall be listed with complete name, address, telephone number and contact person.

Bids must be submitted on this form and the bidder shall return the entire bid/specification package which will constitute a contract equally binding between the bidder and Midwestern State University if bids accepted by the University. Each bid shall be placed in a sealed envelope or emailed, signed by a person having the authority to bind his/her firm in a contract.

This contract shall remain in effect until completion and acceptance by the University. Midwestern State University reserves the right to enforce the performance of this contract in any manner prescribed by law or deemed to be in the best interest of the University in the event of breach or default of this contract. Midwestern State University reserves the right to terminate the contract immediately in the event the successful bidder fails to make delivery in accordance with the specifications.

**Questions** concerning these specifications should be directed via email no later than March 31, 2017 to:

Stephen Shelley, Director of Purchasing and Contract Management  
3410 Taft Blvd. Daniel Bldg. Rm. 202  
Wichita Falls, TX. 76308  
[stephen.shelley@mwsu.edu](mailto:stephen.shelley@mwsu.edu)  
(940) 397-4110

Midwestern State University may in its sole discretion respond in writing to questions concerning this bid request. Only MSU responses made by formal written addendum to this proposal shall be binding and shall be posted on the MSU purchasing web site located at <http://mwsu.edu/purchasing/>. Oral or other written interpretations or clarifications shall be without legal effect.

All bids meeting the intent of this invitation to bid will be considered for award. Bidders taking exception to the specifications, or offering substitutions, shall state these exceptions by attachment as part of the bid. The absence of such a list shall indicate that the bidder has not taken exception and shall hold the bidder responsible to perform in strict accordance with the specifications of the invitation. Midwestern State University reserves the right to accept any and all or none of the exception(s) / substitution(s) deemed to be in the best interest of the University.

**PRE-BID MEETING:** A **NON-MANDATORY** pre-bid meeting will be held at **10 a.m. on Tuesday, March 28, 2017 at 2508 Hampstead, Wichita Falls, Texas.**

**Proposals** are to be sent **via email** or hand delivered to:

Stephen Shelley, Director of Purchasing and Contract Management  
3410 Taft Blvd. Daniel Bldg. Rm. 202  
Wichita Falls, TX. 76308  
[stephen.shelley@mwsu.edu](mailto:stephen.shelley@mwsu.edu)  
(940) 397-4110

## **SPECIFICATIONS**

### **RFP #735-17-8178**

Please see specifications and drawing at the below Link under current bid opportunities listed under the RFP number:

<http://mwsu.edu/purchasing/>

Please supply a HUB Subcontracting Plan with your bid, which can be found at the below listed link: Bid will not be considered if not attached

<http://www.window.state.tx.us/procurement/prog/hub/hub-subcontracting-plan/>

Please supply schedule and lead time for project with bid: Contractor can begin construction on May 19, 2017.

Supply an insurance certificate with your Bid.

Supply a W-9 With your Bid if new to Midwestern State University.

2005 Uniform General Conditions apply to this Bid and can be found at the below listed link:

<http://mwsu.edu/purchasing/contract-management>

**Schedule: Construction can begin on May 19, 2017. Contractor schedules shall include weather day totals for Wichita Falls over the construction period. Substantial completion has to be achieved by 5:00 P.M. on August 18, 2017.**

**Liquidated Damages: Liquidated damages of Two Hundred and Fifty Dollars (\$250.00) per calendar day if Substantial Completion is not achieved by 5:00 PM on 8/18/17 at the latest.**

A Bid Bond is required to accompany your Bid submission.

A Payment Bond will be required if awarded the contract.

A Performance Bond will be required if awarded the contract.

**BID SHEET**  
**RFP #735-17-8178**  
**HAMPSTEAD PARKING LOT CONSTRUCTION**

**Base Bid:** \_\_\_\_\_

**Grand Total:** \_\_\_\_\_

**Printed Name:** \_\_\_\_\_

**Signature:** \_\_\_\_\_

**Company:** \_\_\_\_\_

**Address:** \_\_\_\_\_

**City and State:** \_\_\_\_\_

**Email Address:** \_\_\_\_\_

**Telephone:** \_\_\_\_\_

2017 PARKING LOT ADDITION PROJECT  
FOR  
MIDWESTERN STATE UNIVERSITY

3410 TAFT BOULEVARD  
WICHITA FALLS, TEXAS 76308

MARCH 2017



BOARD OF REGENTS

MR. WARREN AYRES	MR. JEFF GREGG
MS. TIFFANY BURKS	MS. NANCY MARKS, SECRETARY
MR. R. CAVEN CROSNOE, VICE CHAIRMAN	MR. SAMUEL M. SANCHEZ, CHAIRMAN
DR. F. LYNWOOD GIVENS, PH.D.	DR. SHELLEY SWEATT, ED.D.
MR. SHAWN HESSING	MS. LINDSEY SHELLEY, STUDENT REGENT

SUZANNE SHIPLEY, PH.D., PRESIDENT

MARILYN M. FOWLE, ED.D., V.P. ADMINISTRATION & FINANCE

KYLE C. OWEN, P.E., ASSOCIATE V.P. FACILITY SERVICES

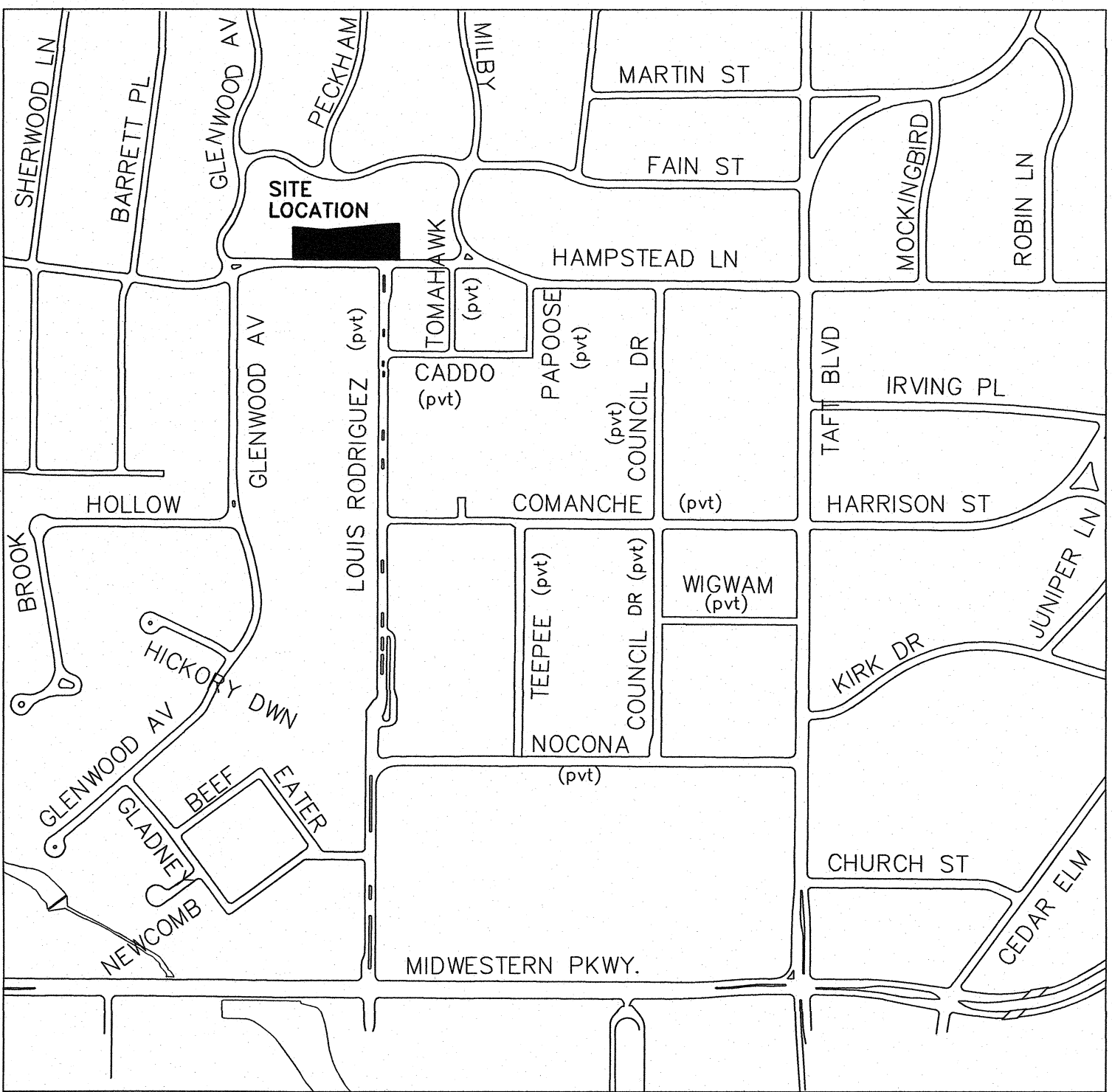

PROJECT AREA:

A NEW CONCRETE PARKING LOT TO BE CONSTRUCTED IN 2  
PHASES. ONLY PHASE 1 WILL BE CONSTRUCTED AS PART OF  
THIS PROJECT.



03/01/2017  
*Michelle L. Wood*  
MICHELLE L. WOOD  
REGISTERED PROFESSIONAL ENGINEER NO. 104860

PARKING LOT ADDITION PROJECT			
MIDWESTERN STATE UNIVERSITY			
HAMPSTEAD LANE			
DRAWN MWC		CORLETT, PROBST & BOYD, P.L.L.C. ENGINEERS – SURVEYORS 4605 OLD JACKSBORO HIGHWAY WICHITA FALLS, TEXAS 76302	
CHECKED SLW			
APPROVED SLW			
PHONE (840)723-1455 FAX (840)397-0549			
SCALE: 1" = 20'		MARCH, 2017	SHEET 1 OF 7



C:\MARK\2017\31735\31735.DWG (OVERLAPPED) P-3/1/2017 11:57 AM S-3/1/2017 11:56 AM C.M.

## LEGEND

+	SIGN	— 6"SS —	EXISTING 6" SANITARY SEWER LINE
PP	POWER POLE	— 6"W —	EXISTING 6" WATER LINE
WM	WATER METER	— GUY WIRE —	GUY WIRE
GM	GAS METER	— 998.00 —	EXISTING SPOT ELEVATION
— E —	EXISTING ELECTRIC LINE	— 00.00 —	NEW SPOT ELEVATION
— X —	EXISTING FENCE	— 00.00 —	HANDICAPPED PARKING SYMBOL
— G —	EXISTING 4" GAS LINE	— 00.00 —	EXISTING CONCRETE
— -990 —	EXISTING INDEX CONTOUR	— 00.00 —	PROPERTY CORNER (AS NOTED)
— -989 —	EXISTING INTERMEDIATE CONTOUR		

## NOTE:

THIS OVERALL CONCEPT PLAN HAS BEEN SHOWN FOR THE INTENT OF THE BUILD-OUT OF ALL SIX LOTS OWNED BY MWSU ON THE NORTH SIDE OF HAMPSTEAD LANE. MWSU INTENDS TO DEVELOP THE ENTIRE SIX LOTS AND CONSTRUCT A NEW PARKING LOT TO SERVE THE CAMPUS. THIS PROJECT WILL BE BUILT IN TWO SEPARATE PHASES. THESE PLANS ARE FOR THE CONSTRUCTION OF PHASE 1 ONLY (LOTS 22 THRU THE WEST 13' OF LOT 19, BLOCK 3, MARLBOROUGH ADDITION). THIS OVERALL CONCEPT PLAN IS FOR REFERENCE ONLY.

## CAUTION!!! — UNDERGROUND UTILITIES!!!

EXISTING UTILITIES AND UNDERGROUND FACILITIES INDICATED ON THESE PLANS HAVE BEEN LOCATED APPROXIMATELY BY SIGHT OR FROM INFORMATION SUPPLIED BY THE VARIOUS OWNERS OF THE FACILITIES. THE ENGINEER AND OWNER DO NOT ACCEPT ANY RESPONSIBILITY FOR THE LOCATIONS SHOWN. IT SHALL BE THE SOLE RESPONSIBILITY OF THE CONTRACTOR TO VERIFY BOTH HORIZONTALLY AND VERTICALLY THE LOCATION OF ALL UTILITIES PRIOR TO CONSTRUCTION; TO TAKE NECESSARY PRECAUTIONS TO PROTECT ALL FACILITIES ENCOUNTERED; AND TO NOTIFY THE ENGINEER PROMPTLY OF ALL CONFLICTS WITH THE PROPOSED WORK. THE CONTRACTOR SHALL PRESERVE AND PROTECT ALL EXIST. UTILITIES AND FACILITIES FROM DAMAGE DURING CONSTRUCTION. ANY DAMAGE TO THESE FACILITIES BY THE CONTRACTOR SHALL BE REPAIRED BY THE CONTRACTOR AT HIS/HER SOLE EXPENSE. FACILITIES OWNED BY THE ENTITIES LISTED BELOW ARE KNOWN TO BE LOCATED ON OR IN CLOSE PROXIMITY TO THE WORK AREA OF THIS PROJECT. ADDITIONAL FACILITIES OWNED BY OTHERS MAY ALSO BE AFFECTED. CONTACT ALL POSSIBLE UTILITY AND UNDERGROUND FACILITY OWNERS.

CITY OF WICHITA FALLS UTILITY OPERATIONS  
AT&T  
TEXAS DEPARTMENT OF TRANSPORTATION  
ONCOR ELECTRIC DELIVERY  
UNDERGROUND FACILITIES LOCATOR SERVICE  
ATMOS ENERGY

(940) 761-4333  
(940) 766-7217  
(940) 720-7709  
(940) 766-5460  
(800) 344-8377  
(940) 696-7602

LOUIS J.  
RODRIGUEZ DRIVE  
CONCRETE PAVING

## HATCH LEGEND

▨	PHASE 1—AREA TO BE CONSTRUCTED AS PART OF THIS PROJECT
▩	PHASE 2—AREA TO BE CONSTRUCTED IN FUTURE AND SHOWN FOR REFERENCE ONLY ON THIS SHEET

## PARKING TOTALS:

PHASE 1 = 59 TOTAL PARKING SPACES  
4 HANDICAP PARKING SPACES  
  
PHASE 2 = 119 TOTAL PARKING SPACES  
2 HANDICAP PARKING SPACES  
  
OVERALL TOTAL (PHASE 1 & PHASE 2) =  
  
178 PARKING SPACES  
6 HANDICAP PARKING SPACES

SCALE: 1" = 20'

## OVERALL CONCEPT SITE PLAN MIDWESTERN STATE UNIVERSITY PARKING LOT ADDITION PROJECT HAMPSTEAD LANE

DRAWN MWC  
CHECKED SLW  
APPROVED SLW

CORLETT, PROBST & BOYD, P.L.L.C.  
ENGINEERS — SURVEYORS  
4605 OLD JACKSBORO HIGHWAY  
WICHITA FALLS, TEXAS 76302  
PHONE (940) 723-1405  
FAX (940) 397-0549

SCALE: 1" = 20'

MARCH, 2017

SHEET 2 OF 7

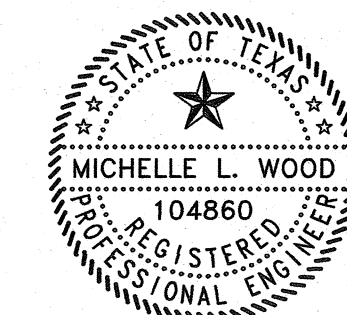

03/01/2017  
Michelle L. Wood  
MICHELLE L. WOOD  
REGISTERED PROFESSIONAL ENGINEER NO. 104860



## GENERAL NOTES FOR PAVING

1. THIS PARKING LOT WILL BE CONSTRUCTED IN TWO SEPARATE PHASES. THIS PROJECT IS FOR THE CONSTRUCTION OF PHASE 1 ONLY. PHASE 2 WILL BE CONSTRUCTED IN THE FUTURE AS A SEPARATE PROJECT.
2. DEMOLITION ITEMS FOR PHASE 1 ARE BEING DEMOLISHED BY A SEPARATE CONTRACT. EXISTING BUILDINGS, PAVEMENT, TREES, SHRUBS AND APPURTENANCES ARE BEING DEMOLISHED UNDER THIS SEPARATE CONTRACT. ANY REMAINING VEGETATIVE AND DELETERIOUS MATTER SHALL BE STRIPPED AND HAULED OFF-SITE TO AN OFF-SITE LOCATION BY THE CONTRACTOR.
3. THE CONTRACTOR SHALL PLACE TEMPORARY FENCING AND REASONABLE AND NECESSARY TRAFFIC CONTROL AND PROTECTIVE DEVICES AROUND THE CONSTRUCTION SITE. THE TRAFFIC CONTROL AND PROTECTIVE DEVICES SHALL DISCOURAGE VEHICULAR AND PEDESTRIAN TRAFFIC FROM ENTERING OR CROSSING THE SITE. THE CONTRACTOR SHALL BE RESPONSIBLE FOR MAINTAINING THE TEMPORARY FENCE AND TRAFFIC CONTROL DEVICES USED AS WELL AS REMOVING THEM FROM SITE ONCE THEY ARE NO LONGER NEEDED.
4. THE CONTRACTOR SHALL TAKE PRECAUTIONS AS TO NOT TRACK DEBRIS, DIRT AND MUD FROM THE SITE ONTO THE ADJACENT STREETS, ALLEY AND AREAS NOT WITHIN THE CONSTRUCTION SITE. ALL ADJACENT STREETS, ALLEYS AND AREAS SHALL BE SWEEP AND/OR CLEANED AS NEEDED OR AS DIRECTED BY THE OWNER.
5. A CITY OF WICHITA FALLS APPROACH PERMIT IS REQUIRED FOR THE APPROACH AND THE SIDEWALK ALONG THE NORTH SIDE OF HAMPSHIRE LANE. THE APPROACH AND SIDEWALK SHALL BE INSTALLED PER CITY OF WICHITA FALLS STANDARDS AND WILL BE SUBJECT TO CITY INSPECTION AND APPROVAL. ALL WORK WITHIN CITY RIGHT-OF-WAY SHALL CONFORM TO THE STANDARD SPECIFICATIONS FOR PUBLIC WORKS CONSTRUCTION-NORTH CENTRAL TEXAS, LATEST EDITION, AS PUBLISHED BY THE NORTH CENTRAL TEXAS COUNCIL OF GOVERNMENTS. THE CITY PUBLIC WORKS DEPARTMENT SHALL BE NOTIFIED AT LEAST TWO (2) BUSINESS DAYS PRIOR TO WORK WITHIN THE CITY RIGHT-OF-WAY. ANY TRAFFIC SAFETY MEASURES USED WITHIN THE STREET RIGHT-OF-WAY TO PROTECT THE PUBLIC SHALL CONFORM TO THE REQUIREMENTS OF THE "MANUAL ON UNIFORM TRAFFIC CONTROL DEVICES".
6. THE CONTRACTOR SHALL BE RESPONSIBLE FOR THE REMOVAL OF ANY EXCESS MATERIAL FROM THE SITE. THE CONTRACTOR SHALL REMOVE, LOAD, Haul, AND DISPOSE OF EXCESS MATERIAL OF AT AN OFF-SITE LOCATION. ONCE THE SITE HAS BEEN SUFFICIENTLY GRADED TO THE REQUIRED SUBGRADE DEPTH, THE SITE SHALL BE PROOF ROLLED WITH A LOADED DUMP TRUCK OR SIMILAR EQUIPMENT. ANY SOFT AREAS SHALL BE REMOVED, REWORKED AND RECOMPACTED TO ACHIEVE A MINIMUM OF 95% STANDARD PROCTOR DENSITY (ASTM D-698) AT 1%-3% ABOVE OPTIMUM MOISTURE.
7. ALL CONCRETE STRENGTH SHALL BE A MINIMUM OF 3000 PSI AT 28 DAYS AND SHALL CONTAIN A MINIMUM OF 4% ENTRAINED AIR. THE CONTRACTOR SHALL TAKE CARE SO THAT THE MAXIMUM SLUMP DURING A POUR DOES NOT EXCEED 5-INCHES. ANY EXCESSIVELY WET CONCRETE LOADS WILL BE REJECTED. THE CONTRACTOR SHALL OBTAIN TWO SETS OF FOUR CYLINDERS FROM SEPARATE READY MIX TRUCKS FOR EACH MAJOR POUR. THESE CYLINDERS SHALL BE KEPT AT FIELD CONDITIONS AND SHALL BE BROKEN BY AN INDEPENDENT TESTING LAB AT 7, 14 AND 28 DAYS AT THE OWNER'S EXPENSE. THE RESULTS SHALL BE PROVIDED TO BOTH THE ENGINEER AND MWSU. TESTS MAY CEASE ON ANY SET OF CYLINDERS WHEN DESIGN STRENGTH HAS BEEN ACHIEVED. THE CONTRACTOR SHALL BE RESPONSIBLE FOR REMOVING AND REPLACING ANY CONCRETE NOT MEETING THE REQUIRED MINIMUM DESIGNED STRENGTH AT NO EXPENSE TO THE OWNER.
8. CONCRETE SHALL BE PROTECTED FROM FREEZING FOR A MINIMUM OF 36 HOURS FOLLOWING ITS INITIAL SET AND SHALL NOT BE PLACED UNLESS THE TEMPERATURE IS AT LEAST 40 DEGREES FAHRENHEIT. ANY TRAFFIC SHALL BE KEPT OFF OF THE PAVEMENT FOR A MINIMUM OF 7 DAYS OR UNTIL APPROVED FOR TRAFFIC BY MWSU.
9. ANY CONCRETE TRUCKS SHALL NOT BE WASHED OUT ON MWSU PROPERTY.
10. REINFORCING SHALL BE GRADE 60 AND INSTALLED IN ACCORDANCE WITH ACI 330 LATEST EDITING AND SHALL BE FREE OF EXCESSIVE RUST, SCALE AND MUD. REINFORCING MATS SHALL BE SUPPORTED ON PLASTIC CHAIRS, NOT ON ROADS DRIVING INTO THE GROUND. THE CONTRACTOR SHALL BE RESPONSIBLE FOR PROVIDING CARE DURING CONCRETE PLACEMENT TO INSURE THAT ANY REINFORCING MAINTAINS ITS PROPER POSITION IN THE PAVEMENT. CONCRETE TRUCKS SHALL NOT BE DRIVEN ACROSS REINFORCING MATS.
11. PAVEMENT SURFACES SHALL HAVE A LIGHT BROOM FINISH.
12. CONTRACTION JOINTS IN THE SIDEWALK SHALL BE TOOLED IN AS INDICATED ON THE DETAILS. CONTRACTION JOINTS IN THE PARKING LOT PAVING SHALL BE SAW CUT TO A DEPTH OF 3/4" WITHIN 24-HOURS AFTER THE CONCRETE HAS OBTAINED ITS INITIAL SET AT 15' ON CENTER EACH WAY. AFTER THE CONCRETE HAS SET FOR A MINIMUM OF 14 DAYS, ALL JOINTS SHALL BE BLOWN CLEAN WITH COMPRESSED AIR AND SHALL BE SEALED WITH A 1/2 INCH BEAD OF SONOLASTIC SLI, OR OTHER APPROVED SEALANT, TO WITHIN 1/4 INCH OF THE FINISHED PAVEMENT SURFACE.
13. EXPANSION JOINTS SHALL BE INSTALLED PER DETAILS AGAINST ANY EXISTING CONCRETE AND SHALL BE PLACED AT A MINIMUM OF 90' AND MAXIMUM OF 120' INTERVALS IN THE PARKING AREAS. EXPANSION JOINT MATERIAL SHALL BE SCORED OR SHALL HAVE A REMOVABLE PLASTIC CAP SO THAT THE UPPER 1/2 INCH CAN BE REMOVED TO ALLOW A SEALANT POCKET. EXPANSION JOINTS SHALL BE SEALED IN THE SAME MANNER AS MENTIONED ABOVE FOR CONTRACTION JOINTS. EXPANSION JOINTS SHALL BE LINED UP IN PARKING LOTS, CURB AND GUTTER AND SIDEWALK.
14. CONSTRUCTION JOINTS SHALL BE DOWELED TOGETHER PER THE DETAILS. THE DOWELS MAY BE ELIMINATED IF THE STEEL IS LAID CONTINUOUSLY ACROSS THE JOINT.
15. AFTER REMOVAL OF THE FORMS FOR CURBING, ALL VOIDS SHALL BE RUBBER FLOATED FULL WITH RICH CEMENT GROUT CONTAINING BONDING AGENT.
16. THE CONTRACTOR SHALL BE RESPONSIBLE FOR THOROUGHLY PICKING UP AND RAKING THE SITE AND ALL DEBRIS REMOVED.
17. THE CONTRACTOR SHALL HAVE THE SOLE RESPONSIBILITY FOR SAFETY ON THIS PROJECT. THE CONTRACTOR SHALL PROVIDE ALL NECESSARY AND PRUDENT BARRICADES, SIGNS, FENCING, WARNING LIGHTS, TRENCH SAFETY MEASURES AND DEVICES, WORK METHODS AND ALL OTHER SAFETY MEASURES NECESSARY TO PROTECT THE MWSU STUDENTS, FACULTY, STAFF, GENERAL PUBLIC AND CONTRACTOR EMPLOYEES. TRAFFIC SAFETY MEASURES SHALL BE USED WITHIN THE STREET RIGHT-OF-WAY TO PROTECT THE TRAVELING PUBLIC AND SHALL CONFORM TO THE REQUIREMENTS MEETING THE "MANUAL ON UNIFORM TRAFFIC CONTROL".

## STRIPING NOTES

1. THE CONTRACTOR SHALL PROVIDE PARKING LOT STRIPING FOR PHASE 1 ONLY AND SHALL REFER TO THE PHASE 1 STRIPING AS SHOWN IN PLAN VIEW.
2. THE CONCRETE SURFACE SHALL BE STRIPED SHALL BE BROOMED CLEAN AND/OR POWER WASHED TO REMOVE DEBRIS, DIRT AND MUD PRIOR TO PAINTING.
3. THE SURFACES TO BE PAINTED SHALL BE THOROUGHLY DRY AND THE JOINT SEALANT SHALL BE FULLY CURED AND PAINTABLE. PPG OR SHERWIN-WILLIAMS TRAFFIC MARKING PAINT SHALL BE APPLIED IN ACCORDANCE WITH MANUFACTURER'S RECOMMENDATIONS.
4. PARKING SPACE STRIPING SHALL BE 4 INCHES WIDE AND SHALL BE TRAFFIC SAFETY YELLOW. HANDICAP SPACES, INCLUDING STRIPING, CURB FACE AND SYMBOLS, SHALL BE SAFETY BLUE.
5. THE CONCRETE BASE SHOWN IN LOT LIGHTING DETAILS IN PHASE 1 LIGHTING PLAN SHALL BE PAINTED TRAFFIC SAFETY YELLOW.
6. ALL PAINTED AREAS SHALL BE PROTECTED FROM TRAFFIC UNTIL THOROUGHLY DRY AND ACCEPTED BY MWSU.

## CONCRETE PAVING SECTION

NOT TO SCALE

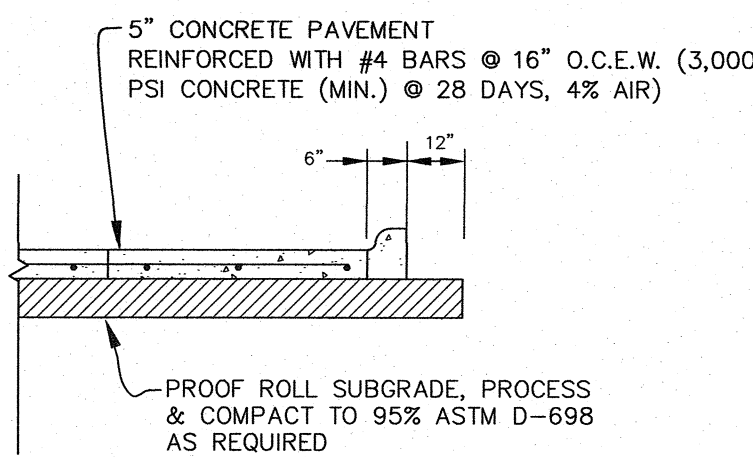

## NORTH FENCE DETAIL SECTION A-A

NOT TO SCALE

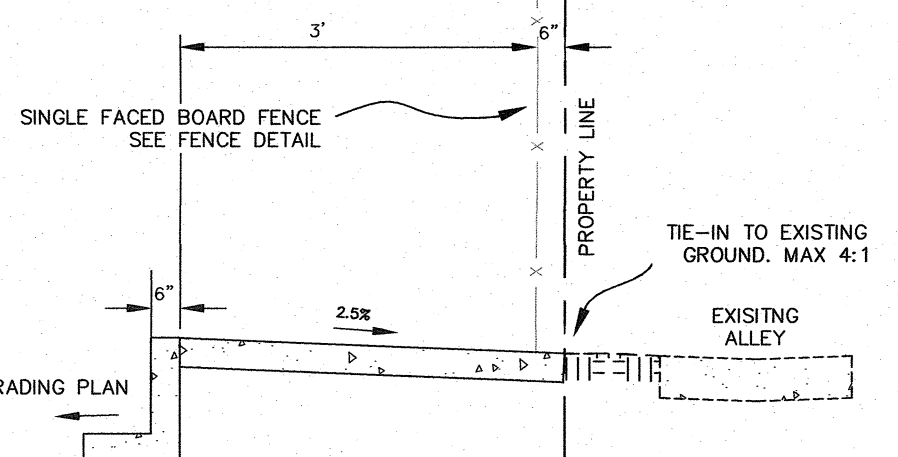

## WEST FENCE DETAIL SECTION B-B

NOT TO SCALE

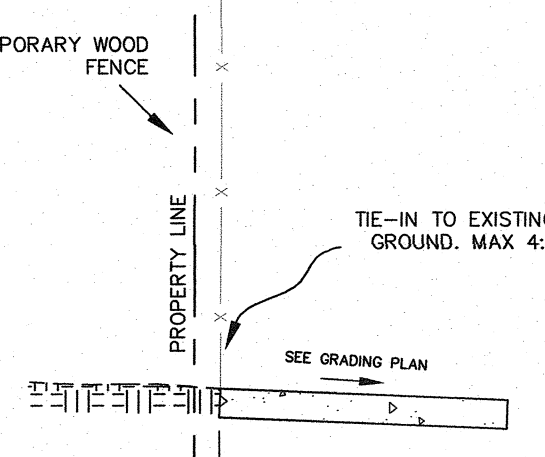

## EAST FENCE DETAIL SECTION C-C

NOT TO SCALE

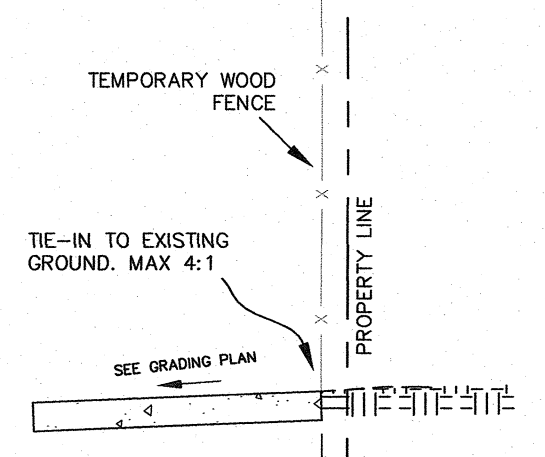

## LEGEND

SP	SIGN	6"SS	EXISTING 6" SANITARY SEWER LINE
PP	POWER POLE	6"W	EXISTING 6" WATER LINE
WM	WATER METER	GUY WIRE	GUY WIRE
GM	GAS METER	EXISTING SPOT ELEVATION	EXISTING SPOT ELEVATION
E	EXISTING ELECTRIC LINE	NEW SPOT ELEVATION	NEW SPOT ELEVATION
X	EXISTING FENCE	HANDICAPPED PARKING SYMBOL	HANDICAPPED PARKING SYMBOL
G	EXISTING 4" GAS LINE	EXISTING CONCRETE	EXISTING CONCRETE
-990-	EXISTING INDEX CONTOUR	PROPOSED CONCRETE	PROPOSED CONCRETE
-989-	EXISTING INTERMEDIATE CONTOUR	PROPERTY CORNER (AS NOTED)	PROPERTY CORNER (AS NOTED)

## CAUTION!!! - UNDERGROUND UTILITIES!!!

EXISTING UTILITIES AND UNDERGROUND FACILITIES INDICATED ON THESE PLANS HAVE BEEN LOCATED APPROXIMATELY BY SIGHT OR FROM INFORMATION SUPPLIED BY THE VARIOUS OWNERS OF THE FACILITIES. THE ENGINEER AND OWNER DO NOT ACCEPT ANY RESPONSIBILITY FOR THE LOCATIONS SHOWN. IT SHALL BE THE SOLE RESPONSIBILITY OF THE CONTRACTOR TO VERIFY BOTH HORIZONTALLY AND VERTICALLY THE LOCATION OF ALL UTILITIES PRIOR TO CONSTRUCTION; TO TAKE NECESSARY PRECAUTIONS TO PROTECT ALL FACILITIES ENCOUNTERED; AND TO NOTIFY THE ENGINEER PROMPTLY OF ALL CONFLICTS WITH THE PROPOSED WORK. THE CONTRACTOR SHALL PRESERVE AND PROTECT ALL EXIST. UTILITIES AND FACILITIES FROM DAMAGE DURING CONSTRUCTION. ANY DAMAGE TO THESE FACILITIES BY THE CONTRACTOR SHALL BE REPAIRED BY THE CONTRACTOR AT HIS/HER SOLE EXPENSE. FACILITIES OWNED BY THE ENTITIES LISTED BELOW ARE KNOWN TO BE LOCATED ON OR IN CLOSE PROXIMITY TO THE WORK AREA OF THIS PROJECT. ADDITIONAL FACILITIES OWNED BY OTHERS MAY ALSO BE AFFECTED. CONTACT ALL POSSIBLE UTILITY AND UNDERGROUND FACILITY OWNERS.

CITY OF WICHITA FALLS UTILITY OPERATIONS  
AT&T  
TEXAS DEPARTMENT OF TRANSPORTATION  
ONCOR ELECTRIC DELIVERY  
UNDERGROUND FACILITIES LOCATOR SERVICE  
ATMOS ENERGY

(940) 761-4333  
(940) 766-7217  
(940) 720-7709  
(940) 766-5460  
(800) 344-8377  
(940) 696-7602

## SIDEWALK-PAVEMENT DETAIL SECTION D-D

NOT TO SCALE

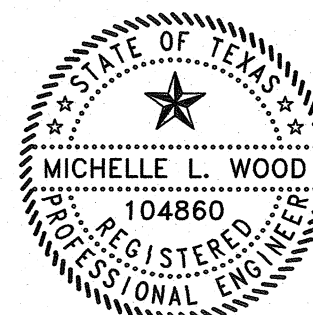
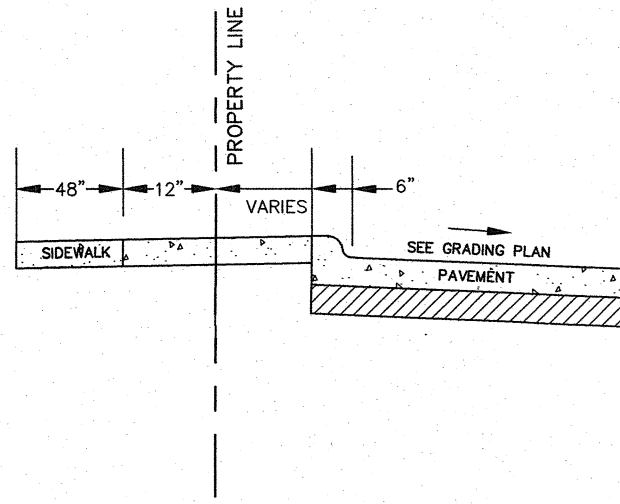

03/01/2017  
Michelle L. Wood  
REGISTERED PROFESSIONAL ENGINEER NO. 104860

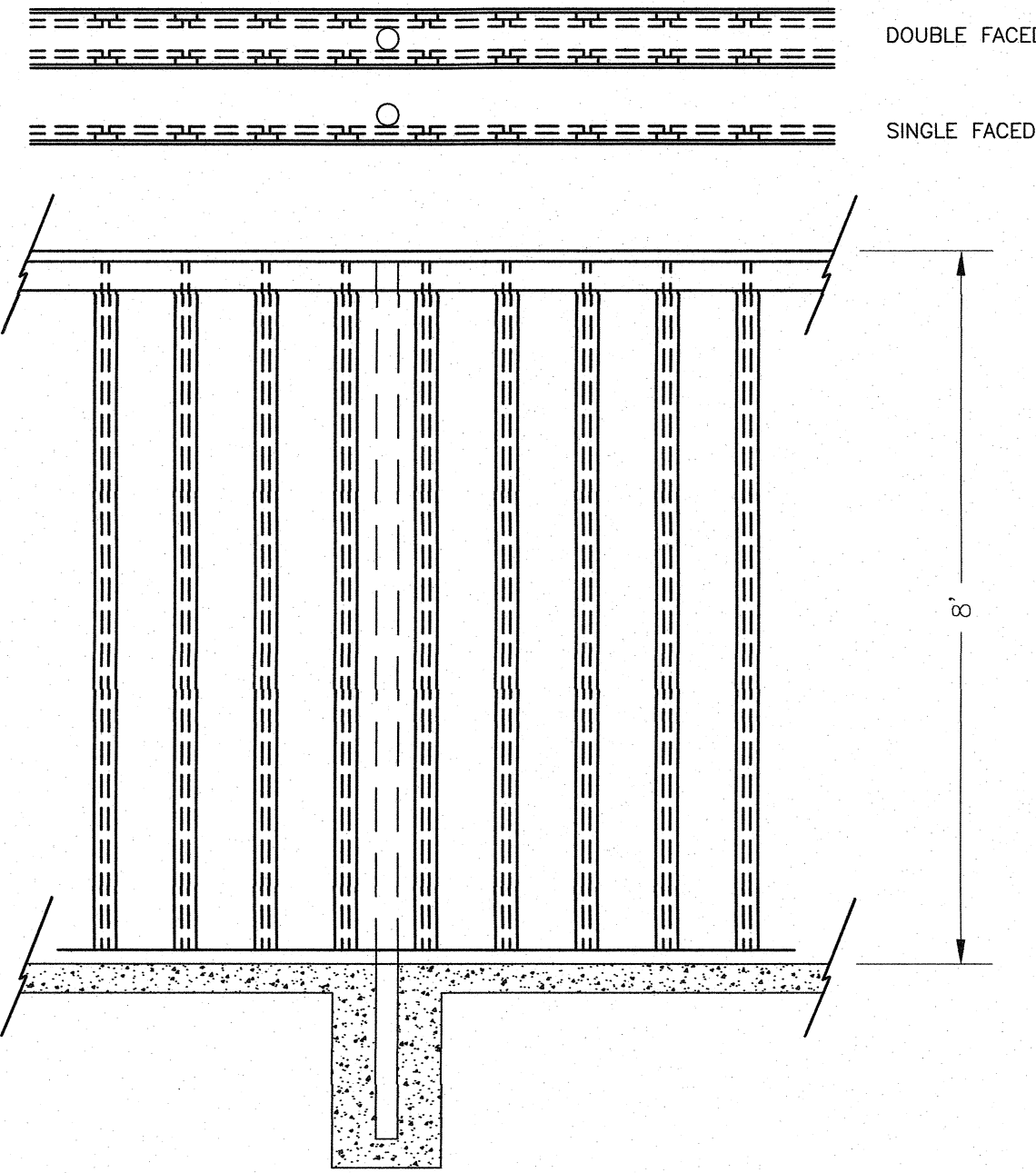

## FENCING DETAIL NOT TO SCALE

1. FENCE SHALL BE EITHER SINGLE FACED BOARD OR DOUBLE FACED BOARD. SEE PLAN VIEW.
2. FENCE SHALL BE A CAPPED, BOARD & BATTEN CEDAR FENCE FACED ON NORTH SIDE. THE HEIGHT SHALL BE 8'.
3. THERE SHALL BE AT LEAST THREE HORIZONTAL RAILS SUPPORTING THE FENCE. THESE SHALL BE 2" X 4" CEDAR. ALL FACING MATERIALS SHALL BE 1" X 8" X 8' #1 GRADE CEDAR. ALL RAILS USED SHALL BE GALVANIZED.
4. SUPPORTING POSTS SHALL BE 3" O.D. SCHEDULE 40 GALVANIZED POSTS ON NO MORE THAN 8' CENTERS EMBEDDED A MINIMUM OF 24" INTO A 12" DIAMETER 3000 PSI CONCRETE FOOTING.
5. CURBING BENEATH THE FENCE AND EXTENDING EAST TO THE BACK OF THE PARKING LOT CURB SHALL BE 4" MINIMUM THICKNESS 3000 PSI CONCRETE WITH #3 GRADE 40 REBAR AT 18" O.C.E.W. PROVIDE A LIGHT BROOM FINISH. THE PAVING WIDTH AS INDICATED ON PLANS.
6. AFTER THE FENCE IS FULLY ASSEMBLED IT SHALL BE SEALED WITH CABOT 3005 PACIFIC REDWOOD STAIN APPLIED FULL STRENGTH TO ALL EXPOSED SIDES OF THE FENCE. (KELLY-MOORE OR LOWE'S)

## TRIANGULAR SLIPBASE INSTALLATION GENERAL REQUIREMENTS

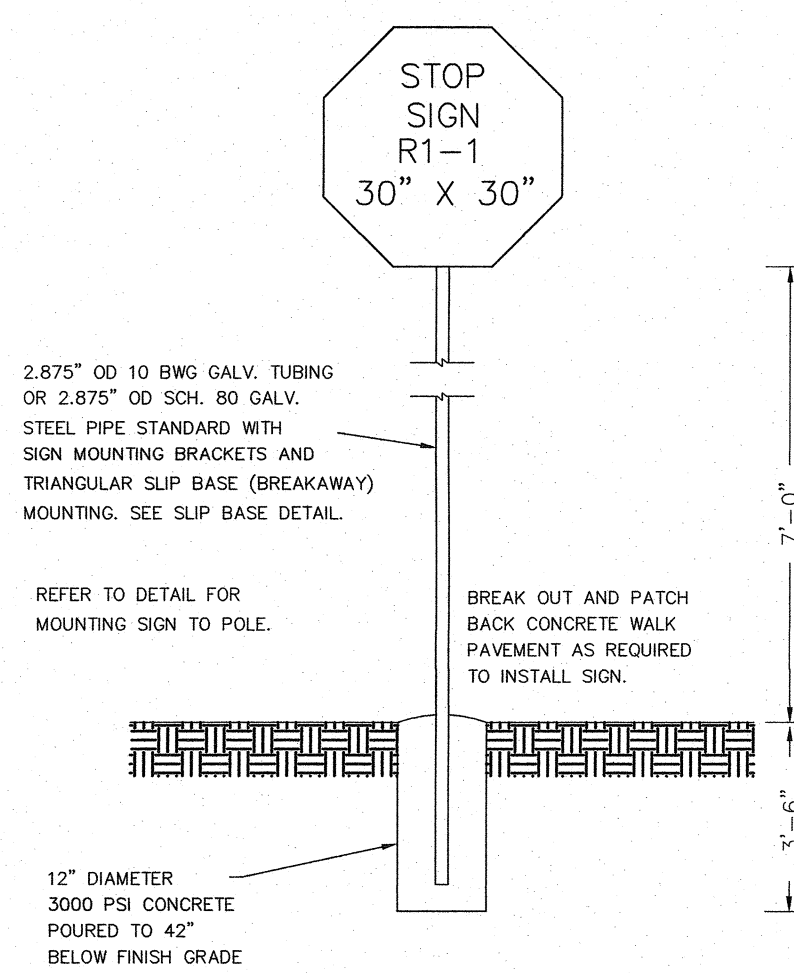
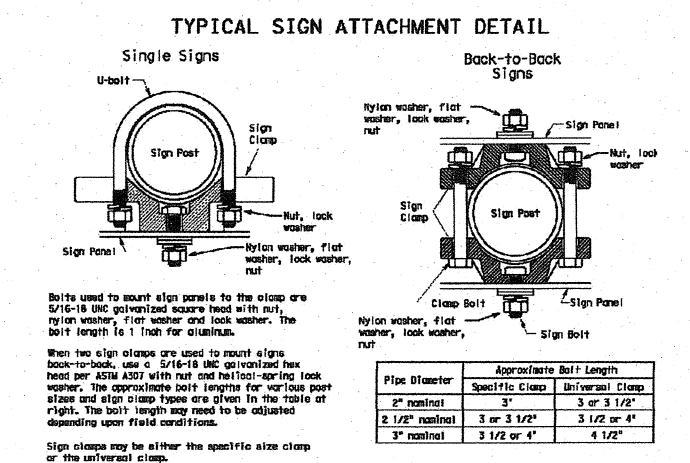
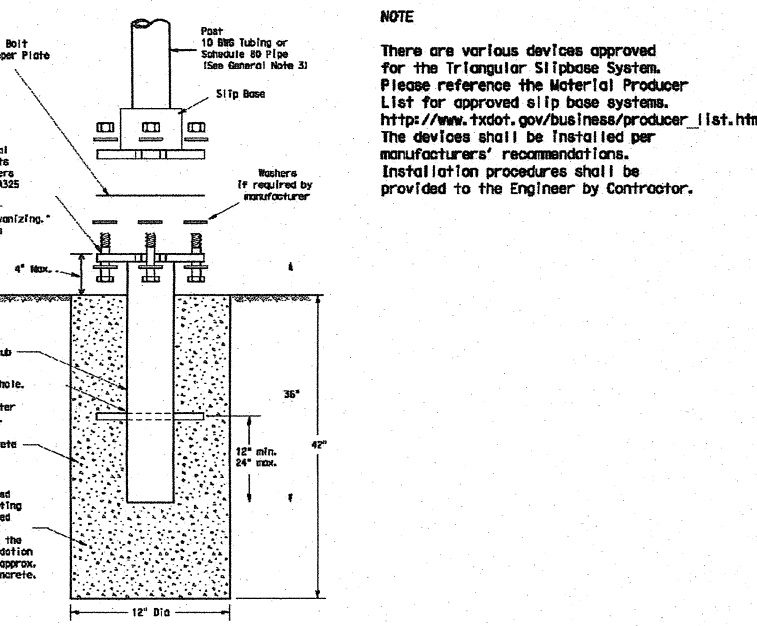

## TRAFFIC DIRECTIONAL SIGN NOT TO SCALE

## PHASE 1: GRADING & PAVING PLAN MIDWESTERN STATE UNIVERSITY PARKING LOT ADDITION PROJECT HAMPSHIRE LANE

DRAWN: MWC  
CHECKED: SLW  
APPROVED: SLW  
PHONE (940) 723-1405  
FAX (940) 397-0549  
CORLETT, PROBST & BOYD, P.L.L.C.  
ENGINEERS - SURVEYORS  
4605 OLD JACKSBORO HIGHWAY  
WICHITA FALLS, TEXAS 76302

SCALE: 1" = 20' MARCH, 2017 SHEET 3 OF 7



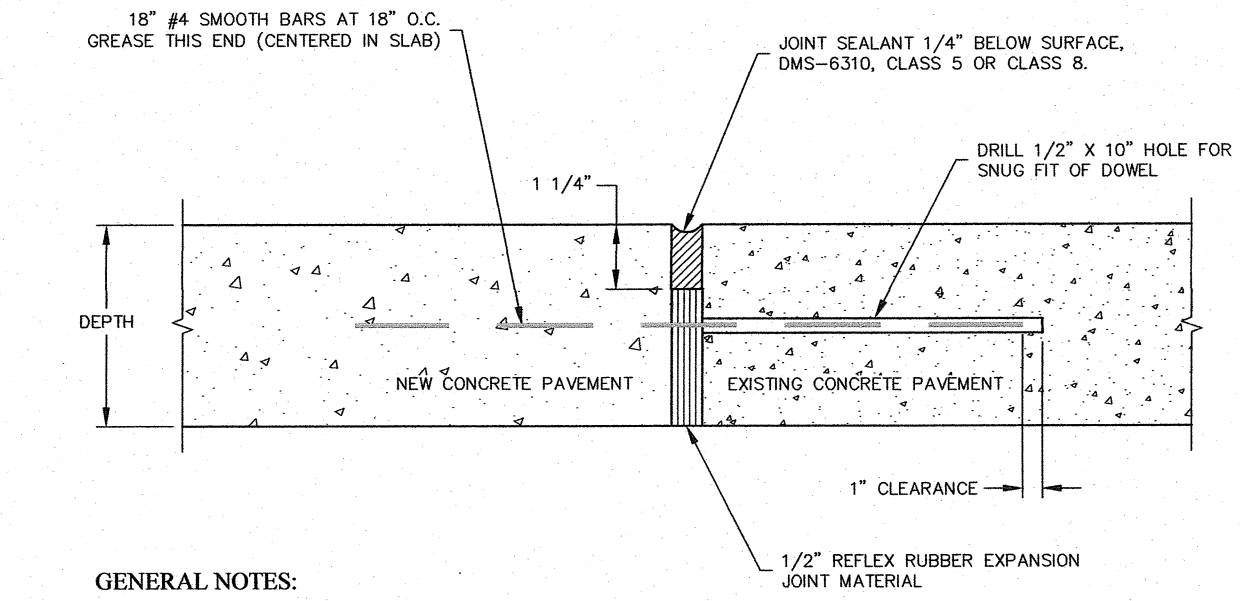
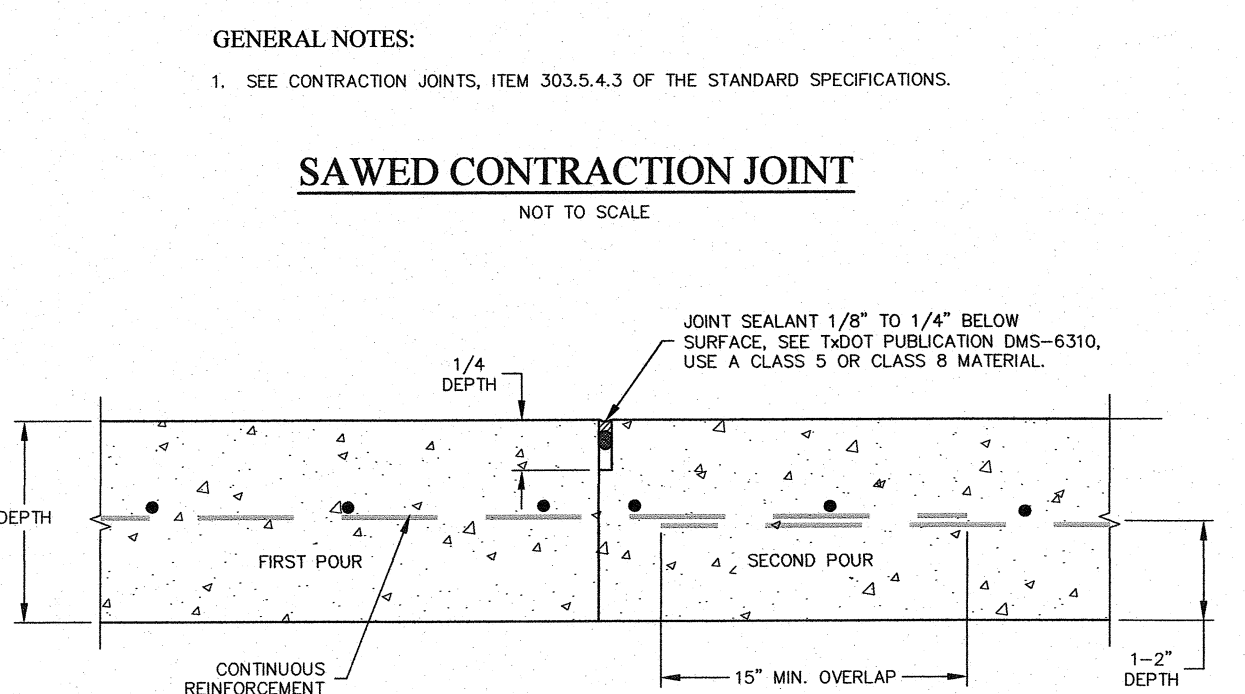
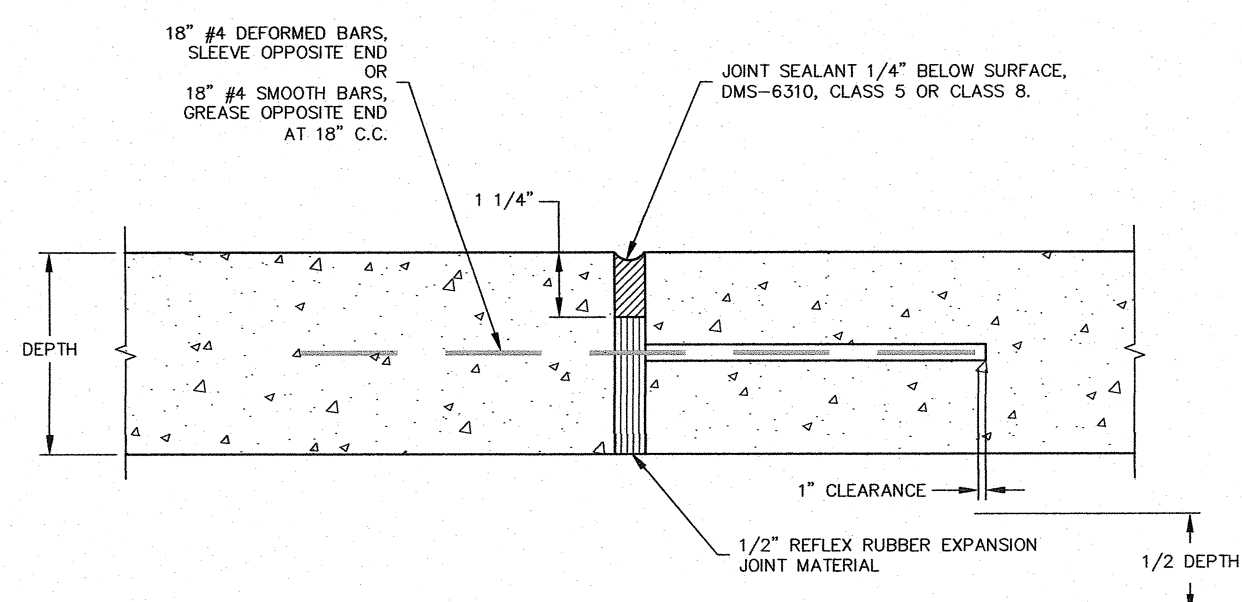
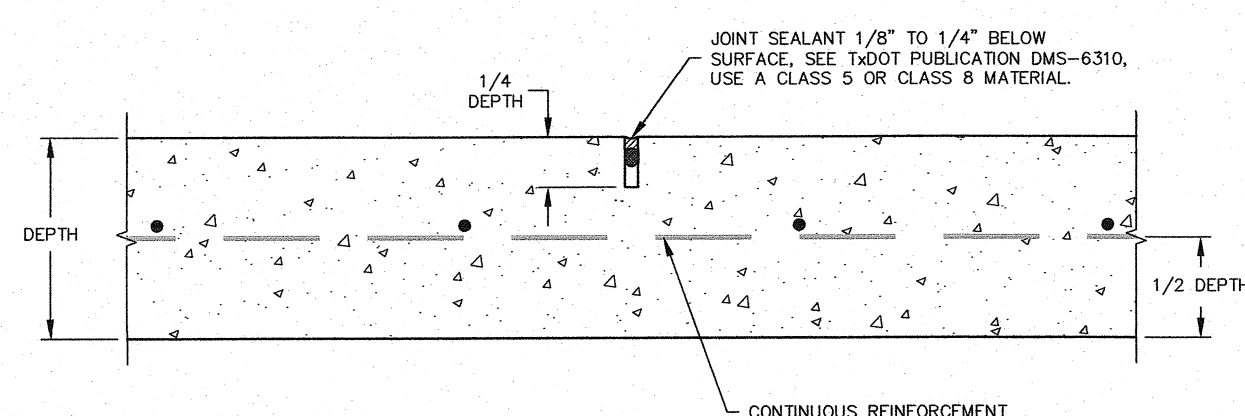
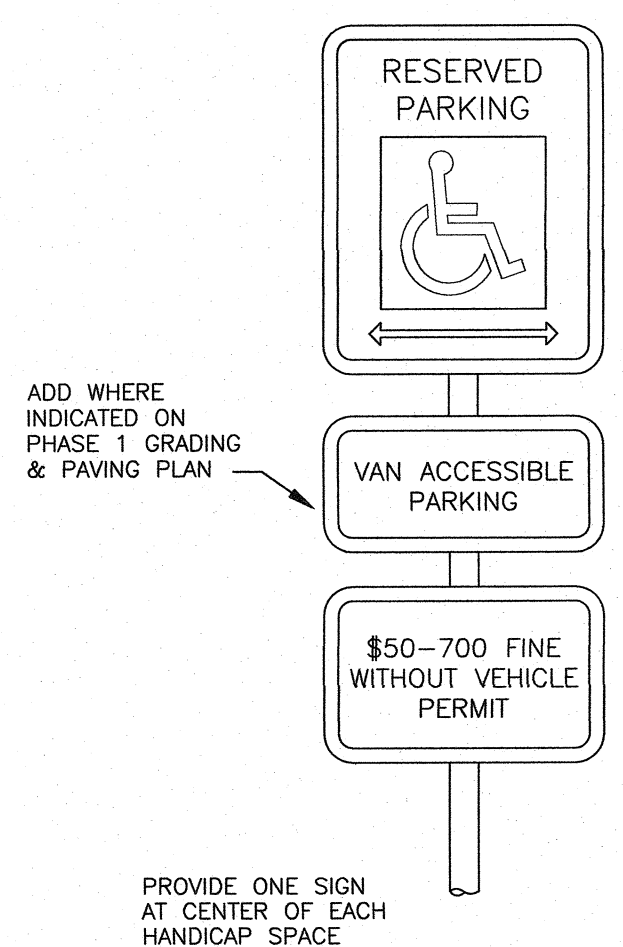
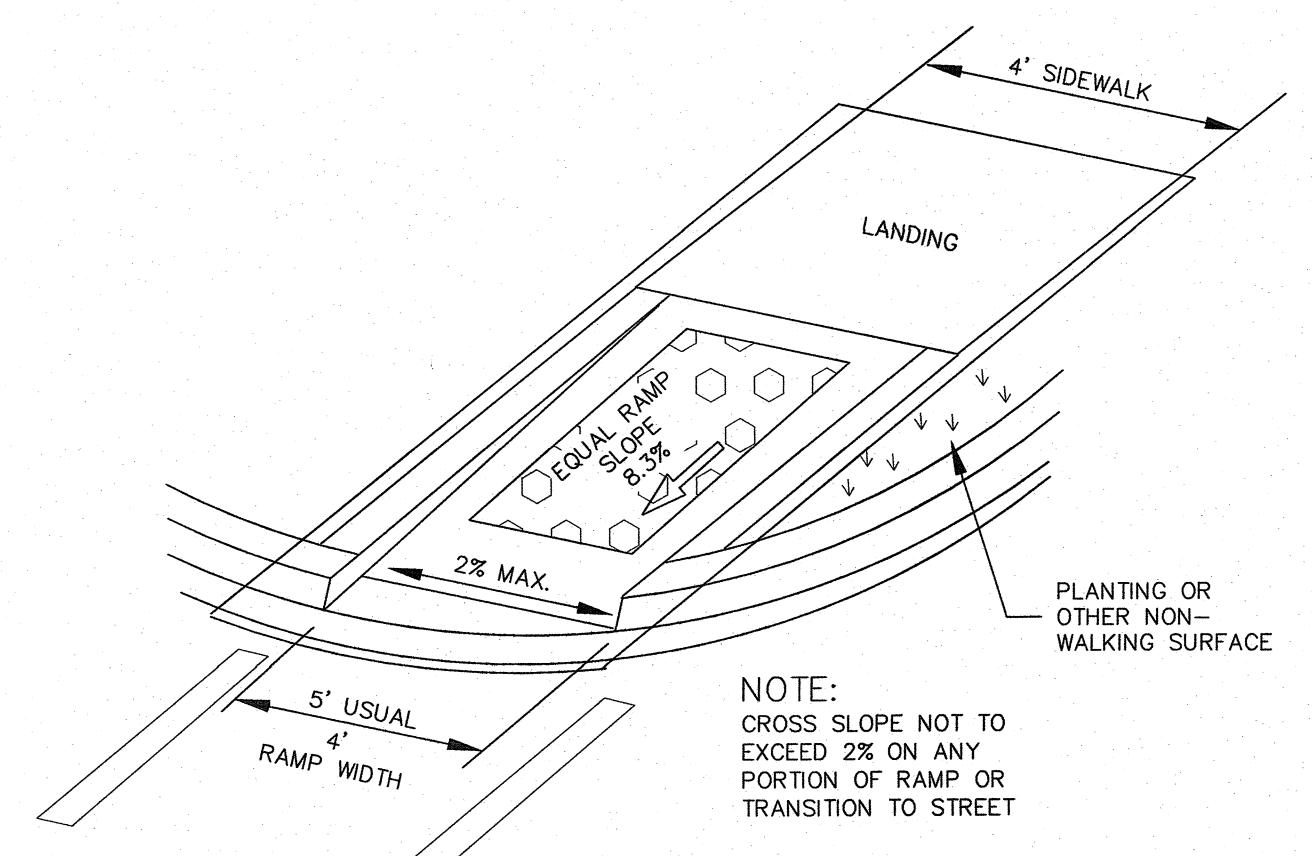
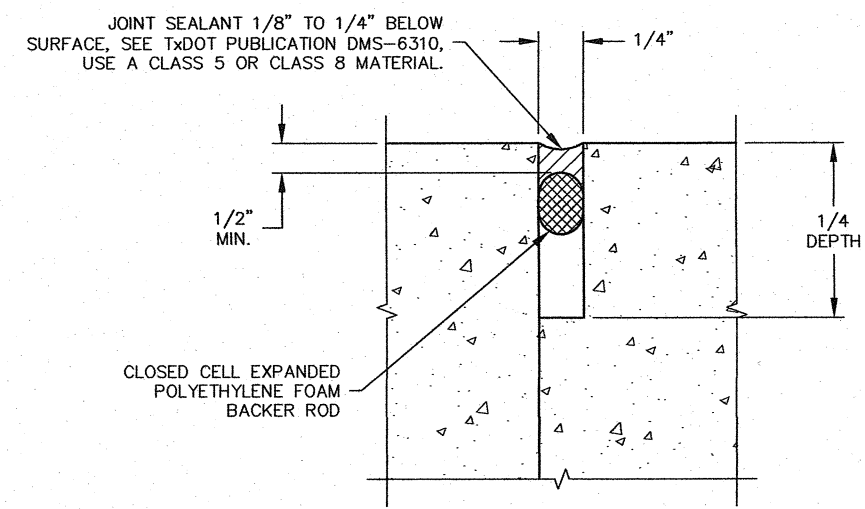
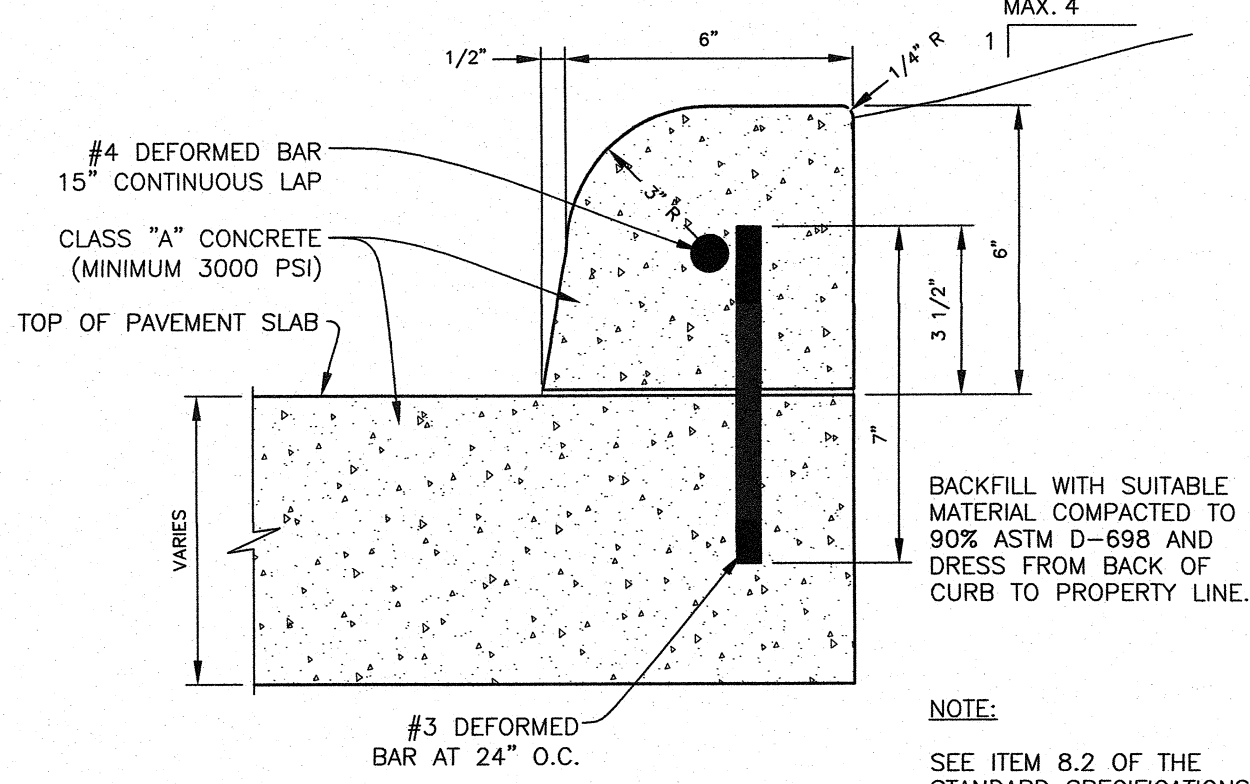
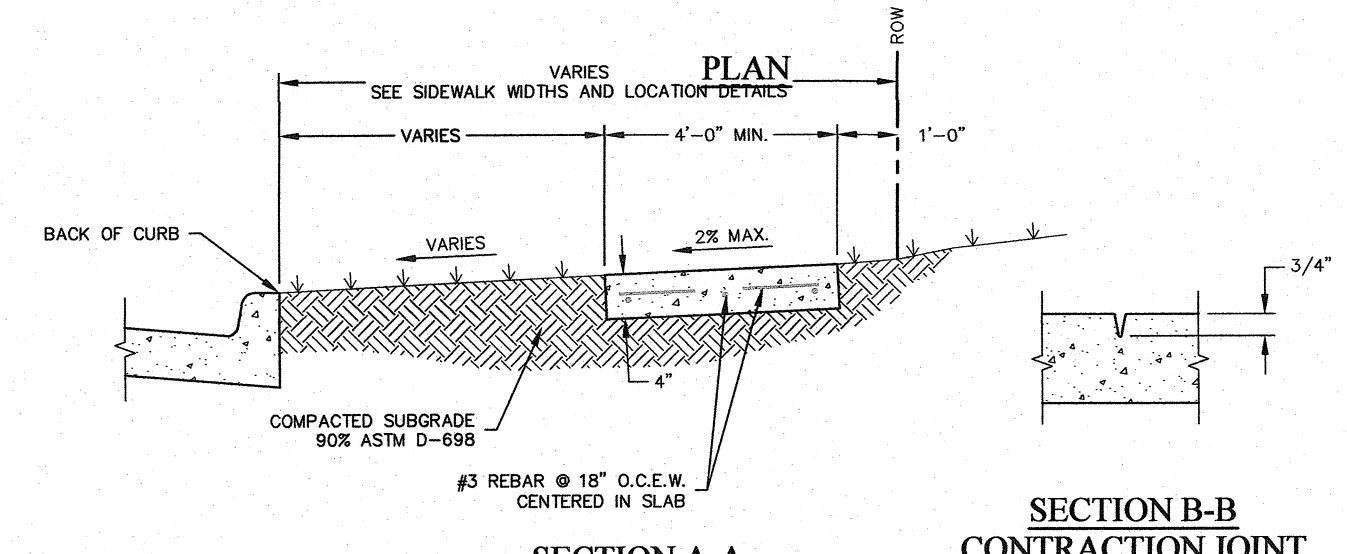
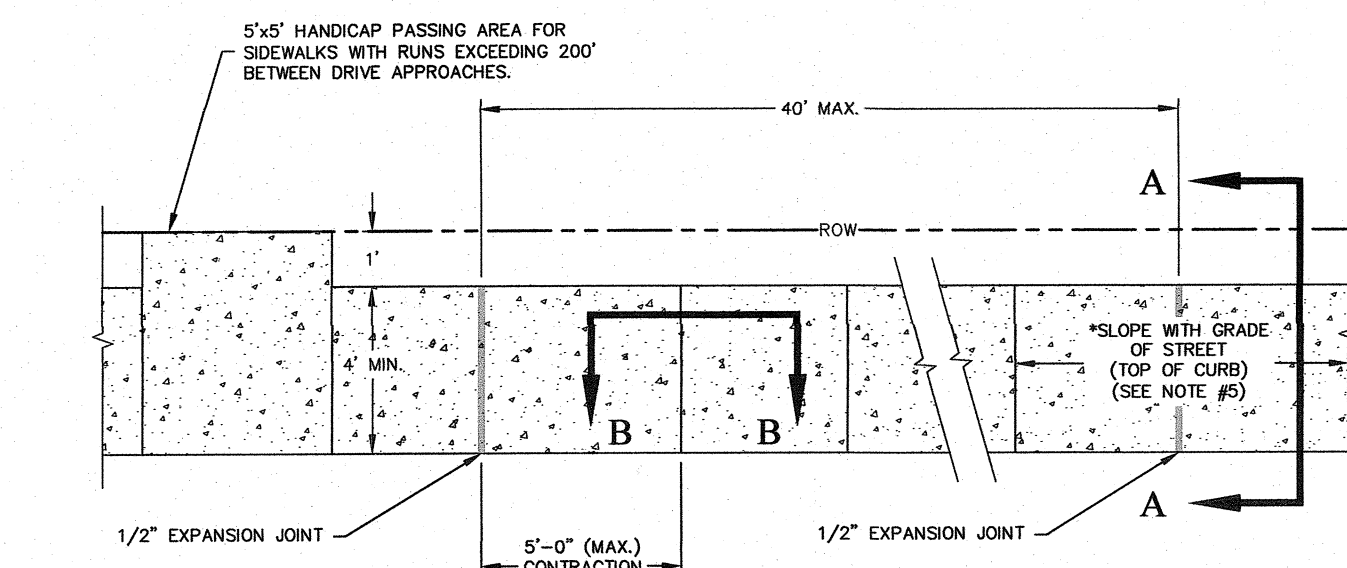
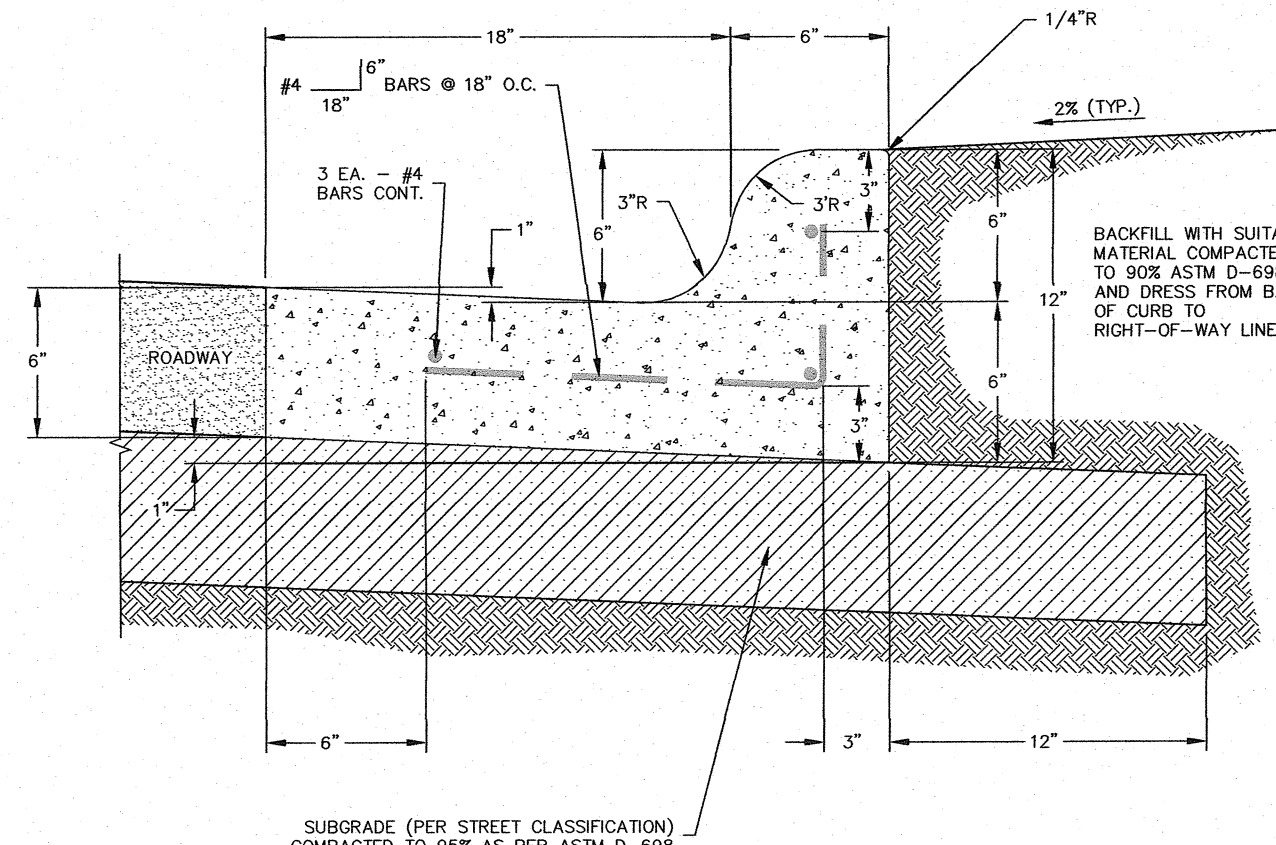
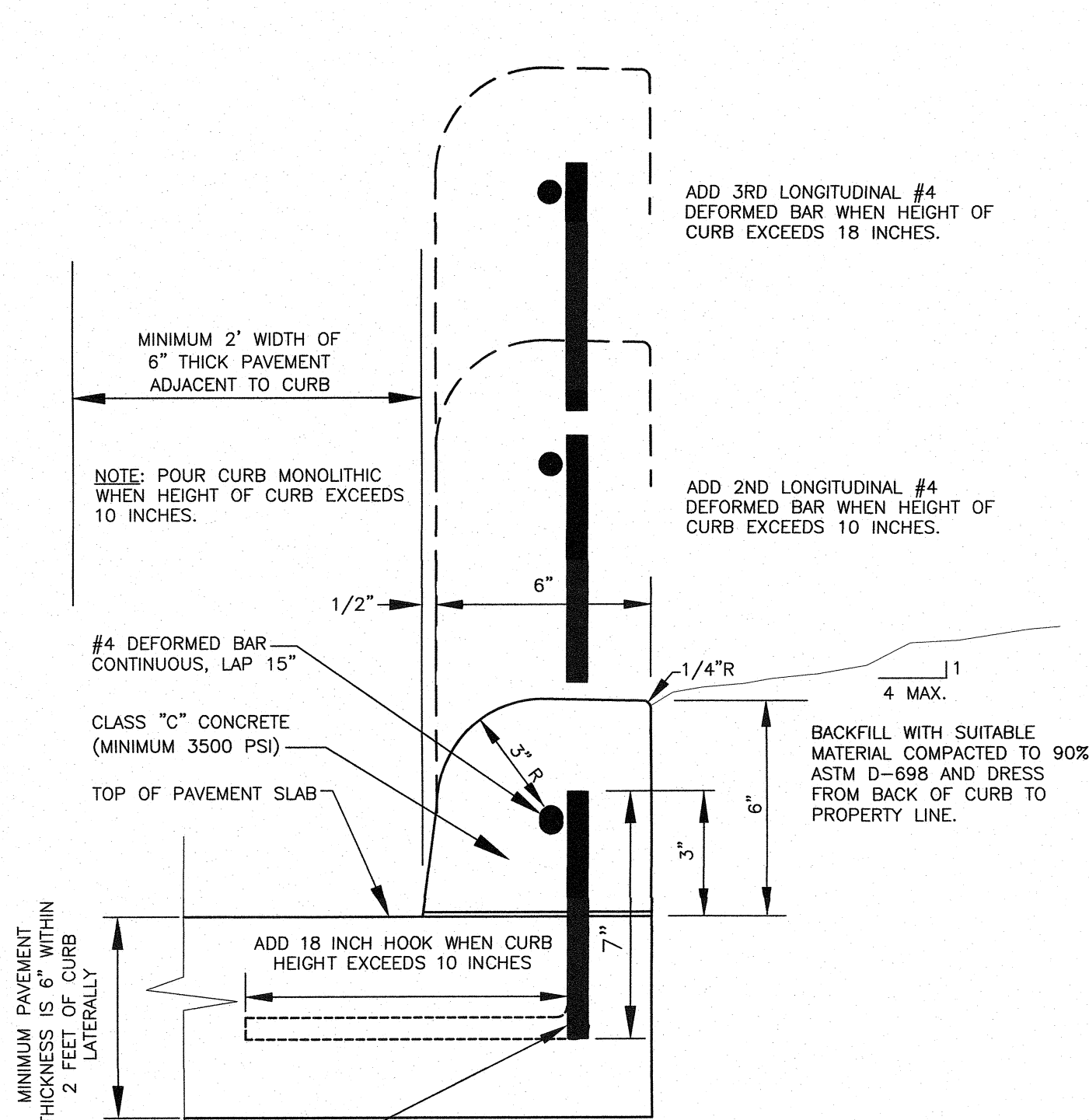

- CURB RAMP GENERAL NOTES:**
1. INSTALL A CURB RAMP AT EACH PEDESTRIAN STREET CROSSING.
  2. RAMP SHALL NOT BE STEEPER THAN 12:1 AND PAVEMENT COUNTER SLOPE SHALL NOT EXCEED 20:1 TOWARDS THE RAMP. ALL SLOPES SHOWN ARE MAXIMUM ALLOWABLE. LESSER SLOPES THAT WILL STILL DRAIN PROPERLY SHOULD BE USED. ADJUST CURB RAMP LENGTH OR GRADE OF APPROACH SIDEWALKS AS DIRECTED.
  3. MAXIMUM ALLOWABLE CROSS SLOPE ON SIDEWALK AND CURB RAMP SURFACES IS 2%.
  4. GUTTER FLOW LINE AND STREET PROFILE SHALL BE MAINTAINED THOUGH THE RAMP AREA WITH A SMOOTH TRANSITION BETWEEN RAMP AND STREET. ENSURE THAT POSITIVE DRAINAGE IS OBTAINED OFF LANDING AREA AND RAMP. CHANGES IN LEVEL GREATER THAN 1/4" ARE NOT PERMITTED.
  5. PROVIDE FLARED SIDES WHERE THE PEDESTRIAN CIRCULATION PATH CROSSES THE CURB RAMP. FLARED SIDES SHALL BE SLOPED AT 10% MAXIMUM, MEASURED PARALLEL TO THE CURB. RETURNED CURBS MAY BE USED ONLY WHERE PEDESTRIANS WOULD NOT NORMALLY WALK ACROSS THE RAMP, EITHER BECAUSE THE ADJACENT SURFACE IS PLANTED, SUBSTANTIALLY OBSTRUCTED OR OTHERWISE PROTECTED.
  6. LANDINGS SHALL BE 4' X 4' MINIMUM WITH A MAXIMUM 2% SLOPE IN ANY DIRECTION.
  7. MANEUVERING SPACE AT THE BOTTOM OF THE CURB RAMPS SHALL BE A MINIMUM OF 4' X 4' WHOLLY CONTAINED WITHIN THE CROSSWALK AND WHOLLY OUTSIDE THE PARALLEL VEHICULAR TRAVEL PATH.
  8. PLACE CONCRETE AT A MINIMUM DEPTH OF 5" FOR RAMPS, FLARES AND LANDINGS, UNLESS OTHERWISE DIRECTED. THE GUTTER PORTION OF THE RAMP IS MINIMUM 6" DEPTH OR MATCH ADJACENT PAVEMENT THICKNESS.
  9. ALL CONCRETE SHALL BE CLASS "A" (COMPRESSIVE STRENGTH OF 3000 PSI @ 28 DAYS.)
  10. RAMP AND LANDING AREA REINFORCING SHALL BE #3 BARS @ 18" O.C.E.W.
  11. DETECTABLE WARNINGS SHALL CONSIST OF A CAST IN PLACE DETECTABLE WARNING SURFACE AS MANUFACTURED BY ARMOR-TILE, ADA SOLUTIONS OR APPROVED EQUAL. THE DETECTABLE WARNING SHALL BE BRICK RED UNLESS DIRECTED OTHERWISE BY THE ENGINEER OR A DESIGNATED REPRESENTATIVE. THE COLOR SHALL BE A HOMOGENEOUS PART OF THE DETECTABLE WARNING DEVICE.
  12. DETECTABLE WARNING SURFACES SHALL BE A MINIMUM OF 24" IN DEPTH IN THE DIRECTION OF PEDESTRIAN TRAVEL, AND EXTEND THE FULL WIDTH OF THE CURB RAMP OR LANDING WHERE THE PEDESTRIAN ACCESS ROUTE ENTERS THE STREET.
  13. DETECTABLE WARNING SURFACES SHALL BE LOCATED SO THAT THE EDGE NEAREST THE CURB LINE IS AT THE BACK OF THE CURB. ALIGN ROWS OF DOWES TO BE PERPENDICULAR TO THE GRADE BREAK BETWEEN THE RAMP RUN AND THE STREET. DETECTABLE WARNING SURFACES MAY BE CURVED ALONG THE CORNER RADIUS.
  14. PLACE UTILITY POLES, GROUND BOXES, METER BOXES, SIGNS, DRAINAGE FACILITIES AND OTHER ITEMS SO AS NOT TO OBSTRUCT THE PEDESTRIAN ACCESS ROUTE OR CLEAR GROUND SPACE.
  15. RAMP LIMITS OF PAYMENT SHALL INCLUDE RAMP, LANDING, REQUIRED FLARES AND GUTTER ADJACENT TO RAMP AND FLARES.

**PEDESTRIAN FACILITIES CURB RAMP NOTES**



03/01/2017  
*Michelle L. Wood*  
MICHELLE L. WOOD  
REGISTERED PROFESSIONAL ENGINEER NO. 104860

**PHASE 1: PAVING DETAILS  
MIDWESTERN STATE UNIVERSITY  
PARKING LOT ADDITION PROJECT  
HAMPSTEAD LANE**

**CORLETT, PROBST & BOYD, P.L.L.C.**  
ENGINEERS - SURVEYORS  
4605 OLD JACKSBORO HIGHWAY  
WICHITA FALLS, TEXAS 76302







C:\MARK\2017\31735\31735.DWG (PLIGHTING) P-3/1/2017 11:58 AM S-3/1/2017 11:56 AM C.M.

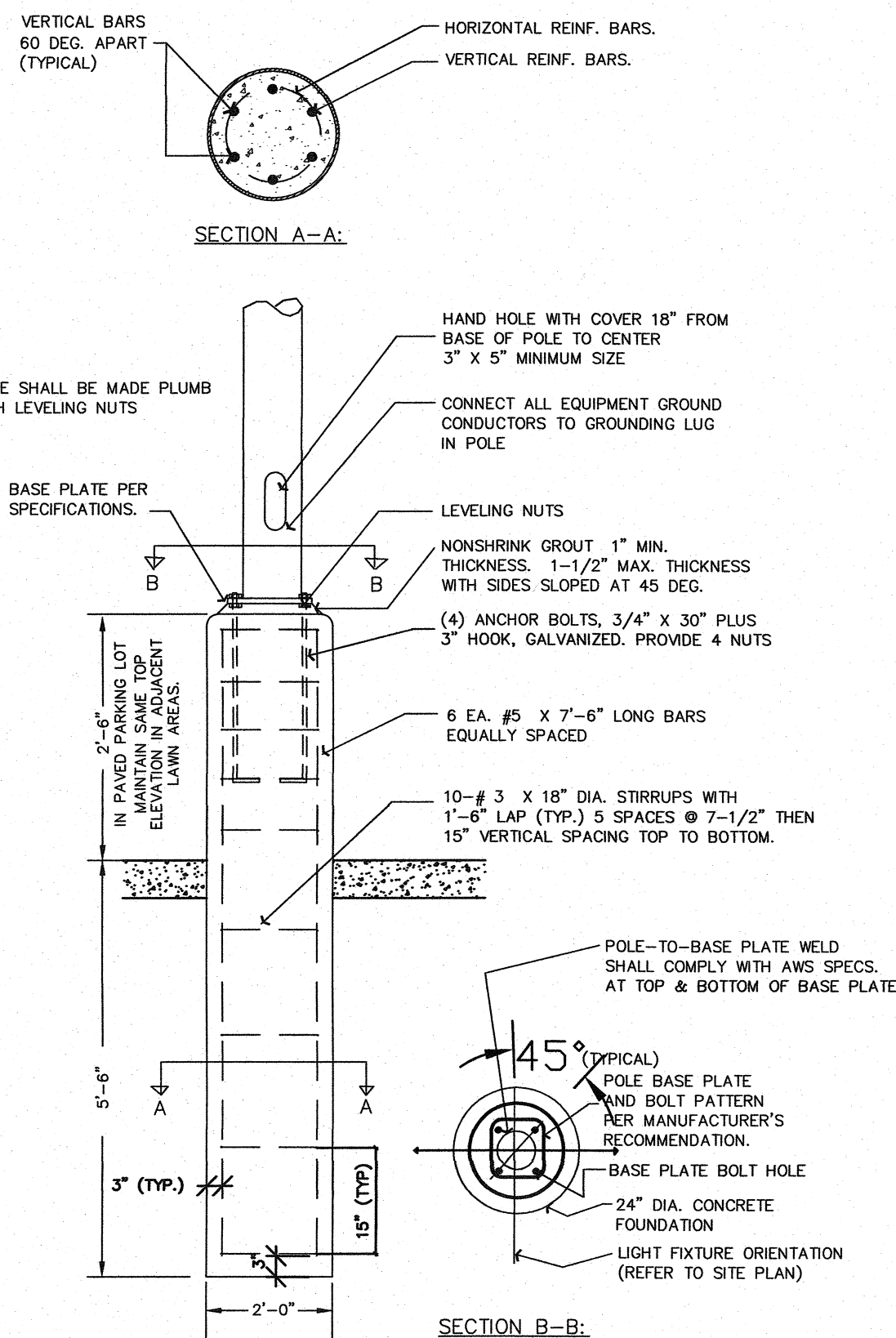

NOTES:

1. USE 3500 PSI MIN. 28 DAY COMPRESSIVE STRENGTH CONC. WITH GRADE 60 RE-BAR.
2. IF WATER IS PRESENT IN HOLE, REMOVE BEFORE POURING CONCRETE.
3. FOUNDATION EXCAVATION SHALL BE BY 24" AUGER IN UNDISTURBED SOIL. ALL LOOSE SOIL MATERIAL SHALL BE REMOVED PRIOR TO POURING CONCRETE.
4. CONFIRM ACTUAL ANCHOR BOLT PATTERN AND DIMENSIONS WITH POLE MANUFACTURER'S DRAWINGS.

LIGHT POLE FOUNDATION  
DETAIL  
SCALE: NONE

CONTRACTOR SHALL CONFIRM AND SHALL  
COORDINATE WITH ONCOR ELECTRIC FOR THE IN-  
LOCATION FOR SERVICE. INSTALL NEW LOCKABLE  
NEMA 3R LIGHTING CONTROL DISCONNECT WITH AN  
INTERMATIC TIMER AND A PHOTOCELL TO CONTROL  
THE LIGHTS ON THE EXISTING SERVICE POLE IN THE  
ADJACENT ALLEY WHICH IS TO REMAIN. INSTALL  
CONDUIT FROM CONTROL PANEL TO LIGHTING  
LOCATIONS AS INDICATED. METALLIC CONDUIT TO BE  
USED ABOVE GROUND AND PVC BELOW GROUND.  
LONG SWEEP ELBOWS SHALL BE USED AND PIPING  
SHALL BE BURIED AT LEAST 24" BELOW FINISHED  
GRADE. CONDUIT AND CONDUCTOR SHALL BE SIZED  
PER NEC FOR FIXTURES AND DISTANCES REQUIRED.

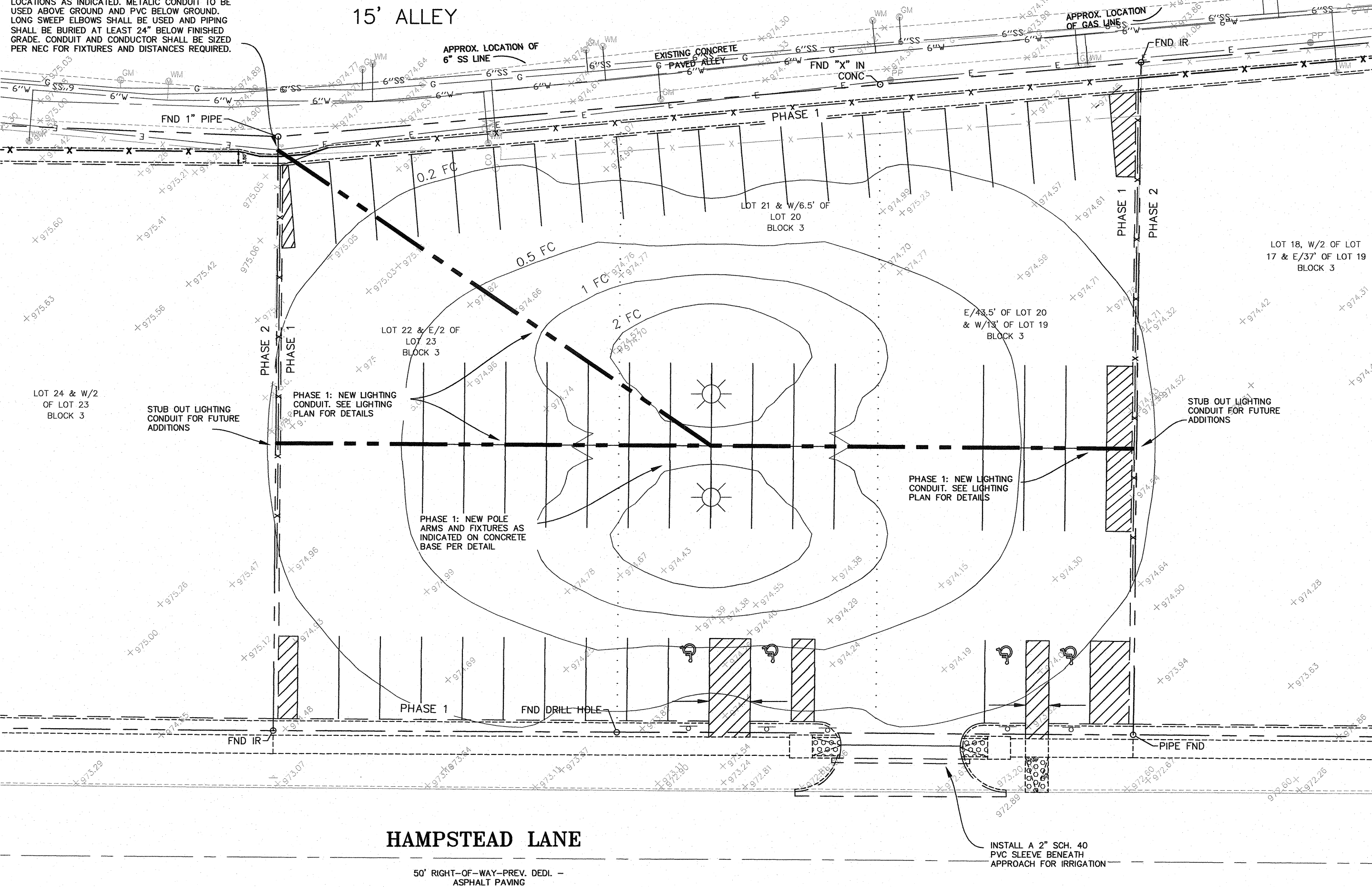

PHASE 1 LIGHTING NOTES

1. THE NEW PARKING LOT LIGHTS SHALL BE MOUNTED ON 24" DIAMETER CONCRETE FOUNDATIONS AS DESCRIBED ON DETAIL SHEET 6. THE PARKING LOT WILL BE BUILT IN TWO PHASES SO ONLY ONE LIGHT IS TO BE INSTALLED FOR PHASE 1. THE OTHER LIGHT POLES SHOWN IN PHASE 2 SHALL BE BUILT IN A FUTURE ADDITION TO THE PARKING LOT. ELECTRICAL CONDUIT SHALL BE PROVIDED TO THE EDGE OF PAVEMENT FOR THE PHASE 1 PARKING LOT DESIGN. THIS ELECTRICAL CONDUIT WILL BE EXTENDED FOR FUTURE ADDITIONS.
2. THE NEW LIGHT POLES SHALL BE KW INDUSTRIES RTSU25-6.1-11-BRZ 185-BC (SINGLE ARM) AND KW INDUSTRIES RTSU25-6.1-11-BRZ 285-BC (DOUBLE ARM AT 180°) MOUNTED TO THE CONCRETE FOUNDATIONS WITH GALVANIZED 3/4" X 30" LONG WITH 3" HOOK ANCHOR BOLTS. THE ANCHOR BOLTS SHALL BE DOUBLE-NUTTED TO PLUMB THE POLE. ONCE THE POLE HAS BEEN PLUMBED AND BOLTS TIGHTENED, THE SPACE BENEATH THE BASE PLATE SHALL BE PACKED WITH NON-SHRINK, HIGH STRENGTH GROUT. POLE ARMS SHALL BE ORIENTED AS INDICATED ON THE PLAN.
3. THE NEW LIGHT FIXTURES SHALL BE GE EVOLVE LED MEDIUM COBRAHEAD ROADWAY LIGHT, ERM-C-0-A3-60-A-A-GRAY, 208/1. PROVIDE A PHOTOCELL ON THE LIGHT STANDARD NEAREST THE SERVICE POLE. INSTALL SHORTING CAPS IN THOSE FIXTURES THAT ARE CONTROLLED BY A REMOTE PHOTOCELL.
4. BURIED 3/4" SCH. 40 PVC CONDUIT RUNS AND WIRING ARE REQUIRED TO MAKE THE CONNECTIONS. CONDUIT SHALL BE BURIED A MINIMUM OF 24" BELOW FINISH GRADE. USE LONG SWEEP ELBOWS TO BRING CONDUIT UP INTO LIGHT FOUNDATIONS. ALL WORK SHALL BE DONE BY A LICENSED ELECTRICIAN IN KEEPING WITH THE NATIONAL ELECTRIC CODE, LATEST EDITION.
5. ALL ELECTRICAL WORK SHALL BE COORDINATED THROUGH AND INSPECTED BY THE MWSU ELECTRICAL SUPERINTENDENT, DOUGLAS ALLISON (940) 397-4706.

LEGEND

+	SIGN	6"	EXISTING 6" WATER LINE
•	POWER POLE	---	GUY WIRE
⊙	WATER METER	998.00	EXISTING SPOT ELEVATION
—E—	EXISTING ELECTRIC LINE	00.00	NEW SPOT ELEVATION
—X—	EXISTING FENCE	FND IR	PROPERTY CORNER (AS NOTED)
—4"G—	EXISTING 4" GAS LINE		
—6"SS—	EXISTING 6" SANITARY SEWER LINE		

CAUTION!!! - UNDERGROUND UTILITIES!!!

EXISTING UTILITIES AND UNDERGROUND FACILITIES INDICATED ON THESE PLANS HAVE BEEN LOCATED APPROXIMATELY BY SIGHT OR FROM INFORMATION SUPPLIED BY THE VARIOUS OWNERS OF THE FACILITIES. THE ENGINEER AND OWNER DO NOT ACCEPT ANY RESPONSIBILITY FOR THE LOCATIONS SHOWN. IT SHALL BE THE SOLE RESPONSIBILITY OF THE CONTRACTOR TO VERIFY BOTH HORIZONTALLY AND VERTICALLY THE LOCATION OF ALL UTILITIES PRIOR TO CONSTRUCTION; TO TAKE NECESSARY PRECAUTIONS TO PROTECT ALL FACILITIES ENCOUNTERED; AND TO NOTIFY THE ENGINEER PROMPTLY OF ALL CONFLICTS WITH THE PROPOSED WORK. THE CONTRACTOR SHALL PRESERVE AND PROTECT ALL EXIST. UTILITIES AND FACILITIES FROM DAMAGE DURING CONSTRUCTION. ANY DAMAGE TO THESE FACILITIES BY THE CONTRACTOR SHALL BE REPAIRED BY THE CONTRACTOR AT HIS/HER SOLE EXPENSE. FACILITIES OWNED BY THE ENTITIES LISTED BELOW ARE KNOWN TO BE LOCATED ON OR IN CLOSE PROXIMITY TO THE WORK AREA OF THIS PROJECT. ADDITIONAL FACILITIES OWNED BY OTHERS MAY ALSO BE AFFECTED. CONTACT ALL POSSIBLE UTILITY AND UNDERGROUND FACILITY OWNERS.

CITY OF WICHITA FALLS UTILITY OPERATIONS  
AT&T  
TEXAS DEPARTMENT OF TRANSPORTATION  
ONCOR ELECTRIC DELIVERY  
UNDERGROUND FACILITIES LOCATOR SERVICE  
ATMOS ENERGY

(940) 761-4333  
(940) 766-7217  
(940) 720-7709  
(940) 766-5460  
(800) 344-8377  
(940) 696-7602



03/01/2017  
Michelle L. Wood  
MICHELLE L. WOOD  
REGISTERED PROFESSIONAL ENGINEER NO. 104860

PHASE 1: LIGHTING PLAN  
MIDWESTERN STATE UNIVERSITY  
PARKING LOT ADDITION PROJECT  
HAMPSTEAD LANE

CORLETT, PROBST & BOYD, P.L.L.C.

ENGINEERS - SURVEYORS  
4605 OLD JACKSBORO HIGHWAY  
WICHITA FALLS, TEXAS 76302

SCALE: 1" = 20'

MARCH, 2017

SHEET 6 OF 7



G:\MARK\2017\31735\31735.DWG DIMCONTROL(7) P-3/7/2017 12:10 PM S-3/7/2017 12:03 PM C.M

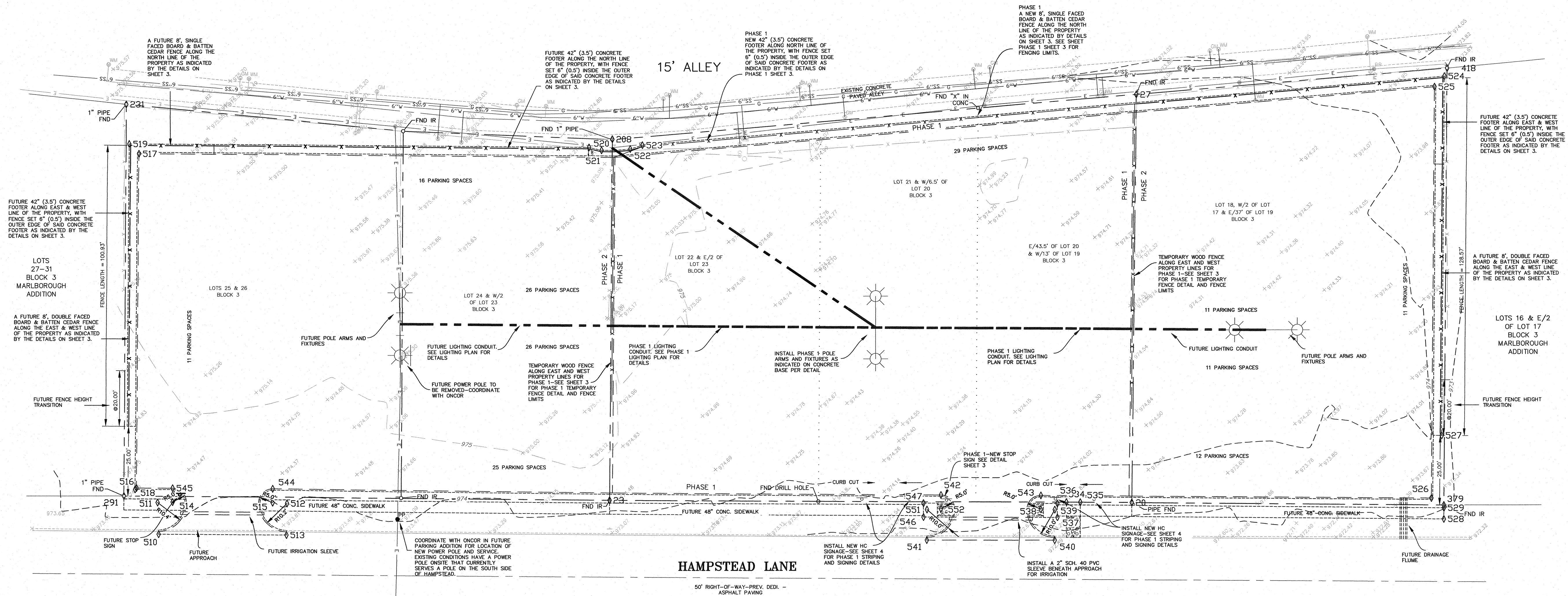

### CAUTION!!! - UNDERGROUND UTILITIES!!!

EXISTING UTILITIES AND UNDERGROUND FACILITIES INDICATED ON THESE PLANS HAVE BEEN LOCATED APPROXIMATELY BY SIGHT OR FROM INFORMATION SUPPLIED BY THE VARIOUS OWNERS OF THE FACILITIES. THE ENGINEER AND OWNER DO NOT ACCEPT ANY RESPONSIBILITY FOR THE LOCATIONS SHOWN. IT SHALL BE THE SOLE RESPONSIBILITY OF THE CONTRACTOR TO VERIFY BOTH HORIZONTALLY AND VERTICALLY THE LOCATION OF ALL UTILITIES PRIOR TO CONSTRUCTION; TO TAKE NECESSARY PRECAUTIONS TO PROTECT ALL FACILITIES ENCOUNTERED; AND TO NOTIFY THE ENGINEER PROMPTLY OF ALL CONFLICTS WITH THE PROPOSED WORK. THE CONTRACTOR SHALL PRESERVE AND PROTECT ALL EXIST. UTILITIES AND FACILITIES FROM DAMAGE DURING CONSTRUCTION. ANY DAMAGE TO THESE FACILITIES BY THE CONTRACTOR SHALL BE REPAIRED BY THE CONTRACTOR AT HIS/HER SOLE EXPENSE. FACILITIES OWNED BY THE ENTITIES LISTED BELOW ARE KNOWN TO BE LOCATED ON OR IN CLOSE PROXIMITY TO THE WORK AREA OF THIS PROJECT. ADDITIONAL FACILITIES OWNED BY OTHERS MAY ALSO BE AFFECTED. CONTACT ALL POSSIBLE UTILITY AND UNDERGROUND FACILITY OWNERS.

CITY OF WICHITA FALLS UTILITY OPERATIONS (940) 761-4333  
AT&T (940) 766-7217  
TEXAS DEPARTMENT OF TRANSPORTATION (940) 720-7709  
ONCOR ELECTRIC DELIVERY (940) 766-5460  
UNDERGROUND FACILITIES LOCATOR SERVICE (800) 344-8377  
ATMOS ENERGY (940) 696-7602

### LEGEND

PP	SIGN	6"SS	EXISTING 6" SANITARY SEWER LINE
PP	POWER POLE	6"W	EXISTING 6" WATER LINE
WM	WATER METER	GUY WIRE	
GM	GAS METER	EXISTING SPOT ELEVATION	
E	EXISTING ELECTRIC LINE	NEW SPOT ELEVATION	
X	EXISTING FENCE	HANDICAPPED PARKING SYMBOL	
G	EXISTING 4" GAS LINE	PROPERTY CORNER (AS NOTED)	
-990-	EXISTING INDEX CONTOUR		
-989-	EXISTING INTERMEDIATE CONTOUR		

Point Table			
Point #	Raw Description	Northing	Easting
551	RAD PT	4997.6099	4926.2586
552	RAD PT	4997.8411	4931.2604
540	PI APP	4986.4572	4972.2325
541	PI APP	4986.6101	4926.1873
542	PI FL	5002.8410	4931.2960
543	PI FL	5002.5848	4967.2951
544	PI FL	5005.0515	4690.9005
545	PI FL	5005.3078	4654.9014
546	PI RAMP	4994.9156	4924.9984
547	PI RAMP	4999.9156	4925.0261
510	PI APP	4988.7714	4649.7859
511	RAD PNT	5000.1502	4649.4822
512	RAD PNT	4999.7495	4696.0480
513	PI APP	4988.4116	4695.7917
514	RAD	5000.3079	4654.8658
515	RAD	5000.0517	4690.8649
516	PI FL	5005.4003	4641.9017
517	PI FL	5125.3972	4642.7557
518	PI BC	5004.9039	4641.3981
519	PI BACK RUNNER	5128.9221	4639.2807

Point Table			
Point #	Raw Description	Northing	Easting
520	PI BACK RUNNER	5127.7442	4804.7765
521	PI BACK RUNNER	5126.7122	4809.2693
522	PI BACK RUNNER	5127.1877	4819.5837
523	PI BACK RUNNER	5128.5672	4823.9822
524	PI BACK RUNNER	5153.2077	5112.3376
525	PI FL	5149.3934	5108.8089
526	PI FL	5001.5855	5107.6983
527	PI BACK RUNNER	5024.0875	5111.3675
528	PI FC WALK	4994.0802	5112.1390
529	PI BACK WALK	4998.0800	5112.1718
534	PI RAMP	5000.1304	4976.4769
535	PI RAMP	5000.1027	4981.4768
536	PI RAMP	4999.6484	4973.2191
537	PI RAMP	4994.6485	4973.1914
538	RAD	4997.5849	4967.2595
539	RAD	4997.4572	4972.2587
379	FIR	4999.0800	5112.1800
418	FIR	5156.0960	5113.3120
208	1IN PIPE FND	5130.6920	4813.1700
231	1IN PIPE FND	5143.1440	4638.2720

Point Table			
Point #	Raw Description	Northing	Easting
291	1IN PIPE FND	5002.5090	4637.3810
23	FIR	5001.0410	4812.1910
20	PIPE FND INPUT	5000.0000	5000.0000
27	FIR	5146.6290	5001.5830



03/01/2017  
Michelle L. Wood  
MICHELLE L. WOOD  
REGISTERED PROFESSIONAL ENGINEER NO. 104860

### DIMENSION CONTROL PLAN MIDWESTERN STATE UNIVERSITY PARKING LOT ADDITION PROJECT HAMPSTEAD LANE

DRAWN MWC  
CHECKED SLW  
APPROVED SLW  
CORLETT, PROBST & BOYD, P.L.L.C.  
ENGINEERS - SURVEYORS  
4605 OLD JACKSBORO HIGHWAY  
WICHITA FALLS, TEXAS 76302  
PHONE (940) 723-1455  
FAX (940) 397-0549  
SCALE: 1" = 20'  
MARCH, 2017  
SHEET 7 OF 7

## VENDOR REFERENCES

Please list three (3) references of current customers who can verify the quality of service your company provides. The University prefers customers of similar size and scope of work to this proposal. ***THIS FORM MUST BE RETURNED WITH YOUR PROPOSAL.***

<b>REFERENCE ONE</b>
----------------------

Government/CompanyName: \_\_\_\_\_

Address: \_\_\_\_\_

ContactPersonandTitle: \_\_\_\_\_

Phone: \_\_\_\_\_ Fax: \_\_\_\_\_

Contract Period: \_\_\_\_\_ ScopeofWork: \_\_\_\_\_

<b>REFERENCE TWO</b>
----------------------

Government/CompanyName: \_\_\_\_\_

Address: \_\_\_\_\_

ContactPersonandTitle: \_\_\_\_\_

Phone: \_\_\_\_\_ Fax: \_\_\_\_\_

Contract Period: \_\_\_\_\_ ScopeofWork: \_\_\_\_\_

<b>REFERENCE THREE</b>
------------------------

Government/CompanyName: \_\_\_\_\_

Address: \_\_\_\_\_

ContactPersonandTitle: \_\_\_\_\_

Phone: \_\_\_\_\_ Fax: \_\_\_\_\_

Contract Period: \_\_\_\_\_ ScopeofWork: \_\_\_\_\_

## AFFIDAVIT

The undersigned certifies that the bid prices contained in this proposal have been carefully checked and are submitted as correct and final and if bid is accepted (within 90 days unless otherwise noted by vendor), agrees to furnish any and/or all items upon which prices are offered, at the price(s) and upon the conditions contained in the Specifications.

STATE OF TEXAS  
COUNTY OF WICHITA

BEFORE ME, the undersigned authority, a Notary Public in and for the State of Texas, on this day personally appeared

\_\_\_\_\_  
who, after having first been duly sworn, upon oath did depose and say;

That the foregoing proposal submitted by \_\_\_\_\_

\_\_\_\_ hereinafter called "Bidder" is the duly authorized agent of said company and that the person signing said proposal has been duly authorized to execute the same. Bidder affirms that they are duly authorized to execute this contract, that this company, corporation, firm, partnership or individual has not prepared this bid in collusion with any other Bidder, and that the contents of this bid as to prices, terms or conditions of said bid have not been communicated by the undersigned nor by any employee or agent to any other person engaged in this type of business prior to the official opening of this bid.

Name and Address of Bidder:

\_\_\_\_\_  
\_\_\_\_\_  
\_\_\_\_\_

Telephone number \_\_\_\_\_

Email \_\_\_\_\_

\_\_\_\_\_  
Signature

Name: \_\_\_\_\_

Title: \_\_\_\_\_

SWORN TO AND SUBSCRIBED BEFORE ME THIS \_\_\_\_\_ day of \_\_\_\_\_,  
20 \_\_\_\_\_.

\_\_\_\_\_  
Notary Public in and for the  
State of Texas.

**AGREEMENT BETWEEN  
MIDWESTERN STATE UNIVERSITY  
AND**

CONTRACT NO.

This Agreement made the \_\_\_\_\_ day of \_\_\_\_\_ in the year 20\_\_\_\_, by and between \_\_\_\_\_, hereinafter called the Contractor, and the Board of Regents of Midwestern State University, hereinafter called the Owner,

WITNESSETH, that the Contractor and the Owner for the consideration hereinafter named agree as follows:

**ARTICLE 1. SCOPE OF WORK:** The Contractor shall furnish all of the materials and perform all of the work shown on the drawings and described in the specifications for the project entitled \_\_\_\_\_. These drawings and specifications prepared for Midwestern State University by \_\_\_\_\_, acting as and in these Contract Documents entitled the Project Architect. The Contractor shall do everything required by this Agreement, the General and Supplemental Conditions of the Contract, the Special Conditions, the Addenda, the Specifications, the Drawings, the Historically Underutilized Business (HUB) Subcontracting Plan, and the Proposal attached as **Exhibit 1** (including any unit prices stated therein).

The Specifications and Drawings are enumerated as follows:

SPECIFICATIONS: See attached as **Exhibit 2**.

DRAWINGS: See attached as **Exhibit 2**.

ADDENDA: See attached as **Exhibit 2**.

ALTERNATES: The following Alternate Proposals, fully described in the Specifications, are included as a part of this Contract: \_\_\_\_\_.

**ARTICLE 2. TIME OF COMPLETION:** The Owner shall provide a Notice to Proceed in which a date for commencement of the work shall be stated; such commencement date shall be 10 or more days after the date of the notice. The Contractor shall achieve substantial completion of the work within \_\_\_\_\_ ( ) calendar days after such commencement date, as such completion date may be extended by approved Change Orders. The time set forth for completion of the work is an essential element of the Contract.

**ARTICLE 3. THE CONTRACT SUM:** The Owner shall pay the Contractor for performance of the Contract, subject to additions and deductions provided therein, the sum of (\$ \_\_\_\_\_), and make payment on account as hereinafter provided.

ARTICLE 4. HUB SUBCONTRACTING PLAN: The Owner has adopted Exhibit H, Policy on Utilization of Historically Underutilized Business ("Policy"), which is incorporated herein by reference. Contractor, as a provision of the Agreement must comply with the requirements of the Policy and adhere to the HUB Subcontracting Plan submitted with Contractor's Proposal and attached as **Exhibit 3**. No changes to the HUB Subcontracting Plan can be made by the Contractor without the prior written approval of the Owner in accordance with the Policy.

ARTICLE 5. LIQUIDATED DAMAGES: For each consecutive calendar day after the substantial completion period set forth in Article 2 above that any work, including the correction of deficiencies found during the final testing and inspection, is not completed, the amount of (\$ ) will be deducted from the money due or becomes due the Contractor, not as a penalty but as liquidated damages representing the parties' estimate at the time of contract execution of the damages which the Owner will sustain for late completion.

ARTICLE 6. CERTIFICATION OF NO ASBESTOS CONTAINING MATERIALS OR WORK:

The Contractor shall provide a certification statement, included with each materials submittal, stating that no asbestos containing materials or work is included within the scope of the proposed submittal.

The Contractor shall insure that Texas Department of Health licensed individuals, consultants or companies are used for any required asbestos work including asbestos inspection, asbestos abatement plans/specifications, asbestos abatement, asbestos project management and third-party asbestos monitoring.

The Contractor shall provide at Substantial Completion, a notarized affidavit to the Owner and the Architect stating that no asbestos containing materials or work was provided, installed, furnished or added to the Project.

The Contractor shall take whatever measures he deems necessary to insure that all employees, suppliers, fabricators, materialmen, subcontractors, or their assigns, comply with this requirement.

All materials used on this Project shall be certified as non Asbestos Containing Building Materials (ACBM). The Contractor shall insure compliance with the following acts from all of his subcontractors and assigns:

Asbestos Hazard Emergency Response Act (AHERA—40 CFR 763-99 (7));

National Emission Standards for Hazardous Air Pollutants (NESHAP—EPA 40 CFR 61, National Emission Standard for Asbestos;



Texas Asbestos Health Protection Rules (TAHRP—Tex. Admin. Code Title 25, Part 1, Ch. 295C, Asbestos Health Protection

Every subcontractor shall provide a notarized statement that no ACBM has been used, provided, or left on this Project.

The Contractor shall provide, in hard copy and electronic form, all necessary material safety data sheets (MSDS) of all products used in the construction of the Project to the Texas Department of Health licensed inspector or Project Architect or Engineer who will compile the information from the MSDS and, finding no asbestos in any of the product, make a certification statement.

At Final Completion the Contractor shall provide a notarized certification statement per TAC Title 25 Part 1, Ch. 295.34, par. c.1 that no ACBM was used during construction of the Project.

ARTICLE 7. ACCEPTANCE OF BID OR AWARD OF CONTRACT: By signing this Agreement, the undersigned certifies as follows:

Assignment. This Agreement is a personal service contract for the services of Construction, and Contractor's interest in this Agreement, duties hereunder and/or fees due hereunder may not be assigned or delegated to a third party.

Records of expenses pertaining to Additional Services and services performed on the basis of a Worker Wage Rate or Monthly Salary Rate shall be kept on the basis of generally accepted accounting principles and in accordance with cost accounting standards promulgated by the Federal Office of Management and Budget Cost Accounting Standards Board and shall be available for audit by the Owner or the Owner's authorized representative on reasonable notice.

Family Code Child Support Certification. Pursuant to Section 231.006, Texas Family Code, Service Provider certifies that it is not ineligible to receive the award of or payments under this Agreement and acknowledges that this Agreement may be terminated and payment may be withheld if this certification is inaccurate.

Eligibility Certification. Pursuant to Section 2155.004, Texas Government Code, Service Provider certifies that the individual or business entity named in this Agreement is not ineligible to receive the award of or payments under this Agreement and acknowledges that this Agreement may be terminated and payment withheld if this certification is inaccurate.

Franchise Tax Certification. A corporate or limited liability company Contractor certifies that it is not currently delinquent in the payment of any Franchise Taxes due under Chapter 171 of the Texas Tax Code, or that the corporation or limited liability company is exempt from the payment of such taxes, or that the corporation or limited liability company is an out-of-state corporation or limited liability company that is not subject to the Texas Franchise Tax, whichever is applicable.



Payment of Debt or Delinquency to the State. Pursuant to Sections 2107.008 and 2252.903, Texas Government Code, Contractor agrees that any payments owing to Contractor under this Agreement may be applied directly toward any debt or delinquency that Contractor owes the State of Texas or any agency of the State of Texas regardless of when it arises, until such debt or delinquency is paid in full.

Entire Agreement; Modifications. This Agreement supersedes all prior agreements, written or oral, between Contractor and Owner and shall constitute the entire Agreement and understanding between the parties with respect to the Project. This Agreement and each of its provisions shall be binding upon the parties and may not be waived, modified, amended or altered except by a writing signed by Contractor and Owner.

Captions. The captions of paragraphs in this Agreement are for convenience only and shall not be considered or referred to in resolving questions of interpretation or construction.

Governing Law and Venue. This Agreement and all of the rights and obligations of the parties and all of the terms and conditions shall be construed, interpreted and applied in accordance with and governed by and enforced under the laws of the State of Texas without reference to its conflicts of law provisions. The county where the Project is located shall be the sole place of venue for any legal action arising from or related to this Agreement or the Project in which the Owner is a party.

Waivers. No delay or omission by either party in exercising any right or power arising from non compliance or failure of performance by the other party with any of the provisions of this Agreement shall impair or constitute a waiver of any such right or power. A waiver by either party of any covenant or condition of this Agreement shall not be construed as a waiver of any subsequent breach of that or of any other covenant or condition of the Agreement.

Binding Effect. This Agreement shall be binding upon and inure to the benefit of the parties and their respective permitted assigns and successors.

Appointment. Owner hereby expressly reserves the right from time to time to designate by notice to Contractor a representative(s) to act partially or wholly for Owner in connection with the performance of Owner's obligations. Contractor shall act only upon instructions from the designated representative(s) unless otherwise specifically notified to the contrary.

Records. Records of Contractor's costs, reimbursable expenses pertaining to the Project and payments shall be available to Owner or its authorized representative during business hours and shall be retained for four (4) years after final Payment or abandonment of the Project, unless Owner otherwise instructs Contractor in writing.

Notices. All notices, consents, approvals, demands, requests or other communications relied on by the parties shall be in writing. Written notice shall be deemed to have been given when delivered in person to the designated representative of the Contractor or Owner for whom it is intended; or sent by U. S. Mail to the last known business address of the designated representative; or transmitted by fax machine to the last known business fax number of the designated representative.

Mail notices are deemed effective upon receipt or on the third business day after the date of mailing, whichever is sooner. Fax notices are deemed effective the next business day after faxing.

**Severability.** Should any term or provision of this Agreement be held invalid or unenforceable in any respect, the remaining terms and provisions shall not be affected and this Agreement shall be construed as if the invalid or unenforceable term or provision had never been included.

**Illegal Dumping.** The Contractor shall ensure that it and all of its Subcontractors and assigns prevent illegal dumping of litter in accordance with Title 5, Texas Health and Safety Code, Chapter 365.

**Ethics Matters/No Financial Interest.** Contractor and its employees, agents, representatives and subcontractors have read and understand University's Conflicts of Interest Policy, University's Standards of Conduct Guide and applicable state ethics laws and rules. Neither Contractor nor its employees, agents, representatives or subcontractors will assist or cause University employees to violate University's Conflicts of Interest Policy, provisions described by University's Standards of Conduct Guide, or applicable state ethics laws or rules. Contractor represents and warrants that no member of the Board has a direct or indirect financial interest in the transaction that is the subject of this Agreement.

By signature hereon, Contractor certifies that no member of the Board of Regents of Midwestern State University, or Executive Officers, including component institutions, has a financial interest, directly or indirectly, in the transaction that is the subject of this contract.

BY SIGNING BELOW, the Parties have executed and bound themselves to this Agreement as of the day and year first above written.

MIDWESTERN STATE UNIVERSITY

By: \_\_\_\_\_  
Signature

\_\_\_\_\_  
Print name

Date: \_\_\_\_\_

By: \_\_\_\_\_  
Signature

\_\_\_\_\_  
Print name

Date: \_\_\_\_\_

SAMPLE