

Welcome Account Managers Group

April 26, 2018

Construction Update

by

Dr. Marilyn Fowlé

Health Sciences & Human Services Building:



HS+HS/JS Bridwell/Dillard/McCoy Quad, NE Corner:



HS+HS/JS Bridwell/Dillard/McCoy Quad, West View:

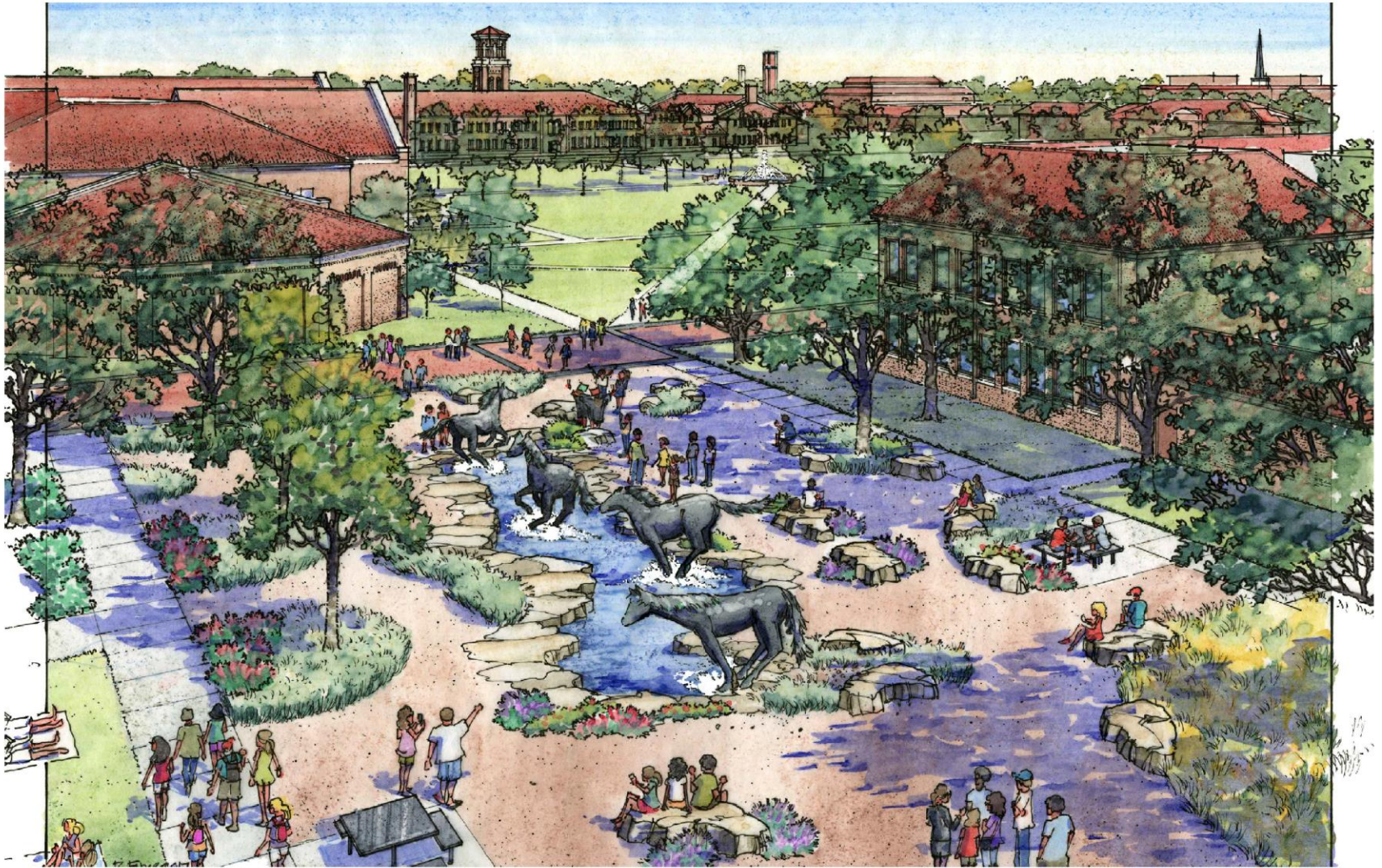

Moffett Renovations: Lobby Entrance Area





Bolin Stairwell

Fain Fine Arts Stairwell and Elevator



Sunwatcher Clubhouse For Housing Administration:

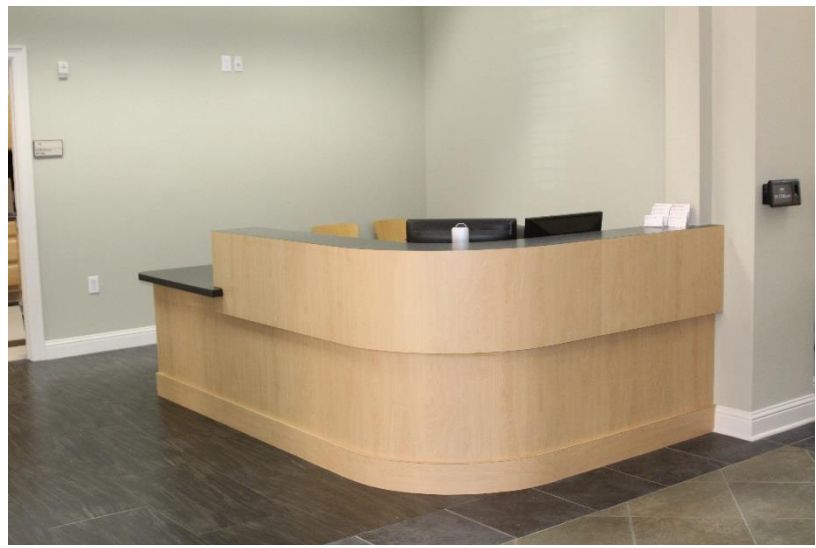

Language Lab in Beawood:



Lifelong Learning Center:



University Police Department in Eureka Circle:



Reconstruction of Lots 3 & 6N (south of PYBO):



Facilities Shops Relocation: UPD/Bridwell Courts Site

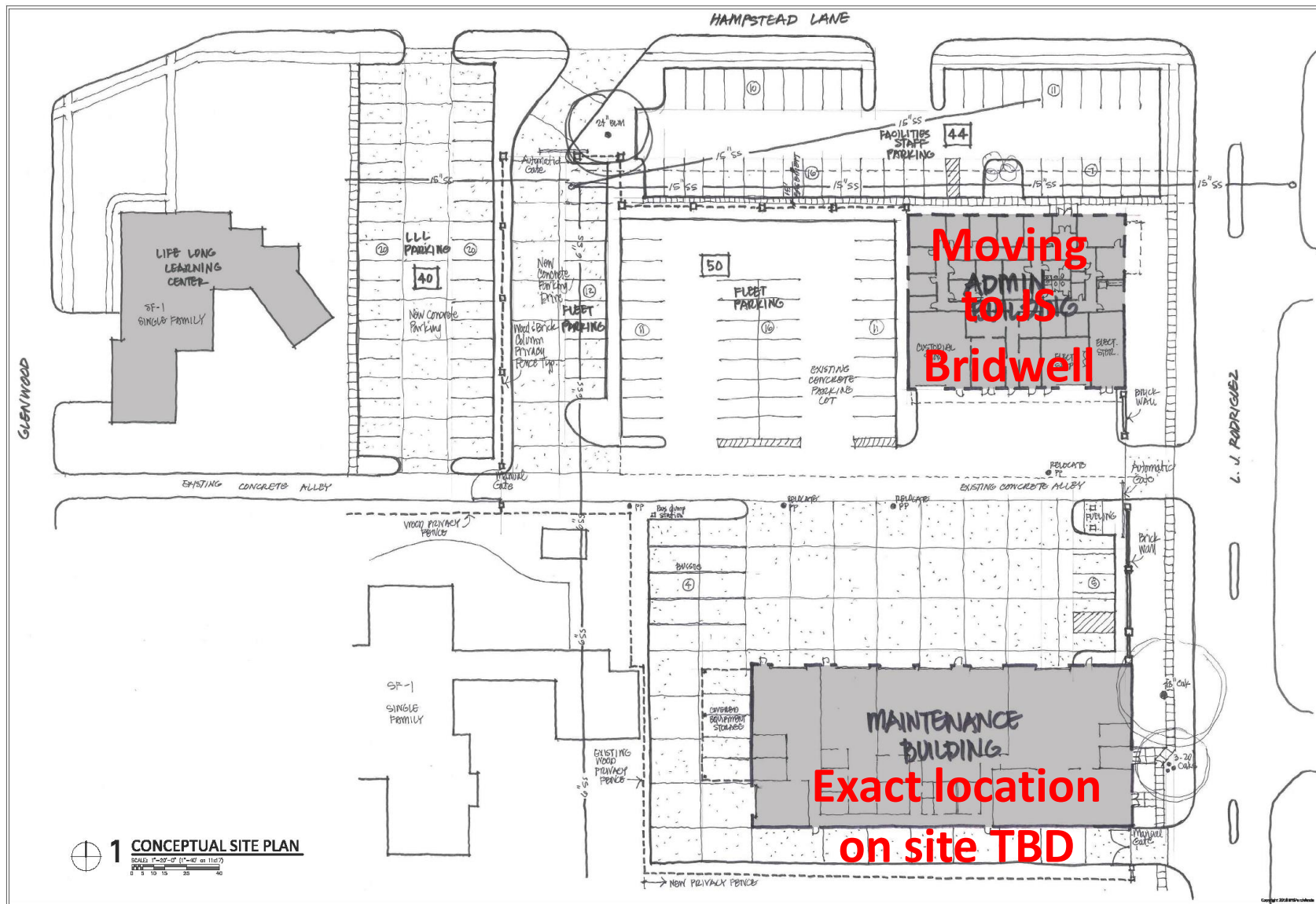

Moving to JS Bridwell

Exact location on site TBD

1 CONCEPTUAL SITE PLAN
 SCALE: 1/8" = 1'-0" (1" = 8'-0" on 11x17)
 0 5 10 15 20 40

REV	DATE	DESCRIPTION

CHUCK BUNDY PMA
 PRESIDENT/CEO
 BRIDWELL COURTS
 PROJECT # 2017-0000000
 APPROVED FOR CONSTRUCTION
 ON MARCH 27, 2018

MIDWESTERN STATE UNIVERSITY
 FACILITY SERVICES RELOCATION

BYSP architects
 1500 North Street, Suite 200, Wichita Falls, Texas 76798 (940) 763-5454
 Member American Institute of Architects

DRAWN BY: RAB
 CHECKED BY: RAB
 DATE: 03/27/18
 PROJECT NO.: 18002

CONCEPTUAL SITE PLAN
SP101
 Revised

Facilities Shops Relocation: Bridwell Courts Demo



Facilities Shops Relocation: UPD Demo



Questions?

Instructional Enhancement Fee Policy Update

by

Marilyn Fowlé

Original Travel Policy

Student travel expense when presenting at conferences or on field trips; travel expense for the supervision of students enrolled in practica or internships at field-based training facilities; travel expense for the supervision of student field trips when part of a course in which students earn semester credit hours; travel expense of faculty to teach at a location other than their assigned location.

Additional Travel Update

Professional development for faculty related to the improvement of teaching or maintenance of licensure/certification required by programmatic accrediting agencies to qualify the faculty member to teach in his/her discipline. This includes registration, travel expenses, and accommodations for discipline specific meetings, workshops, clinics, etc.

Questions?

Degree Works

by

Darla Inghish

Questions?

TimeClock Plus Update

by
Kathy Rice

Questions?

Tip of the Month

by

Anna Daugherty



- ✓ Upcoming Dates
 - July 26th

- ✓ Shred Day – May 16th



Questions or Suggestions??